

# CORNER RECORD

COUNTY OF San Joaquin T. 3N R. 8E MDM MERIDIAN CALIFORNIA

CORNER TYPE: GOV'T. CORNER ☐ MEANDER ☐ RANCHO ☐ CONTROL ☐ OTHER ☒

CORNER IDENTIFICATION — DATE OF VISIT April 30 19 76

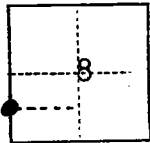

CORNER — LEFT AS FOUND ☐ FOUND AND TAGGED ☒ REESTABLISHED OBLITERATED CORNER ☐ REBUILT ☐

PHYSICAL DESCRIPTION OF CORNER FOUND; EVIDENCE AND METHOD USED TO IDENTIFY OR REESTABLISH

Found 1 1/8 inch iron pin 05 feet down at intersection of Tully and Smith Roads.  
Set tag L.S. 3576 and 1 inch X 2 inch with tack, flush with pavement. Set 4 shiners on pavement N.S. and E.S. 2 feet apart. Set R.P.'S. as shown in sketch. To find used plat of Lockeford-Lodi Small Farms - block No. 1 filed Volume 64 Page 34.

PHYSICAL DESCRIPTION OF MONUMENTS REBUILT OR PERPETUATED

CORNER LOCATED BY P.G.&E. SURVEY  
BUT NOT VERIFIED

PACIFIC GAS AND ELECTRIC CO.  
LAND DEPT. JOB 183341

CALIFORNIA COORDINATE SYSTEM ORDER: FIRST ☐ SECOND ☐ THIRD ☐  
STATIONS USED: NGS (USC & GS) ☐ STATE ☐ COUNTY ☐ OTHER ☐ STATION \_\_\_\_\_ STATION \_\_\_\_\_  
ZONE \_\_\_\_\_ ELEVATION \_\_\_\_\_ NORTHINGS (Y) \_\_\_\_\_ EASTINGS (X) \_\_\_\_\_

SKETCH: (Include reference tie or witness points, remarks and topo of area)

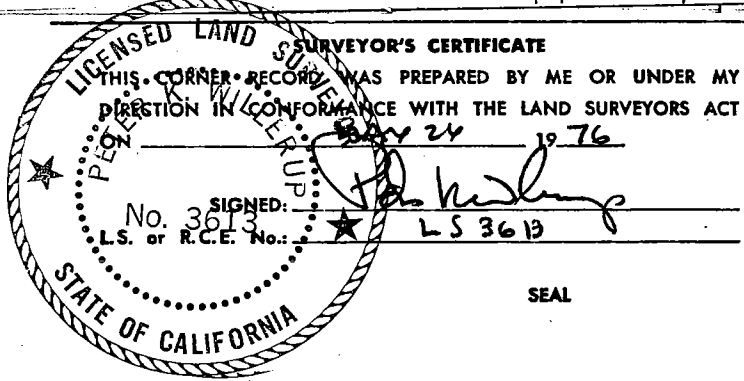
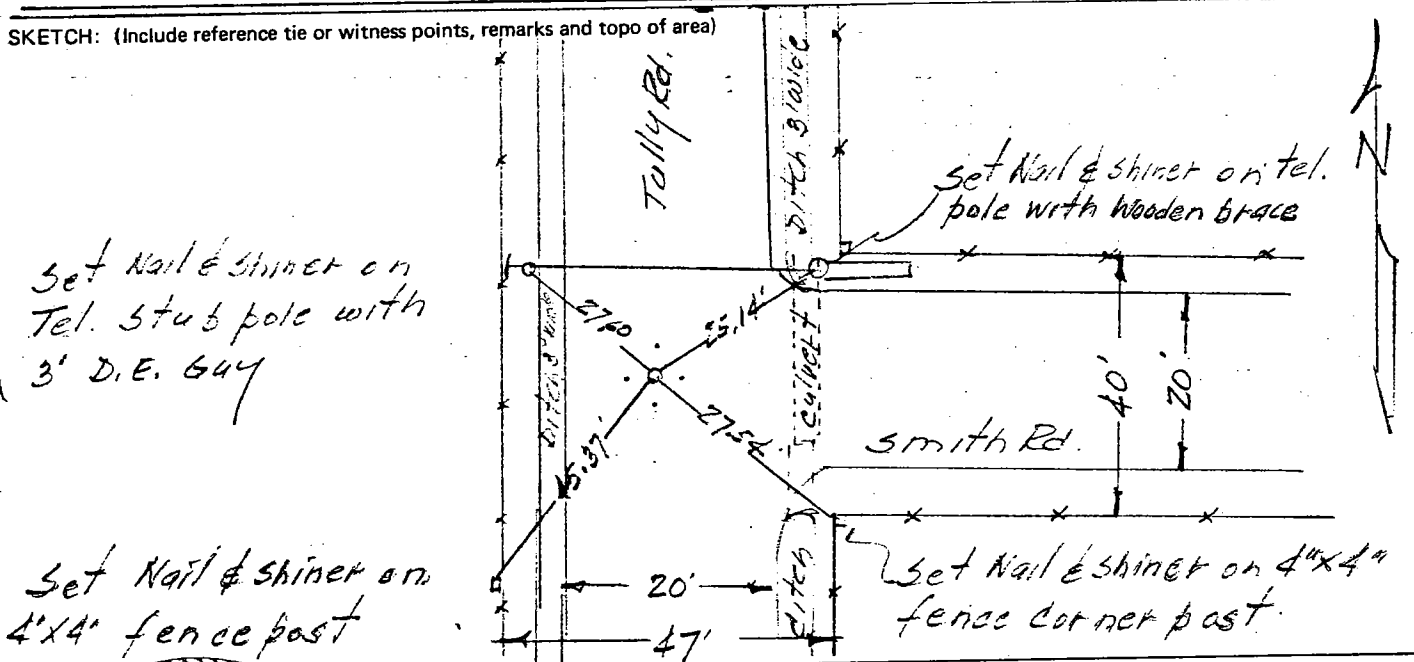

COUNTY SURVEYOR'S CERTIFICATE  
THE CORNER RECORD WAS RECEIVED May 28, 1976  
AND EXAMINED AND FILED June 3, 1976  
BY: Robert W. DeLamack  
TITLE: Chief Deputy County Surveyor  
DOCUMENT No. C.R.-76-006

STATEMENT ON BACK OF SHEET

YES ☐ NO ☒