

CORNER RECORD

COUNTY OF San Joaquin T. 1S. R. 6E. MDB& MERIDIAN CALIFORNIA
 CORNER TYPE: GOV'T. CORNER ☒ MEANDER ☐ RANCHO ☐ CONTROL ☐ OTHER ☐
 CORNER IDENTIFICATION — DATE OF VISIT August 18 19 75

35	36
2	1

North 1/4 Corner Section 2 T2S R6E

CORNER — LEFT AS FOUND ☒ FOUND AND TAGGED ☐ REESTABLISHED OBLITERATED CORNER ☐ REBUILT ☐

PHYSICAL DESCRIPTION OF CORNER FOUND; EVIDENCE AND METHOD USED TO IDENTIFY OR REESTABLISH

Railroad spike at center of Yosemite Avenue, 110' east of S.P. Railroad xing
San Joaquin County Record of Survey Book 13 Page 6.

PHYSICAL DESCRIPTION OF MONUMENTS REBUILT OR PERPETUATED

CORNER LOCATED BY P.G.&E. SURVEY
 BUT NOT VERIFIED

CALIFORNIA COORDINATE SYSTEM ORDER: FIRST ☐ SECOND ☐ THIRD ☐
 STATIONS USED: NGS (USC & GS) ☐ STATE ☐ COUNTY ☐ OTHER ☐ STATION _____ STATION _____
 ZONE _____ ELEVATION _____ NORTHINGS (Y) _____ EASTINGS (X) _____

SKETCH: (Include reference tie or witness points, remarks and topo of area)

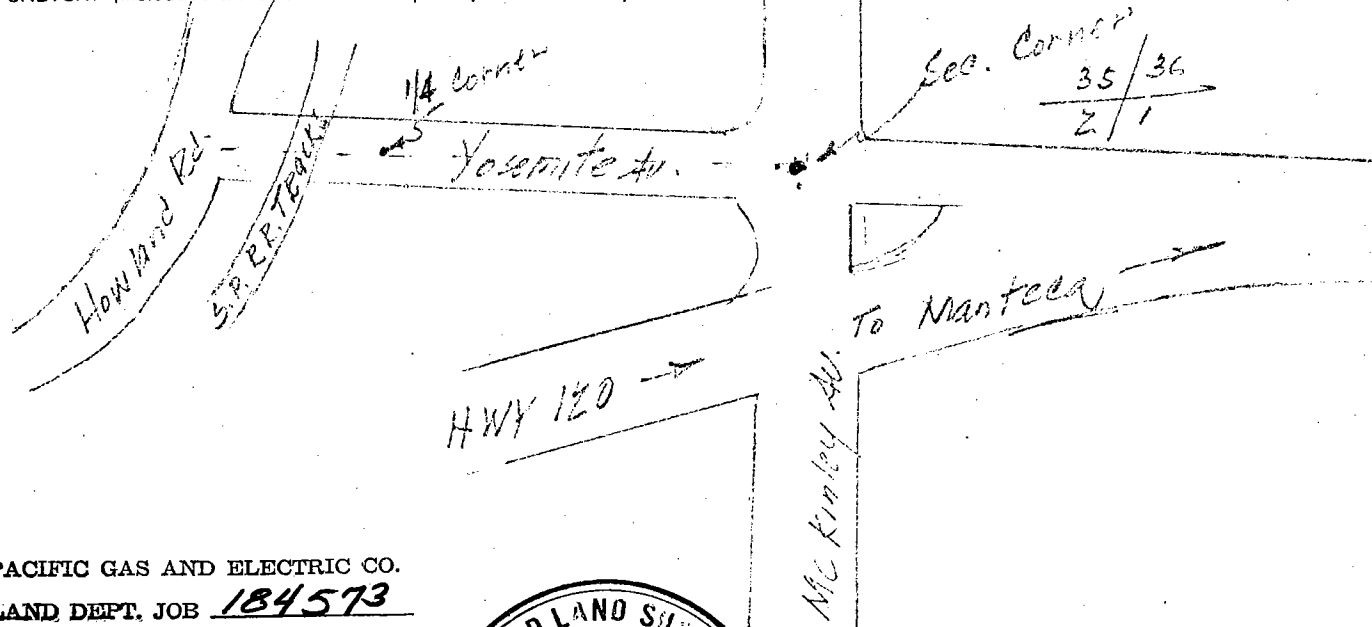

PACIFIC GAS AND ELECTRIC CO.
 LAND DEPT. JOB 184573

SURVEYOR'S CERTIFICATE
 THIS CORNER RECORD WAS PREPARED BY ME OR UNDER MY
 DIRECTION IN CONFORMANCE WITH THE LAND SURVEYORS ACT
 ON September 19 75
 SIGNED: [Signature]
 L.S. or R.C.E. No.: 453771

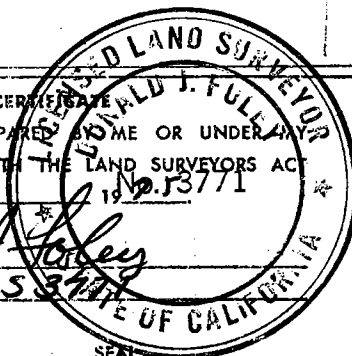

COUNTY SURVEYOR'S CERTIFICATE
 THE CORNER RECORD WAS RECEIVED _____ 19____
 AND EXAMINED AND FILED July 14, 1986
 BY Robert Dehnamak
 TITLE: Chief Dep. Co. Surveyor
 DOCUMENT No. CR-75-002
 STATEMENT ON BACK OF SHEET
 YES ☒ NO ☐

As this was not indexed until 7-16-86,
it is not being submitted for County
Surveyor review and signature.