

# CORNER RECORD

Agency Index CR-26-085  
 Document Number \_\_\_\_\_

City of \_\_\_\_\_ County of SAN JOAQUIN, California

Brief Legal Description FOUND MONUMENT ALONG THE WESTERLY RIGHT-OF-WAY LINE OF SOUTH AIRPORT WAY.

**CORNER TYPE**

**COORDINATES (Optional)**

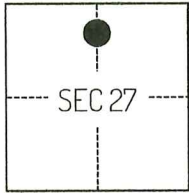

C.M. WEBER GRANT

- Government Corner     Control  
 Meander                     Property  
 Rancho                         Other

Date of Survey March 27, 2025

N. \_\_\_\_\_ E. \_\_\_\_\_

Elevation \_\_\_\_\_

Units     Metric             U.S. Survey Foot

Horizontal Datum \_\_\_\_\_

Zone \_\_\_\_\_ Epoch Date \_\_\_\_\_

Vertical Datum \_\_\_\_\_

Complies with Public Resources Code §§8801-8819

Complies with Public Resources Code §§8890-8902

PLS Act Ref.:     8765(d)                     8771                     8773                     Other:

Corner/Monument:     Left as found                     Established                     Rebuilt                     Pre-Construction

Found and tagged                     Reestablished                     Referenced                     Post-Construction

Narrative of corner identified and monument as found, set, reset, replaced, or removed:

See sheet #2 for description(s):

THE FOUND MONUMENT(S) SHOWN ON THIS CORNER RECORD WERE FOUND AT THE RECORD LOCATION OF THE CORNER(S) ON CORNER RECORD 24-278, SAN JOAQUIN COUNTY SURVEYOR'S RECORDS. I DID NOT VERIFY THE IDENTITY OR VALIDITY OF THE MONUMENT(S) FOUND AS ACTUALLY MARKING THE PROPERTY CORNER.

**SURVEYOR'S STATEMENT**

This Corner Record was prepared by me or under my direction in conformance with the Professional Land Surveyors' Act on July 29, 2025.  
 Signed [Signature] P.L.S. or R.C.E. No. 8489



**COUNTY SURVEYOR'S STATEMENT**

This Corner Record was received February 12, 2026  
 and examined and filed February 23, 2026.  
 Signed James E. Hart P.L.S. or R.C.E. No. 8657  
 Title County Surveyor



County Surveyor's Comment

Document Number

Agency Index

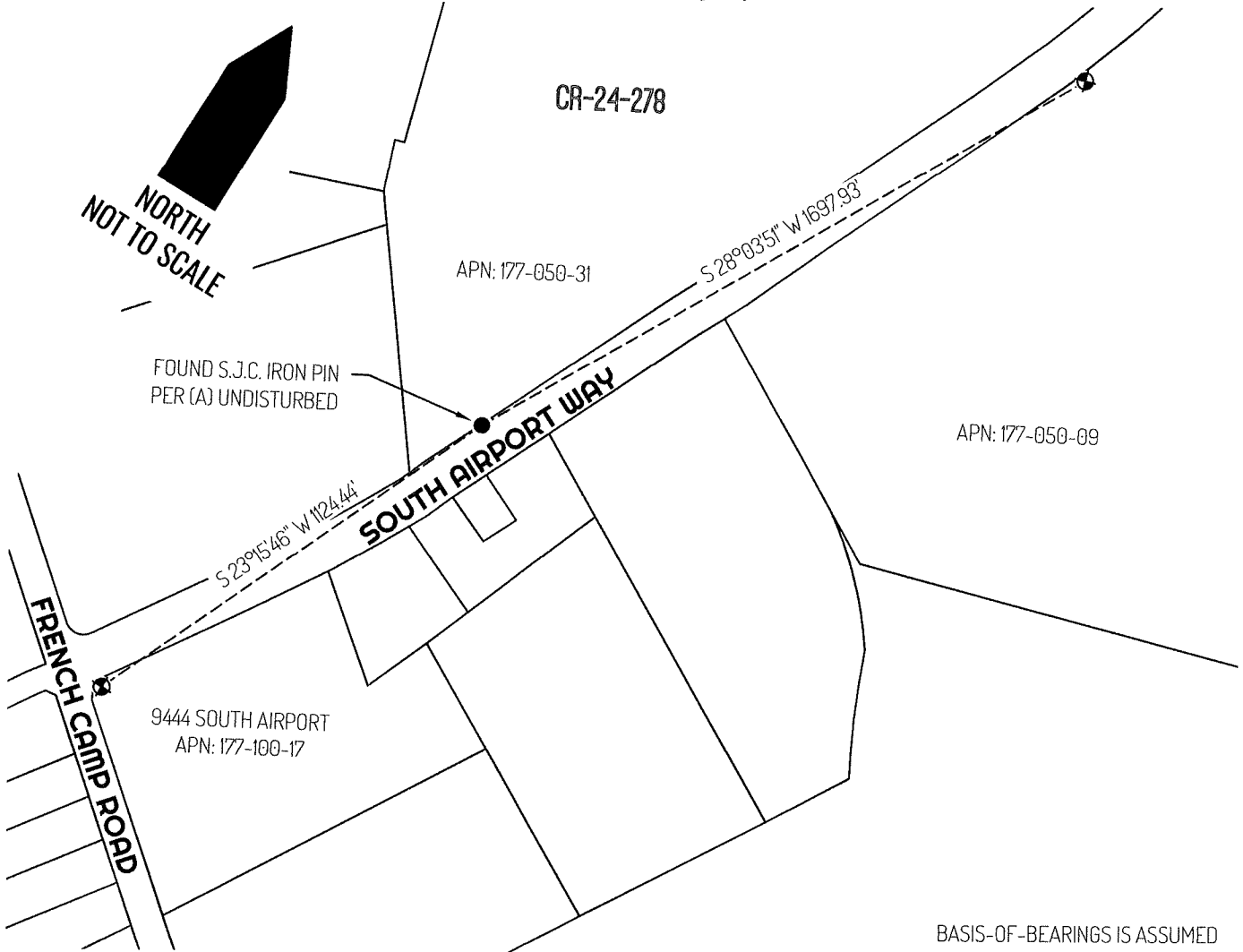

BASIS-OF-BEARINGS IS ASSUMED

**LEGEND**

●	FOUND MONUMENT AS NOTED
⊕	FOUND CONTROL POINT PER (A) 5/8" REBAR WITH CAP
9444	REFERENCE STREET ADDRESS
APN	TAX ASSESSOR PARCEL NUMBER
CR	CORNER RECORD, SAN JOAQUIN COUNTY SURVEYOR'S RECORDS
M	MEASURED
S.J.C.	SAN JOAQUIN COUNTY
---	TIE LINE
—	LOT LINE

**REFERENCE**

(A) CORNER RECORD 24-278, SAN JOAQUIN COUNTY SURVEYOR'S RECORDS