

CORNER RECORD

Agency Index

CR-25-251

Document Number

City of STOCKTONCounty of SAN JOAQUIN, California

Brief Legal Description A PORTION OF THE SOUTH 1/2 OF SECTION 18, T. 2 N., R. 6 E., M. D. B.&M., AND AS SHOWN ON THAT CERTAIN MAP ENTITLED "TRACT 1158 COLONIAL ESTATES SOUTH UNIT NO. 2, FILED DECEMBER 17, 1975 IN BOOK 21 OF MAPS AND PLATS, AT PAGE 55, SAN JOAQUIN COUNTY RECORDS.

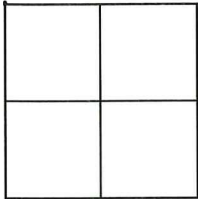
**CORNER TYPE**

Government Corner ☐ Control
Meander ☐ Property
Rancho ☐ Other

Date of Survey 10/17/2024**COORDINATES (Optional)**

N. _____ E. _____

☐ Elevation☒ Units Metric ☐ U.S. Survey Foot ☒☐ Horizontal Datum _____

Zone _____ Epoch Date _____

Vertical Datum _____

☐ Complies with Public Resources Code §§8801-8819☐ Complies with Public Resources Code §§8890-8902PLS Act Ref: ☐ 8765(d) ☒ 8771 ☐ 8773 ☐ Other:

Corner/
Monument: ☒ Left as found ☐ Established ☐ Rebuilt ☒ Pre-Construction
☐ Found and tagged ☐ Reestablished ☒ Referenced ☐ Post-Construction

Narrative of corner identified and monument as found, set, reset, replaced, or removed:

☒ See sheet #2 for description(s): FD. (2) 3/4" REBAR, NO TAG, IN MONUMENT WELL AT THE FOLLOWING LOCATIONS: 1. INTERSECTION OF RICHLAND WAY AND THE NORTH LINE OF SAID MAP. 2. POINT OF REVERSE CURVATURE ON SHOREHAM PLACE. SHOWN ON SAID MAP HAVING A RADIAL BEARING OF N 82°43'41" W. FD. (4) 3/4" REBAR WITH TAG STAMPED RCE 15831 IN MONUMENT WELL AT THE FOLLOWING LOCATIONS: 1. INTERSECTION OF RICHLAND WAY AND BALTIMORE PLACE. 2. INTERSECTION OF RICHLAND WAY AND SOUTHFIELD WAY. 3. INTERSECTION OF SHOREHAM PLACE AND JASMINE AVENUE. 4. INTERSECTION OF SHOREHAM PLACE AND BALTIMORE PLACE. LOCATIONS AS SHOWN ON EXHIBIT "B" AND SAID MAP 21 MP 55, SAN JOAQUIN COUNTY RECORDS.

SURVEYOR'S STATEMENT

This Corner Record was prepared by me or under my direction in conformance with

the Professional Land Surveyors' Act on 7/7/2025Signed Lester E. Carter Jr. P.L.S. No. 6148

LESTER E. CARTER JR.

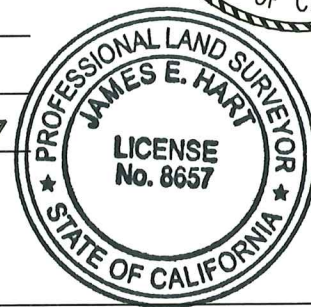
**COUNTY SURVEYOR'S STATEMENT**This Corner Record was received July 21, 2025and examined and filed July 25, 2025Signed James E. Hart P.L.S. or R.C.E. No. 8657Title County Surveyor

County Surveyor's Comment _____

DATUM STATEMENT:

COORDINATES SHOWN HEREON ARE GRID
AND ARE BASED ON CITY OF STOCKTON
MONUMENT 162, CALIFORNIA COORDINATE
SYSTEM(CCS83). ZONE III, 1983 NAD, AND
SHOWN ON RECORD OF SURVEY BOOK 35
OF SURVEYS, PAGE 5. THE PROJECT
SPECIFIC COMBINED SCALE FACTOR IS
0.99994486.

FOUND 3/4" REBAR WITH TAG
STAMPED RCE 15831 IN MONUMENT
WELL OR AS NOTED

MP MAPS AND PLATS

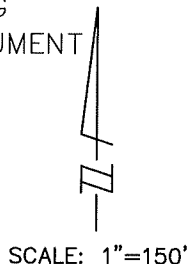

GRID COORDINATES (U.S. FEET)		
POINT#	NORTHING	EASTING
12307	2193976.972	6316355.693
12308	2193551.995	6316356.554
12311	2193797.734	6316616.084
12312	2193552.566	6316616.582
12313	2193264.108	6316598.576
12315	2193302.224	6316341.328

