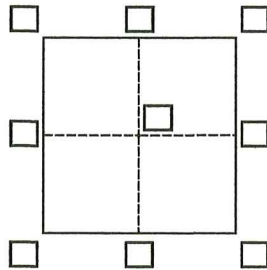

CORNER RECORD

Agency Index

CR-25-102

Document Number

City of Lodi County of San Joaquin, CaliforniaBrief Legal Description Parcel Six - Parcel Maps 12 - 24**CORNER TYPE**

Government Corner ☐ Control ☐
Meander ☐ Property ☒
Rancho ☐ Other ☐

Date of Survey December 23, 2024**COORDINATES (Optional)**N. E. Elevation Units ☒ Metric ☐ U.S. Survey Foot ☐Horizontal Datum Zone Epoch Date Vertical Datum ☐ Complies with Public Resources Code §§8801-8819☐ Complies with Public Resources Code §§8890-8902

PLS Act Ref.:

☒ 8765(d)☐ 8771☐ 8773☐ Other:Corner/
Monument:☒ Left as found☐ Established☐ Rebuilt☐ Pre-Construction☐ Found and tagged☒ Reestablished☒ Referenced☒ Post-Construction

Narrative of corner identified and monument as found, set, reset, replaced, or removed:

☒ See sheet #2 for description(s):**SURVEYOR'S STATEMENT**

This Corner Record was prepared by me or under my direction in conformance with

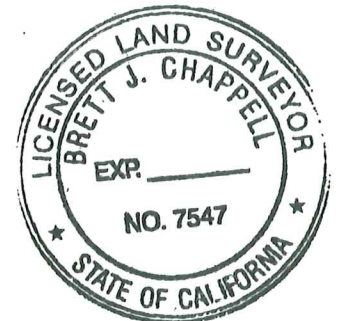
the Professional Land Surveyors' Act on March 27, 2025Signed Brett Chappell P.L.S. or R.C.E. No. 7547**COUNTY SURVEYOR'S STATEMENT**This Corner Record was received April 1, 2025and examined and filed April 11, 2025Signed James E. Hart P.L.S. or R.C.E. No. 8657Title County Surveyor

County Surveyor's Comment



