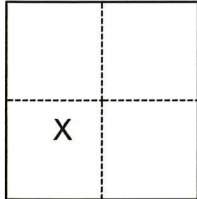

CORNER RECORD

Agency Index

CR-25-093

Document Number

City of Lodi County of San Joaquin, CaliforniaBrief Legal Description Property monument at 124 Harvest Lane**CORNER TYPE****COORDINATES (Optional)**

- | | |
|--|--|
| <input type="checkbox"/> Government Corner | <input type="checkbox"/> Control |
| <input type="checkbox"/> Meander | <input checked="" type="checkbox"/> Property |
| <input type="checkbox"/> Rancho | <input type="checkbox"/> Other |

N. _____ E. _____

Elevation _____

Units ☐ Metric ☒ U.S. Survey Foot

Horizontal Datum _____

Zone _____ Epoch Date _____

Vertical Datum _____

☐ Complies with Public Resources Code §§8801-8819☐ Complies with Public Resources Code §§8890-8902Date of Survey December 12, 2024Section 3, T.3N., R.6E.
M.D.B.&M.PLS Act Ref.: ☐ 8765(d) ☒ 8771 ☐ 8773 ☐ Other:

Corner/ Monument:	<input checked="" type="checkbox"/> Left as found	<input type="checkbox"/> Established	<input type="checkbox"/> Rebuilt	<input checked="" type="checkbox"/> Pre-Construction
	<input type="checkbox"/> Found and tagged	<input type="checkbox"/> Reestablished	<input checked="" type="checkbox"/> Referenced	<input type="checkbox"/> Post-Construction

Narrative of corner identified and monument as found, set, reset, replaced, or removed:

☒ See sheet #2 for description(s):

FOUND ONE (1) 3/4" IRON ROD CAPPED "RCE 19638" PER M&P 34-069 AT THE SOUTHEAST CORNER OF ELM STREET AND HARVEST LANE. SET THREE (3) NAILS WITH WASHERS, STAMPED "C.O.L. LS 9478" AS REFERENCE POINTS. NO BOUNDARY ANALYSIS WAS PERFORMED.

SURVEYOR'S STATEMENT

This Corner Record was prepared by me or under my direction in conformance with

the Professional Land Surveyors' Act on

3/10/25

Signed

P.L.S. or R.C.E. No.

9478**COUNTY SURVEYOR'S STATEMENT**

This Corner Record was received

March 12, 2025

and examined and filed

March 20, 2025

Signed

County Surveyor

P.L.S. or R.C.E. No.

8657

Title

County Surveyor's Comment

LODI WEST
UNIT NO. 1
M&P 31-080

6

7

8

9

10

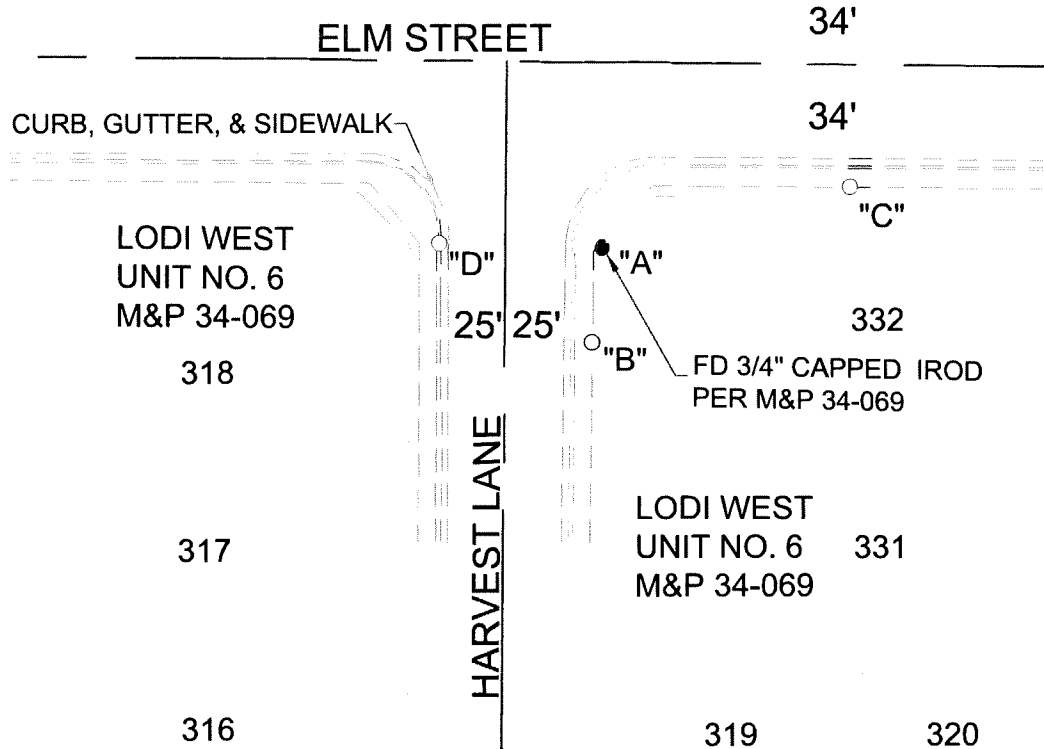

DISTANCE (M) TABLE

FD MONUMENT		FROM	DIST	FROM	DIST	FROM	DIST
"A"	FOUND 3/4" CAPPED IROD STAMPED "RCE 19638"	"B"	24.69'	"C"	66.21'	"D"	42.55'

LEGEND

- FOUND MONUMENT AS NOTED IN TABLE, PER M&P 34-069
- SET NAIL AND WASHER STAMPED
"C. O. L. LS 9478"
- DIST DISTANCE
- IROD IRON ROD
- M&P MAPS & PLATS, VOLUME & PAGE,
SAN JOAQUIN COUNTY RECORDS
- S.C.J.R. SAN JOAQUIN COUNTY RECORDS
- (M) MEASURED ON THIS SURVEY
- FD FOUND

↑
NORTH
SCALE: 1"=50'
2422-CR.DWG