

CORNER RECORD

Agency Index CR-24-154
Document Number _____

City of _____ County of SAN JOAQUIN, California

Brief Legal Description FOUND OPEN 2" IRON PIPE ON THE EASTERLY TERMINUS OF THE SOUTH LINE OF PORTOLA AVENUE, PER TRACT MAP NO. 316 (13 M 130)

CORNER TYPE

COORDINATES (Optional)

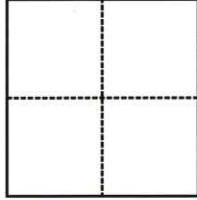

- Government Corner
- Meander
- Rancho
- Control
- Property
- Other

N. _____ E. _____

Elevation _____

Units Metric U.S. Survey Foot

Horizontal Datum _____

Zone _____ Epoch Date _____

Vertical Datum _____

- Complies with Public Resources Code §§8801-8819
- Complies with Public Resources Code §§8890-8902

Date of Survey OCTOBER 19, 2023

PLS Act Ref.: 8765(d) 8771 8773 Other:

Corner/Monument: Left as found Established Rebuilt Pre-Construction

Found and tagged Reestablished Referenced Post-Construction

Narrative of corner identified and monument as found, set, reset, replaced, or removed:

See sheet #2 for description(s):

FOUND OPEN 2" IRON PIPE ON THE EASTERLY TERMINUS OF THE SOUTH LINE OF PORTOLA AVENUE, PER TRACT MAP NO. 316, (13 M 130), SAN JOAQUIN COUNTY RECORDS.

THIS MONUMENT HAS BEEN REFERENCED PRIOR TO CONSTRUCTION. THE TIES SHOWN HEREON ARE FOR THE PURPOSE OF PERPETUATING FOUND MONUMENTS AND NO CLAIM IS MADE TO THEIR RELATIONSHIP TO THE BOUNDARY LOCATION SHOWN HEREON.

SURVEYOR'S STATEMENT

This Corner Record was prepared by me or under my direction in conformance with
the Professional Land Surveyors' Act on DECEMBER 14, 2023
Signed Nathaniel S. Anderson P.L.S. or R.C.E. No. 9667



COUNTY SURVEYOR'S STATEMENT

This Corner Record was received February 28, 2024
and examined and filed March 12, 2024
Signed James E. Hart P.L.S. or R.C.E. No. 8657
Title SAN JOAQUIN COUNTY SURVEYOR



County Surveyor's Comment

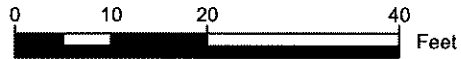

SCALE 1" = 20'

LEGEND

- · — · — MONUMENT TIE LINE
- — — — — APPROXIMATE LOT LINE
- FOUND OPEN 2" IRON PIPE ON THE EASTERLY TERMINUS OF THE SOUTH LINE OF PORTOLA AVENUE, PER TRACT MAP NO. 316 (13 M 130)
- SET NAIL & BRASS TAG STAMPED "REF PT - LS 9667" IN CONCRETE WALK
- M MAPS & PLATS, SAN JOAQUIN COUNTY RECORDS



1611 PORTOLA AVE
BLOCK 9
LOT 10
(13 M 130)

1605 PORTOLA AVE
BLOCK 9
LOT 11
(13 M 130)

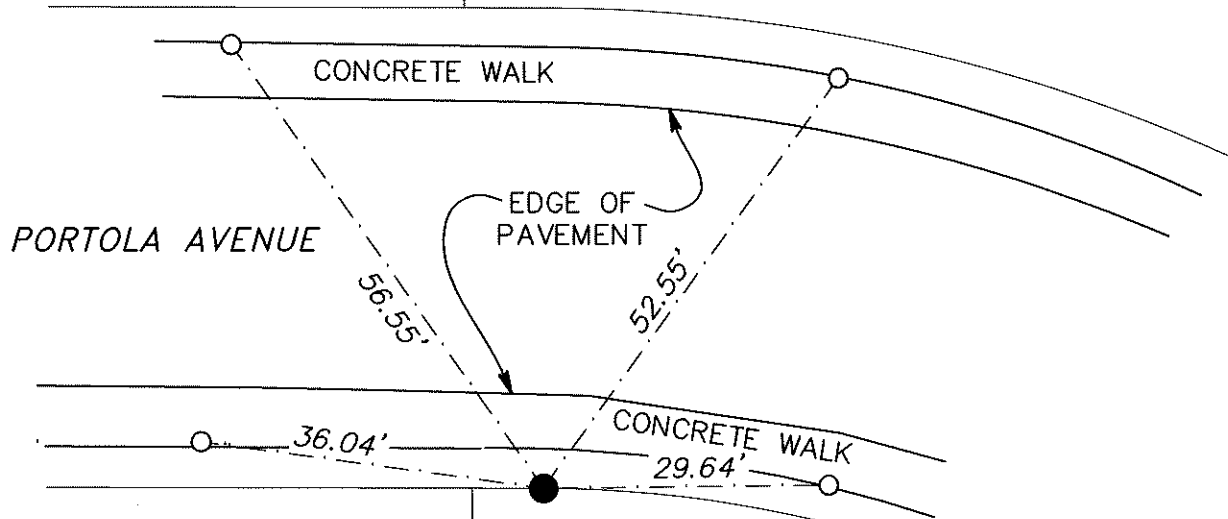

1616 PORTOLA AVE
BLOCK 8
LOT 10
(13 M 130)

1544 PORTOLA AVE
BLOCK 8
LOT 11
(13 M 130)