

# CORNER RECORD

Agency Index CR-24-124  
Document Number \_\_\_\_\_

City of STOCKTON County of SAN JOAQUIN, California

Brief Legal Description FOUND MONUMENT ON SOUTH TUXEDO AVENUE NEAR APN 113-070-56, S.J.C.R.  
NO MAPS AVAILABLE.



T1N/R6E

### CORNER TYPE

- Government Corner
- Meander
- Rancho
- Control
- Property
- Other

Date of Survey January 12, 2023

### COORDINATES (Optional)

N. \_\_\_\_\_ E. \_\_\_\_\_

Elevation \_\_\_\_\_

Units  Metric  U.S. Survey Foot

Horizontal Datum \_\_\_\_\_

Zone \_\_\_\_\_ Epoch Date \_\_\_\_\_

Vertical Datum \_\_\_\_\_

Complies with Public Resources Code §§8801-8819

Complies with Public Resources Code §§8890-8902

PLS Act Ref.:  8765(d)  8771  8773  Other:

Corner/Monument:  Left as found  Established  Rebuilt  Pre-Construction

Found and tagged  Reestablished  Referenced  Post-Construction

Narrative of corner identified and monument as found, set, reset, replaced, or removed:

See sheet #2 for description(s):

### SURVEYOR'S STATEMENT

This Corner Record was prepared by me or under my direction in conformance with  
the Professional Land Surveyors' Act on March 6, 2023  
Signed [Signature] P.L.S. or R.C.E. No. 8489



### COUNTY SURVEYOR'S STATEMENT

This Corner Record was received February 16, 2024  
and examined and filed February 29, 2024  
Signed James E. Hart P.L.S. or R.C.E. No. 8657  
Title County Surveyor



County Surveyor's Comment

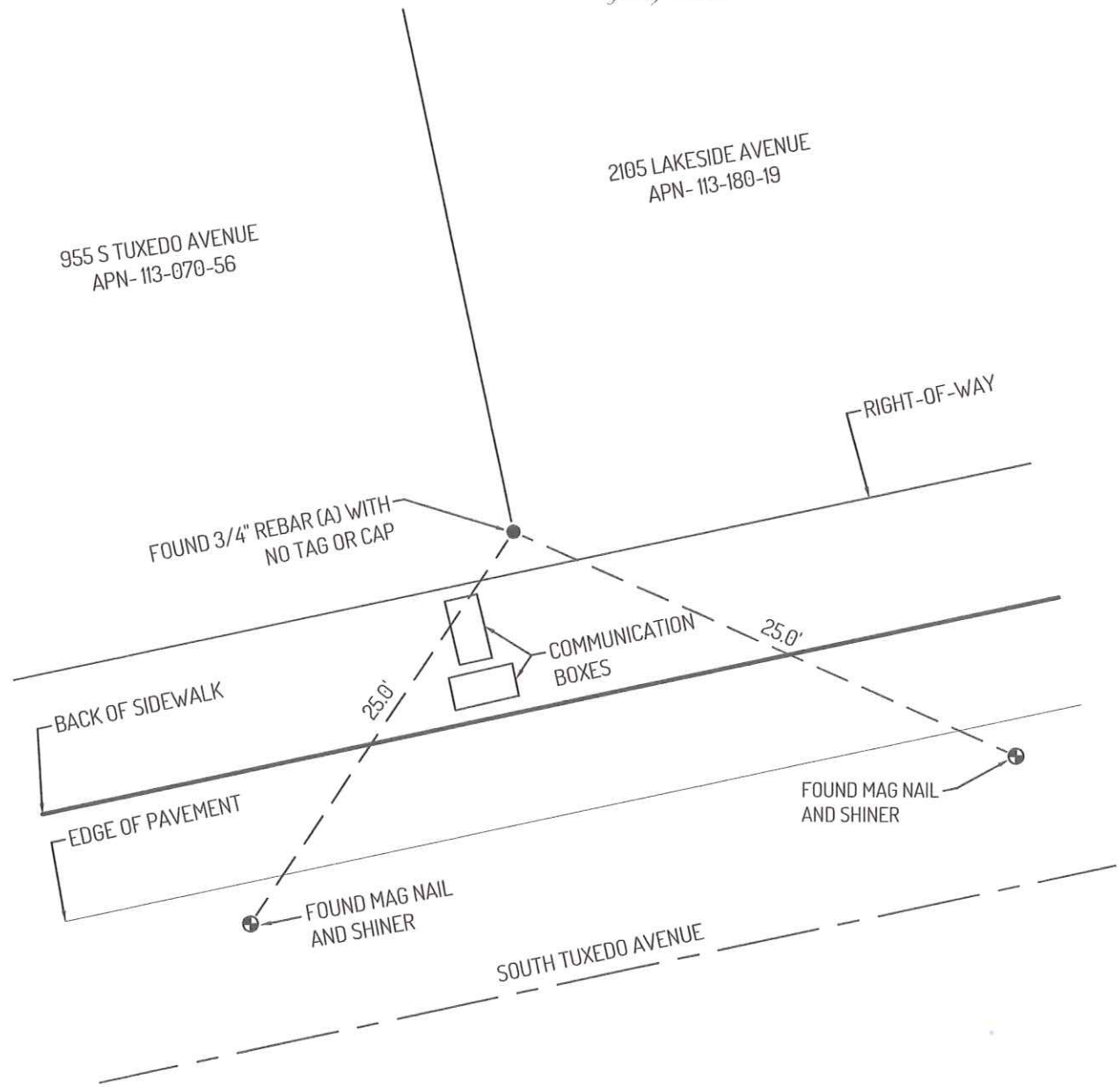

**LEGEND**

- FOUND 3/4" REBAR (A) NO CAP OR TAG
- ⊕ FOUND CONTROL POINT
- 955 REFERENCE STREET ADDRESS
- APN ASSESSOR'S PARCEL NUMBER
- MP MAPS AND PLATS, SAN JOAQUIN COUNTY RECORDS

**LINETYPES**

- - - - - CENTERLINE
- — — — — SIDEWALK
- EDGE OF PAVEMENT
- RIGHT OF WAY
- - - - - TIE LINE

**REFERENCE**

(A) CORNER RECORD 22-299, SAN JOAQUIN COUNTY SURVEYOR'S RECORDS



**NORTH**



**SCALE**

NOT TO SCALE