

CORNER RECORD

Agency Index CR-24-113

Document Number _____

City of _____ County of SAN JOAQUIN, California

Brief Legal Description FOUND MONUMENT ON PARCEL B PER BOOK 13, PAGE 28 OF PARCEL MAPS.

CORNER TYPE

COORDINATES (Optional)

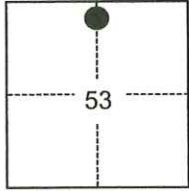

C.M. WEBER
GRANT

- Government Corner Control
 Meander Property
 Rancho Other

Date of Survey November 23, 2022

N. _____ E. _____

Elevation _____

Units Metric U.S. Survey Foot

Horizontal Datum _____

Zone _____ Epoch Date _____

Vertical Datum _____

Complies with Public Resources Code §§8801-8819

Complies with Public Resources Code §§8890-8902

PLS Act Ref.: 8765(d) 8771 8773 Other:

Corner/Monument: Left as found Established Rebuilt Pre-Construction

Found and tagged Reestablished Referenced Post-Construction

Narrative of corner identified and monument as found, set, reset, replaced, or removed:

See sheet #2 for description(s):

SURVEYOR'S STATEMENT

This Corner Record was prepared by me or under my direction in conformance with the Professional Land Surveyors' Act on December 15, 2022.

Signed Scott L. Blake P.L.S. or R.C.E. No. 8489



COUNTY SURVEYOR'S STATEMENT

This Corner Record was received February 13, 2024 and examined and filed February 27, 2024.

Signed James E. Hart P.L.S. or R.C.E. No. 8657

Title County Surveyor

County Surveyor's Comment



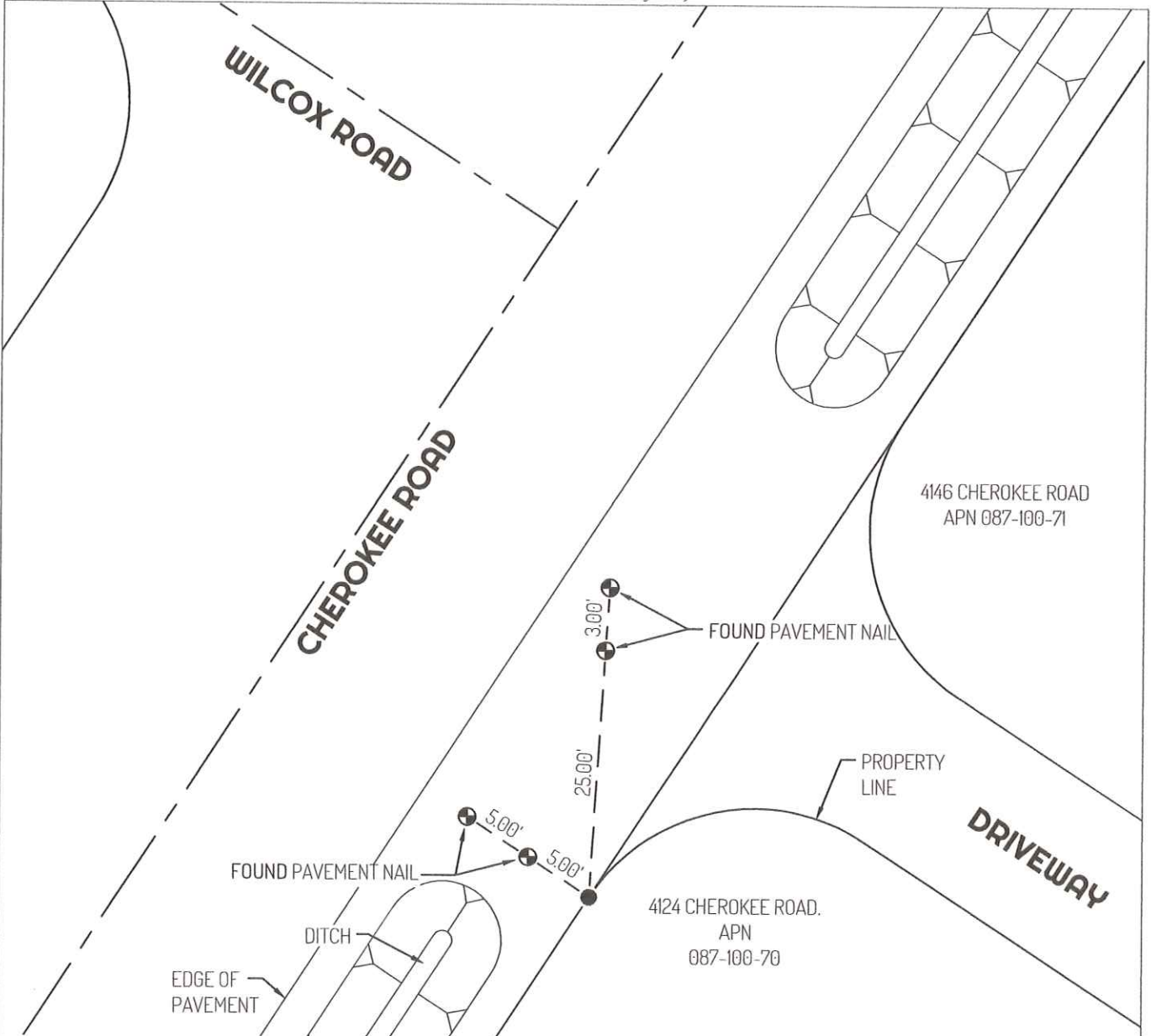

LEGEND

- FOUND 3/4" REBAR, PER (A) NO CAP OR TAG
- ⊕ FOUND CONTROL POINT
- 435 REFERENCE STREET ADDRESS
- APN ASSESSOR'S PARCEL NUMBER

LINETYPES

- - - - - CENTERLINE
- EDGE OF PAVEMENT
- PROPERTY LINE
- - - - - TIE LINES

REFERENCES

(A) 13-PM-28 AND CORNER RECORD 22-263, SAN JOAQUIN COUNTY SURVEYOR'S RECORDS

