

CORNER RECORD

Agency Index CR-23-255

Document Number _____

City of _____

County of SAN JOAQUIN, California

Brief Legal Description MONUMENTS AS SHOWN ON C.R. 17-213

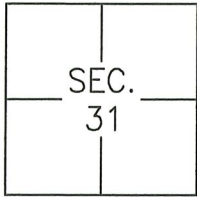

T.2S., R.5E

CORNER TYPE

- Government Corner Control
 Meander Property
 Rancho Other

Date of Survey AUGUST 22, 2023

COORDINATES (Optional)

- N. _____ E. _____
 Elevation _____
 Units Metric U.S. Survey Foot
 Horizontal Datum _____
 Zone _____ Epoch Date _____
 Vertical Datum: _____
 Complies with Public Resources Code §§8801-8819
 Complies with Public Resources Code §§8890-8902

PLS Act Ref.: 8765(d) 8771 8773 Other: _____

Corner/Monument: Left as found Established Rebuilt Pre-Construction
 Found and tagged Reestablished Referenced Post-Construction

Narrative of corner identified and monument as found, set, reset, replaced, or removed:

See sheet #2 for description(s):

SURVEYOR'S STATEMENT

This Corner Record was prepared by me or under my direction in conformance with the Professional Land Surveyor's Act on OCT. 20TH 2023, _____.

Signed [Signature] P.L.S. or R.C.E. No.: 8366



COUNTY SURVEYOR'S STATEMENT

This Corner Record was received November 1, 2023 and examined and filed November 14, 2023.

Signed James E. Hart P.L.S. or R.C.E. No.: 8657

Title County Surveyor

County Surveyor's Comment _____



CECCHI
D.N. 2006-004293
PER 37-RS-056

FOUND 5/8" REBAR
TAGGED LS 7309
PER 17-CR-213

63.52'

42.08'

SET MAG NAIL

R.S. 17-24

67.38'

CORRAL HOLLOW ROAD

FOUND 1" IRON PIPE
TAGGED LS 4450
PER 17-CR-213

59.07'

41.62'

SET MAG NAIL

51.34'

LEGEND:

- CR CORNER RECORD, S.J.C.S.R.
- RS RECORD OF SURVEY, S.J.C.R.
- S.J.C.R. SAN JOAQUIN COUNTY RECORDS
- D.N. DOCUMENT NUMBER, S.J.C.R
- S.J.C.S.R. SAN JOAQUIN COUNTY SURVEYOR'S RECORDS
- ⊕ CENTERLINE

