

CORNER RECORD

Agency Index CR-23-147

Document Number _____

City of STOCKTON County of SAN JOAQUIN, California

Brief Legal Description MONUMENT AT THE INTERSECTION OF MILTON STREET AND BIEGHLE ALLEY

CORNER TYPE

COORDINATES (Optional)

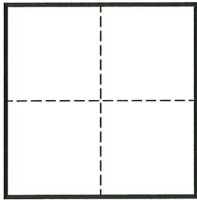

- Government Corner
- Meander
- Rancho
- Control
- Property
- Other

Date of Survey JANUARY 21, 2022

N. _____ E. _____
 Elevation _____
 Units Metric U.S. Survey Foot
 Horizontal Datum _____
 Zone _____ Epoch Date _____
 Vertical Datum _____
 Complies with Public Resources Code §§8801-8819
 Complies with Public Resources Code §§8890-8902

PLS Act Ref.: 8765(d) 8771 8773 Other:
 Corner/Monument: Left as found Established Rebuilt Pre-Construction
 Found and tagged Reestablished Referenced Post-Construction

Narrative of corner identified and monument as found, set, reset, replaced, or removed:

See sheet #2 for description(s):

FOUND 3/4" REBAR WITH NO PUNCH IN MONUMENT BOX LOCATED AT THE INTERSECTION OF MILTON STREET AND BIEGHLE ALLEY, AS SHOWN ON RECORD OF SURVEY MAP, IN BOOK 32 OF SURVEYS AT PAGE 27, SAN JOAQUIN COUNTY RECORDS.

MONUMENT WAS REFERENCED PRIOR TO THE START OF CONSTRUCTION OF A WATER MAIN REPLACEMENT, PROJECT NO. STK-18AB2 BY CALIFORNIA WATER SERVICE.

SURVEYOR'S STATEMENT

This Corner Record was prepared by me or under my direction in conformance with

the Professional Land Surveyors' Act on MAY 5, 2022

Signed [Signature] P.L.S. or R.C.E. No. 9251



COUNTY SURVEYOR'S STATEMENT

This Corner Record was received April 26, 2023

and examined and filed May 12, 2023

Signed James E. Hart P.L.S. or R.C.E. No. 8657

Title County Surveyor



County Surveyor's Comment

[Empty dashed box for County Surveyor's Comment]

MILTON ST.

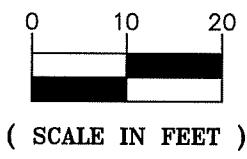

APN 155-160-19

MILTON ST.

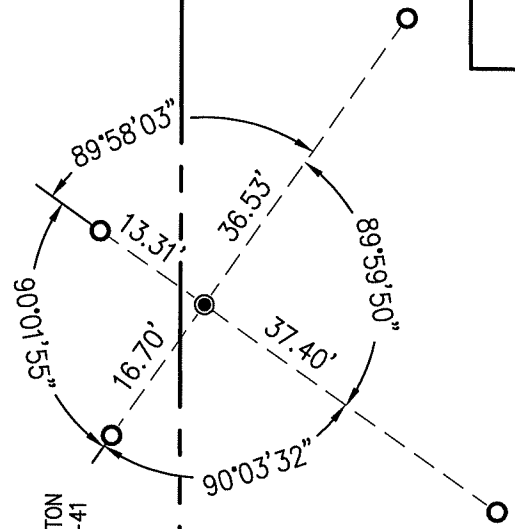

CITY OF STOCKTON
APN 155-100-41

BIEGHLE
ALLEY

APN 155-130-01

LEGEND

- FOUND 3/4" REBAR WITH NO PUNCH IN MONUMENT BOX, AS SHOWN ON RECORD OF SURVEY MAP, IN BOOK 32 OF SURVEYS AT PAGE 27, SAN JOAQUIN COUNTY RECORDS.
- SET MAG NAIL ON TOP OF CURB.

BKF
 1730 N. FIRST STREET
 SUITE 600
 SAN JOSE, CA 95112
 (408) 467-9100
 www.bkf.com

SUBJECT PRE-CONSTRUCTION CORNER RECORD
AT MILTON STREET AND BIEGHLE ALLEY

JOB NO. 20191483-STOCKTON MON PRESERVATION
 BY JML/EC APPR. BHS DATE 05-05-2022

K:\2019\191483-STOCKTON MON PRESERVATION\CORNER_REC_2022\191483-STOCKTON_MON_ST-BIEGHLE_ALLEY.BLDWG