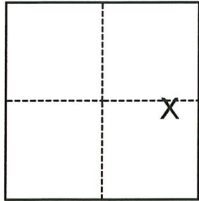

CORNER RECORD

Agency Index CR-23-128

Document Number _____

City of Lodi County of San Joaquin, CaliforniaBrief Legal Description Property monuments at Vine Street & Wellwood Avenue**CORNER TYPE****COORDINATES (Optional)**

- Government Corner Control
 Meander Property
 Rancho Other

N. _____ E. _____

Elevation _____

Units Metric U.S. Survey Foot

Horizontal Datum _____

Zone _____ Epoch Date _____

Vertical Datum _____

 Complies with Public Resources Code §§8801-8819 Complies with Public Resources Code §§8890-8902Date of Survey November 18, 2022Section 12, T.3N.,R.6E.
M.D.B.&M.PLS Act Ref.: 8765(d) 8771 8773 Other:Corner/
Monument: Left as found Established Rebuilt Pre-Construction Found and tagged Reestablished Referenced Post-Construction

Narrative of corner identified and monument as found, set, reset, replaced, or removed:

 See sheet #2 for description(s):

FOUND UNTAGGED MONUMENTS AT THE SOUTHWEST AND SOUTHEAST CORNERS OF VINE STREET AND WELLSWOOD AVENUE PER RS 4-273. SET THREE (3) NAILS WITH WASHERS, STAMPED "C.O.L. LS 9478" AS REFERENCE POINTS. NO BOUNDARY ANALYSIS WAS PERFORMED.

SURVEYOR'S STATEMENT

This Corner Record was prepared by me or under my direction in conformance with

the Professional Land Surveyors' Act on 3/8/23Signed [Signature] P.L.S. or R.C.E. No. 9478**COUNTY SURVEYOR'S STATEMENT**This Corner Record was received March 31, 2023and examined and filed April 14, 2023Signed James E. Hart P.L.S. or R.C.E. No. 8657Title County Surveyor**County Surveyor's Comment**

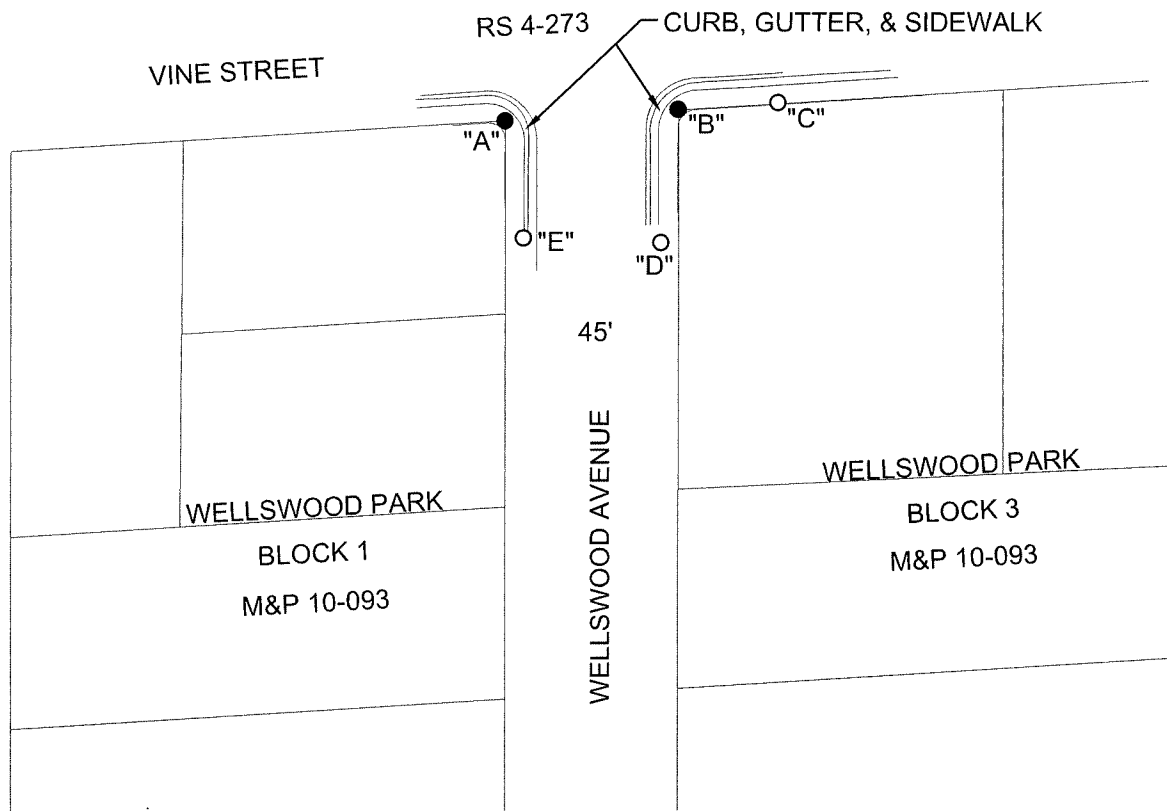

DISTANCE (M) TABLE					
	FOUND MONUMENT	FROM	DIST	FROM2	DIST2
"A"	AXLE (NT)	"C"	71.08'	"E"	30.74'
"B"	AXLE (NT)	"C"	26.05'	"D"	34.77'

LEGEND

- FOUND MONUMENT PER RS 4-273, AS NOTED
- SET NAIL AND WASHER STAMPED "C. O. L. LS 9478"
- RS RECORD OF SURVEY, BOOK & PAGE, SAN JOAQUIN COUNTY RECORDS
- M&P MAPS & PLATS, VOLUME & PAGE, SAN JOAQUIN COUNTY RECORDS
- DIST DISTANCE
- (M) MEASURED ON THIS SURVEY
- (NT) NO TAG

