

# CORNER RECORD

Agency Index CR-23-050  
 Document Number \_\_\_\_\_

City of \_\_\_\_\_ County of San Joaquin, California  
 Brief Legal Description Brennan Avenue 675'± south of Mariposa Road

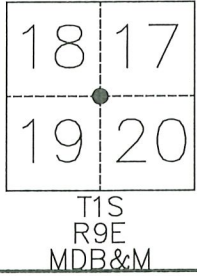

CORNER TYPE		COORDINATES (Optional)	
Government Corner	<input checked="" type="checkbox"/> Control <input type="checkbox"/>	N. _____	E. _____
Meander	<input type="checkbox"/> Property <input type="checkbox"/>	Elevation. _____	
Rancho	<input type="checkbox"/> Other <input type="checkbox"/>	Units Metric <input type="checkbox"/> U.S. Survey Foot <input checked="" type="checkbox"/>	
Date of Survey	<u>November 12, 2021</u>	Horizontal Datum _____	
		Zone _____ Epoch Date _____	
		Vertical Datum _____	
		<input type="checkbox"/> Complies with Public Resources Code §§8801-8819	
		<input type="checkbox"/> Complies with Public Resources Code §§8890-8902	

PLS Act Ref.:  8765(d)  8771  8773  Other:

Corner/Monument:  Left as found  Established  Rebuilt  Pre-Construction  
 Found and tagged  Reestablished  Referenced  Post-Construction

Narrative of corner identified and monument as found, set, reset, replaced, or removed:  
 See sheet #2 for description(s):

### SURVEYOR'S STATEMENT

This Corner Record was prepared by me or under my direction in conformance with  
 the Professional Land Surveyor's Act on November 15, 2021  
 Signed James E Hart P.L.S. or R.C.E. No. 8657



### COUNTY SURVEYOR'S STATEMENT

This Corner Record was received January 27, 2023  
 and examined and filed February 10, 2023  
 Signed James E Hart P.L.S. or R.C.E. No. 8657  
 Title \_\_\_\_\_ County Surveyor



County Surveyor's Comment

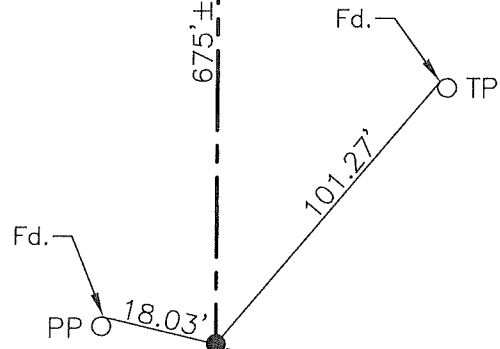
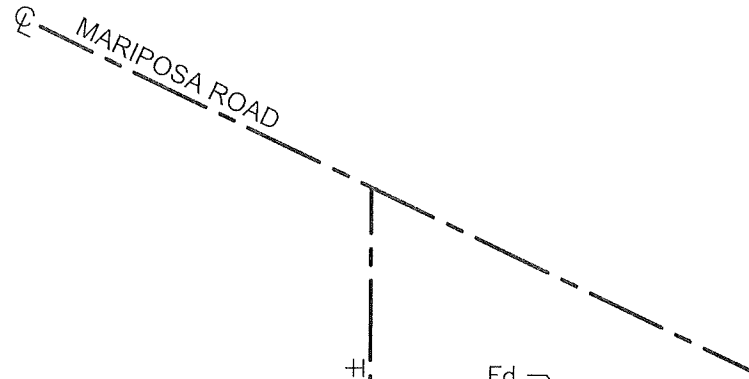
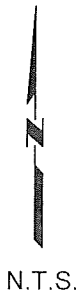

Cotton Gin Spindle per CR 20-143 at Section Corner gone. Set 3/4"x30" rebar with yellow cap stamped "SJCO Pub Works" in monument box.

- TR=Tree
- MB=Mailbox
- BM=Bench Mark
- EP=Edge of Pavement
- YL=Yellow Line
- FH=Fire Hydrant
- CR=Corner Record
- FP=Fence Post
- JP=Joint Pole
- LP=Light Pole
- PP=Power Pole
- GP=Guy Pole
- SP=Service Pole
- TP=Telephone Pole
- S.F.N.=Searched Found Nothing
- N.T.S.=Not To Scale
- M&P=Maps & Plats
- PM=Parcel Map
- RS=Record of Survey
- FB=Field Book
- N=North
- SDI=Storm Drain Inlet
- TOC=Top of Curb
- PCC=Portland Cement Concrete

Set=Conc. Nail with Brass Washer stamped "S.J. Co.", unless otherwise noted  
 Fd.=Found Conc. Nail with Brass Washer stamped "S.J. Co.", unless otherwise noted  
 Note: Found Monuments are not tagged unless otherwise noted.

"No attempt was made to verify the Monument(s)"