

CORNER RECORD

Agency Index CR-22-263

Document Number _____

City of _____

County of SAN JOAQUIN, California

Brief Legal Description FOUND MONUMENT ON PARCEL B PER BOOK 13, PAGE 28 OF PARCEL MAPS

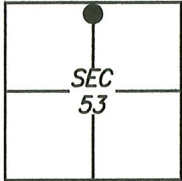

C.M. WEBER
GRANT

CORNER TYPE

- | | | | |
|-------------------|--------------------------|----------|-------------------------------------|
| Government Corner | <input type="checkbox"/> | Control | <input type="checkbox"/> |
| Meander | <input type="checkbox"/> | Property | <input checked="" type="checkbox"/> |
| Rancho | <input type="checkbox"/> | Other | <input type="checkbox"/> |

Date of Survey 2021/06/09

COORDINATES (Optional)

- N. _____ E. _____
 Elevation _____
 Units Metric U.S. Survey Foot
 Horizontal Datum _____
 Zone _____ Epoch Date _____
 Vertical Datum: _____
 Complies with Public Resources Code §§8801-8819
 Complies with Public Resources Code §§8890-8902

PLS Act Ref.: 8765(d) 8771 8773 Other: _____

Corner/ Monument:	<input checked="" type="checkbox"/> Left as found	<input type="checkbox"/> Established	<input type="checkbox"/> Rebuilt	<input checked="" type="checkbox"/> Pre-Construction
	<input type="checkbox"/> Found and tagged	<input type="checkbox"/> Reestablished	<input checked="" type="checkbox"/> Referenced	<input type="checkbox"/> Post-Construction

Narrative of corner identified and monument as found and set or reset:

See sheet #2 for description(s):

SURVEYOR'S STATEMENT

This Corner Record was prepared by me or under my direction in conformance with the Professional Land Surveyor's Act on 11 JUNE, 2021.

Signed [Signature] P.L.S. or R.C.E. No.: 8489



COUNTY SURVEYOR'S STATEMENT

This Corner Record was received October 13, 2022

and examined and filed November 7, 2022.

Signed [Signature] P.L.S. or R.C.E. No.: 8657

Title County Surveyor



County Surveyor's Comment

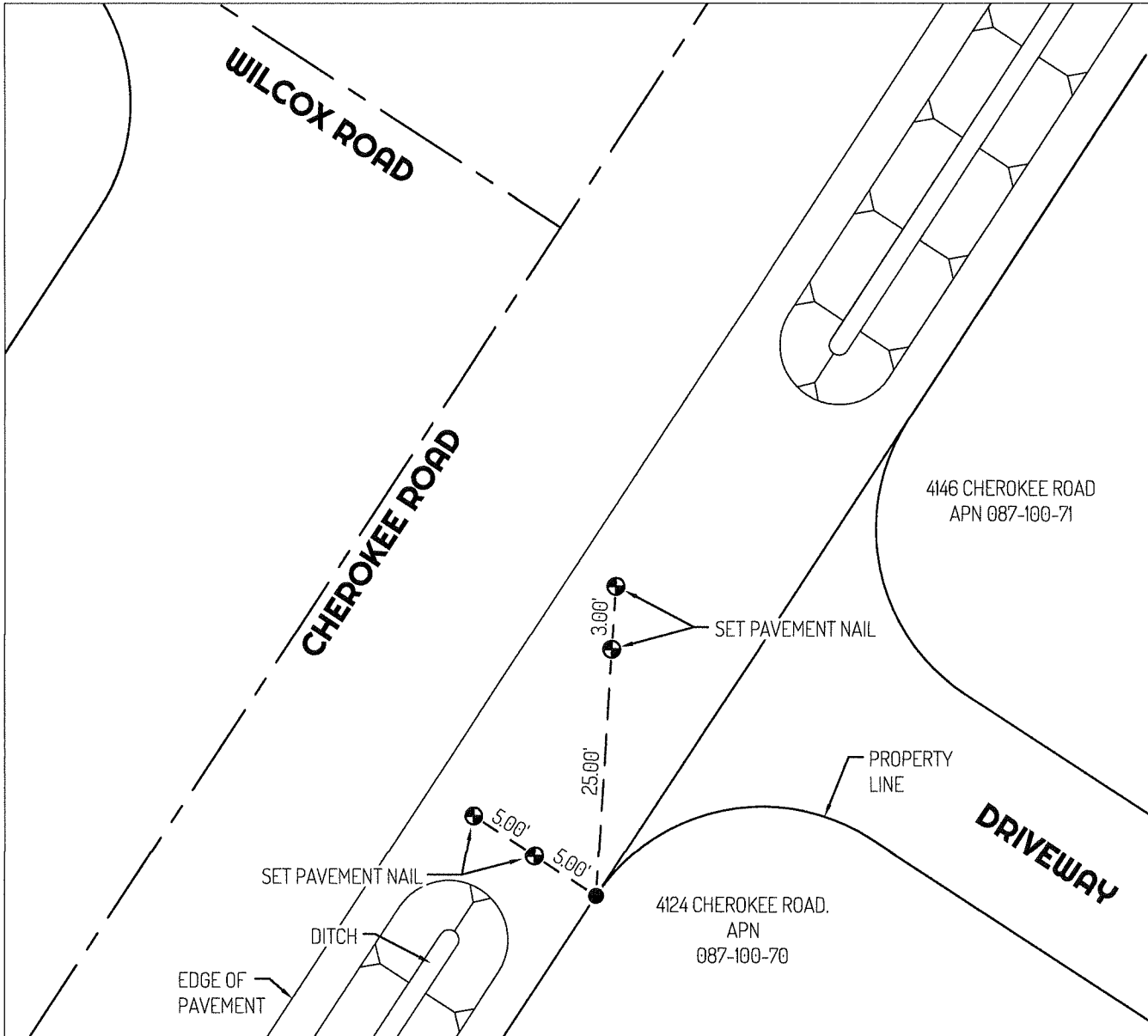

LEGEND

- FOUND 3/4" REBAR, PER (A) NO CAP OR TAG
- ⊙— SET CONTROL POINT
- 435 REFERENCE STREET ADDRESS
- APN ASSESSOR'S PARCEL NUMBER

LINETYPES

- - - CENTERLINE
- EDGE OF PAVEMENT
- PROPERTY LINE
- - - TIE LINES

REFERENCES

- (A) 13-PM-28

