

# CORNER RECORD

Agency Index CR-22-257

Document Number \_\_\_\_\_

City of \_\_\_\_\_ County of SAN JOAQUIN COUNTY, California

Brief Legal Description 1.05 ACRE PROPERTY AS SHOWN ON RS 27-114.

### CORNER TYPE

### COORDINATES (Optional)

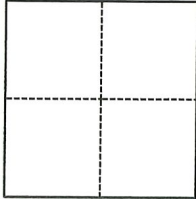

- Government Corner
- Meander
- Rancho
- Control
- Property
- Other

N. \_\_\_\_\_ E. \_\_\_\_\_

Elevation \_\_\_\_\_

Units  Metric  U.S. Survey Foot

Horizontal Datum \_\_\_\_\_

Zone \_\_\_\_\_ Epoch Date \_\_\_\_\_

Vertical Datum \_\_\_\_\_

Complies with Public Resources Code §§8801-8819

Complies with Public Resources Code §§8890-8902

Date of Survey AUGUST 18, 2022

PLS Act Ref.:  8765(d)  8771  8773  Other:

Corner/Monument:  Left as found  Established  Rebuilt  Pre-Construction

Found and tagged  Reestablished  Referenced  Post-Construction

Narrative of corner identified and monument as found, set, reset, replaced, or removed:

See sheet #2 for description(s):

**CORNER RECORD TO REESTABLISH PROPERTY CORNERS WHICH WERE OBLITERATED.**

### SURVEYOR'S STATEMENT

This Corner Record was prepared by me or under my direction in conformance with

the Professional Land Surveyors' Act on October 3, 2022

Signed Zachary C. Wong P.L.S. or R.C.E. No. LS 7600

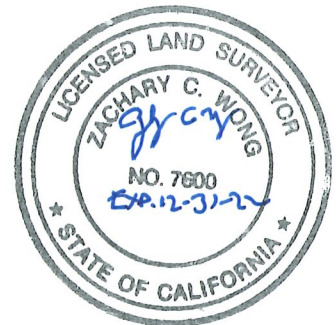

### COUNTY SURVEYOR'S STATEMENT

This Corner Record was received October 4, 2022

and examined and filed October 13, 2022

Signed James E. Hart P.L.S. or R.C.E. No. 8657

Title County Surveyor

County Surveyor's Comment



**DESCRIPTION:**

THIS DOCUMENT IS FOR THE PURPOSE OF  
 RESETTING ANY MISSING OR OBLITERATED  
 CORNERS FROM 1.05-ACRE PARCEL, AS  
 SHOWN ON BOOK 27 OF SURVEYS, PAGE  
 114, SAN JOAQUIN COUNTY RECORDS.

**REFERENCES:**

- (A) RS 13-88, S.J.C.R.
- (B) RS 27-114, S.J.C.R.

**NOTES:**

- ① FD. 2" I. PIPE AT SOUTHEAST  
 COR. OF LOT 39 PER M&P 10-26  
 [PIPE AT LOT COR.] (A)
- ② FD. 3/4" I. PIN (B).
- ③ FD. 1" I. PIPE (A).

*SUBDIVISION NO.2  
 CLARKADOTA  
 FIG PLANTATIONS  
 M&P 10-26*

*LOT 40*

**LEGENDS:**

- B.O.B. BASIS OF BEARINGS
- COR. CORNER
- EX. EXISTING
- FD. FOUND
- I IRON
- M&P MAPS & PLATS, BOOK-PAGE
- (M) MEASURED
- P.U.E. PUBLIC UTILITY EASEMENT
- R.S. RECORD OF SURVEY, BOOK-PAGE
- SFN SEARCHED, FOUND NOTHING
  
- FOUND MONUMENT AS NOTED
- SET CHISELED CROSS WITH  
 BRASS TAG L.S. 7600  
 S17°52'00"E 5.00' FROM  
 PROPERTY CORNER

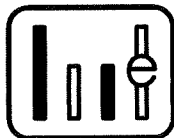
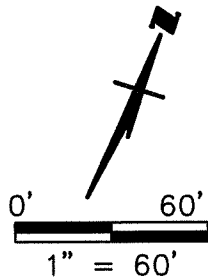

**WONG ENGINEERS, INC.**  
 PLANNING ENGINEERING SURVEYING  
 4578 FEATHER RIVER DRIVE, SUITE A  
 STOCKTON, CALIFORNIA (209) 476-0011  
 OCTOBER 3, 2022 2 OF 2

