

CORNER RECORD

Agency Index

CR 22-224

Document Number

City of Manteca County of San Joaquin, CaliforniaBrief Legal Description Airport Way at NW corner Sec 19, T1S, R7E, M.D.B.M.**CORNER TYPE****COORDINATES (Optional)**

X

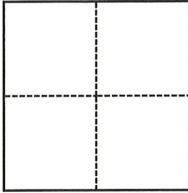

- ☒ Government Corner ☐ Control
☐ Meander ☐ Property
☐ Rancho ☐ Other

Date of Survey July 6, 2022

N. _____ E. _____

Elevation _____

Units ☐ Metric ☒ U.S. Survey Foot

Horizontal Datum _____

Zone _____ Epoch Date _____

Vertical Datum _____

☐ Complies with Public Resources Code §§8801-8819☐ Complies with Public Resources Code §§8890-8902

PLS Act Ref.:

☐ 8765(d)☒ 8771☐ 8773☐ Other:Corner/
Monument:☒ Left as found☐ Established☐ Rebuilt☒ Pre-Construction☐ Found and tagged☐ Reestablished☒ Referenced☐ Post-Construction

Narrative of corner identified and monument as found, set, reset, replaced, or removed:

☒ See sheet #2 for description(s):**SURVEYOR'S STATEMENT**

This Corner Record was prepared by me or under my direction in conformance with

the Professional Land Surveyors' Act on July 28, 2022

Signed

P.L.S. or R.C.E. No.

8159**COUNTY SURVEYOR'S STATEMENT**

This Corner Record was received

August 3, 2022

and examined and filed

August 18, 2022

Signed

P.L.S. or R.C.E. No.

8657

Title

County Surveyor

County Surveyor's Comment



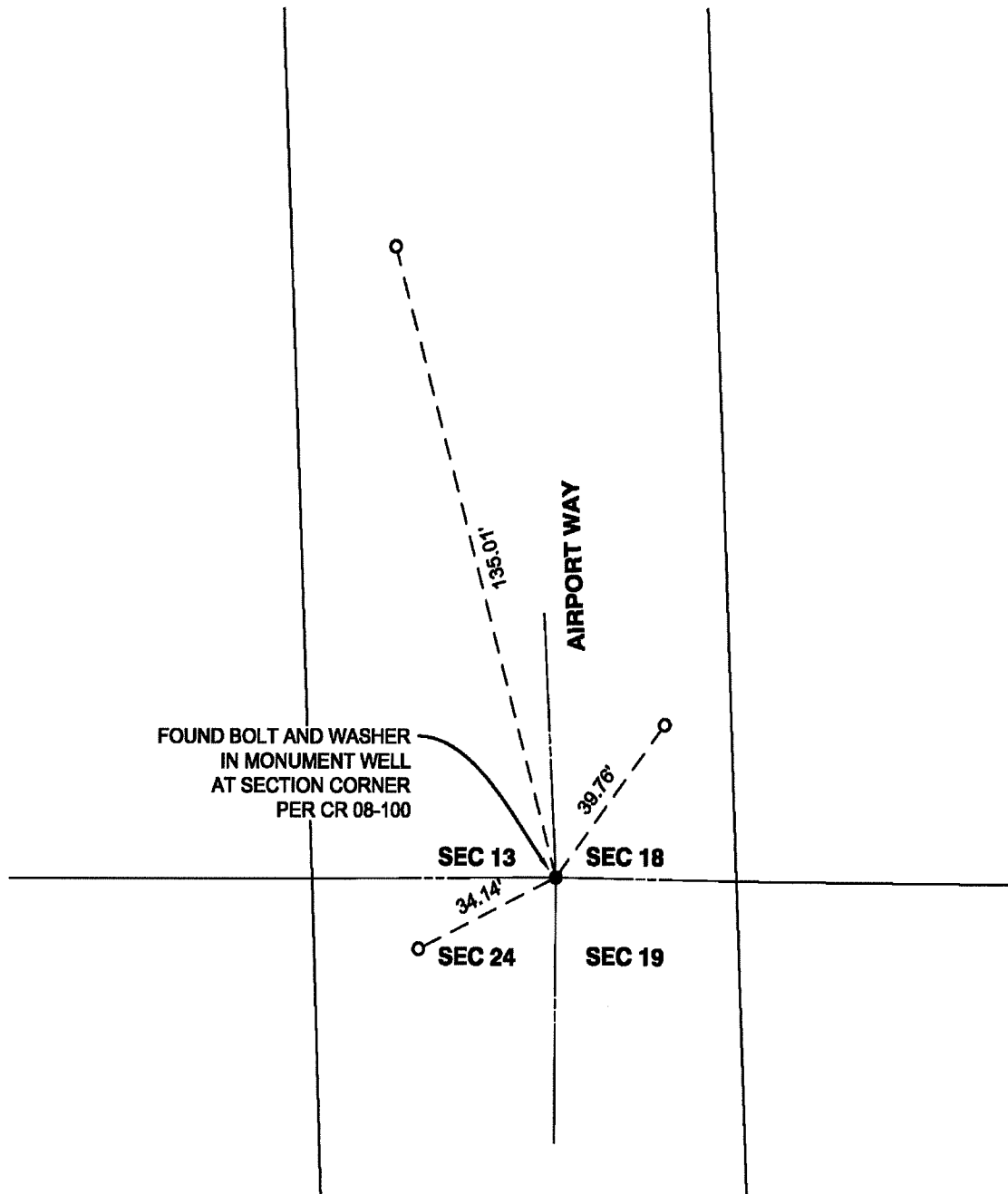

NOTES:

- FOUND MONUMENT AS NOTED
- SET 3/4" IRON PIPE WITH PLASTIC CAP, STAMPED L.S. 8159
- CR CORNER RECORD, SAN JOAQUIN COUNTY SURVEYOR'S RECORDS



NOT TO SCALE