

CORNER RECORD

Agency Index CR-22-155
Document Number _____

City of Escalon County of San Joaquin, California
Brief Legal Description Lot 4, Volume 29 of Maps and Plats at Page 43

CORNER TYPE

COORDINATES (Optional)

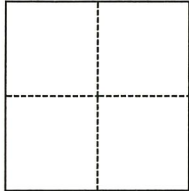

- Government Corner
- Meander
- Rancho
- Control
- Property
- Other

Date of Survey April 8, 2022

N. _____ E. _____

Elevation _____

Units Metric U.S. Survey Foot

Horizontal Datum _____

Zone _____ Epoch Date _____

Vertical Datum _____

Complies with Public Resources Code §§8801-8819

Complies with Public Resources Code §§8890-8902

PLS Act Ref.: 8765(d) 8771 8773 Other:

Corner/Monument: Left as found Established Rebuilt Pre-Construction
 Found and tagged Reestablished Referenced Post-Construction

Narrative of corner identified and monument as found, set, reset, replaced, or removed:

See sheet #2 for description(s):

SURVEYOR'S STATEMENT

This Corner Record was prepared by me or under my direction in conformance with
the Professional Land Surveyors' Act on May 16, 2022

Signed Brett Chappell P.L.S. or R.C.E. No. 7547

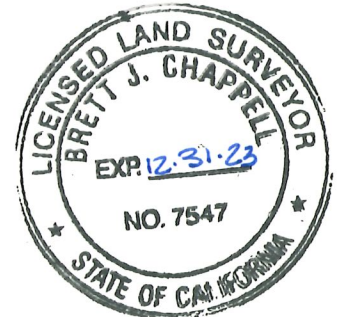

COUNTY SURVEYOR'S STATEMENT

This Corner Record was received May 23, 2022
and examined and filed June 2, 2022

Signed James E. Hart P.L.S. or R.C.E. No. 8657
Title County Surveyor

County Surveyor's Comment _____



