

CORNER RECORD

Agency Index CR-22-148

Document Number _____

City of Lodi County of San Joaquin, California

Brief Legal Description Property monuments at Lodi Avenue near Rose Street

CORNER TYPE

COORDINATES (Optional)

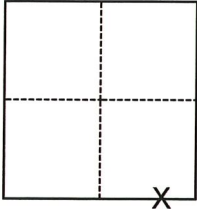

- Government Corner
- Meander
- Rancho
- Control
- Property
- Other

N. _____ E. _____

Elevation _____

Units Metric U.S. Survey Foot

Horizontal Datum _____

Zone _____ Epoch Date _____

Vertical Datum _____

Complies with Public Resources Code §§8801-8819

Complies with Public Resources Code §§8890-8902

Date of Survey October 14, 2021

Section 2, T.3N.,R.6E.
M.D.B.&M.

PLS Act Ref.: 8765(d) 8771 8773 Other:

Corner/Monument: Left as found Established Rebuilt Pre-Construction

Found and tagged Reestablished Referenced Post-Construction

Narrative of corner identified and monument as found, set, reset, replaced, or removed:

See sheet #2 for description(s):

FOUND MONUMENTS PER RS 27-44 AND M&P 1-58. VERIFIED LOCATION USING CHISELED CROSS "G" OF NO RECORD, AND NAILS AND WASHERS STAMPED C.O.L. LS 9478, PER CR-21-101. NO BOUNDARY ANALYSIS WAS PERFORMED.

SURVEYOR'S STATEMENT

This Corner Record was prepared by me or under my direction in conformance with

the Professional Land Surveyors' Act on 2/28/22

Signed [Signature] P.L.S. or R.C.E. No. 9478

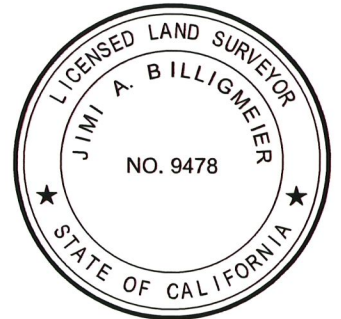

COUNTY SURVEYOR'S STATEMENT

This Corner Record was received March 31, 2022

and examined and filed April 14, 2022

Signed James E. Hart P.L.S. or R.C.E. No. 8657

Title County Surveyor

County Surveyor's Comment



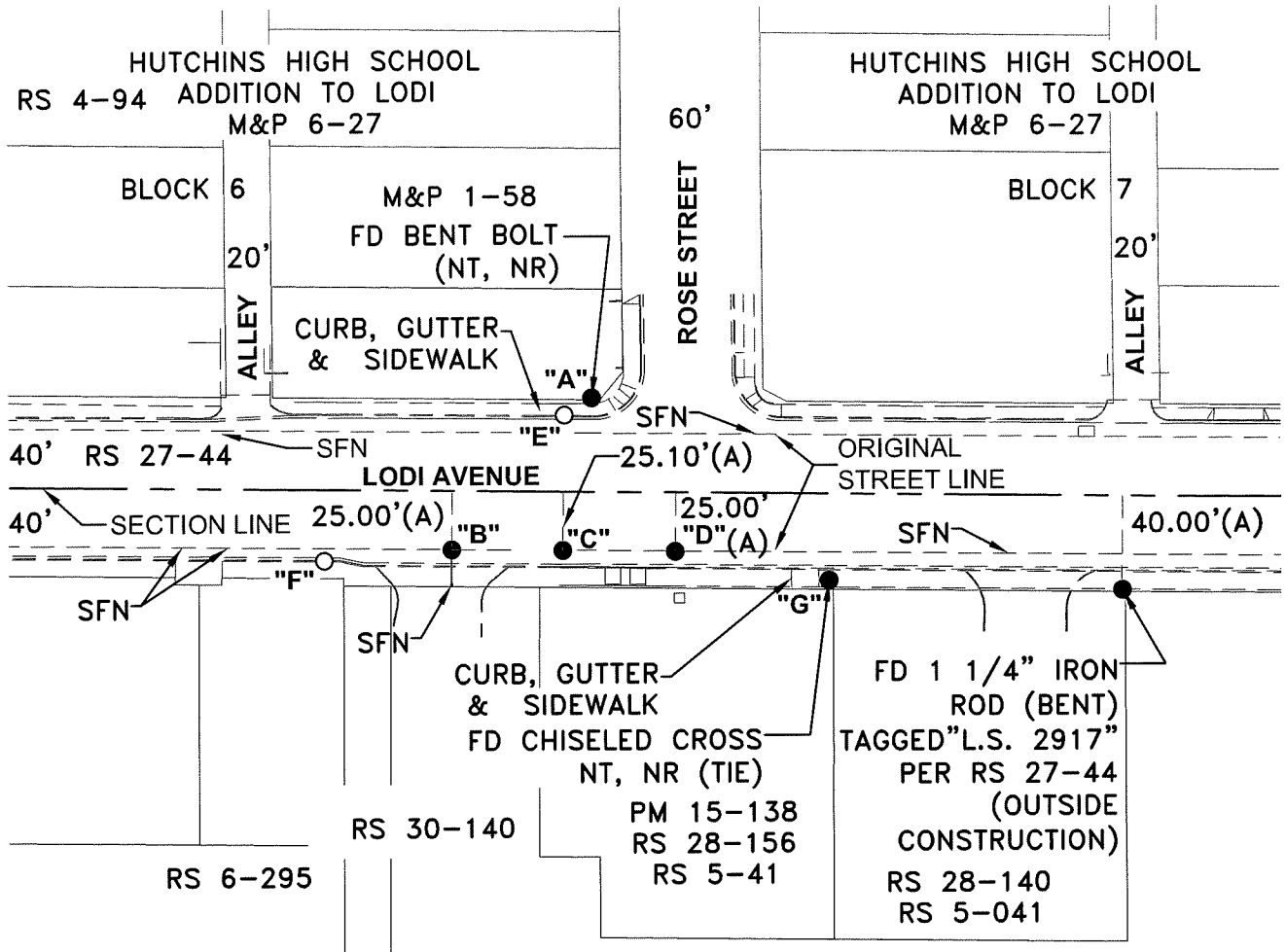

DISTANCE (M) TABLE							
FD. MONUMENT	FROM	DISTANCE	FROM2	DISTANCE2	FROM3	DISTANCE3	
"A"	SEE MAP ABOVE	"E"	13.80'	"F"	133.72'	"G"	128.11'
"B"	BOLT & WASHER, (A), NT	"E"	74.83'	"F"	54.63'	"G"	162.19'
"C"	BOLT, NO WASHER, (A), NT	"E"	57.72'	"F"	102.12'	"G"	114.76'
"D"	BOLT & WASHER, (A), NT	"E"	75.00'	"F"	150.07'	"G"	67.21'

LEGEND

- FOUND MONUMENT AS NOTED
- FOUND NAIL & WASHER STAMPED "C.O.L. LS 9478"
- FD FOUND ON THIS SURVEY
- M&P MAPS & PLATS, VOLUME AND PAGE, S.J.C.R.
- RS RECORD OF SURVEY, BOOK AND PAGE, S.J.C.R.
- PM PARCEL MAP, BOOK AND PAGE, S.J.C.R.
- S.J.C.R. SAN JOAQUIN COUNTY RECORDS
- (M) MEASURED ON THIS SURVEY
- (NT, NR) NO TAG, NO RECORD (AS NOTED)
- SFN SEARCHED, FOUND NOTHING

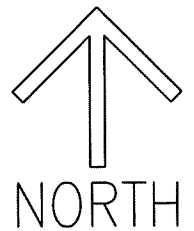

REFERENCE

(A) RS 27-44

SCALE: 1"=80'

021A004.DWG