

# CORNER RECORD

Agency Index CR-22-103  
 Document Number \_\_\_\_\_

City of \_\_\_\_\_ County of San Joaquin, California  
 Brief Legal Description Briggs Road 1480'± west of Manthey Road  
Within Sec. 03, C.M. Weber Grant

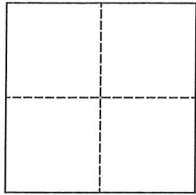

CORNER TYPE		COORDINATES (Optional)	
Government Corner	<input type="checkbox"/> Control	N. _____	E. _____
Meander	<input type="checkbox"/> Property	Elevation. _____	
Rancho	<input type="checkbox"/> Other	Units Metric <input type="checkbox"/> U.S. Survey Foot <input checked="" type="checkbox"/>	
Date of Survey	<u>October 14, 2021</u>	Horizontal Datum _____	
		Zone _____ Epoch Date _____	
		Vertical Datum _____	
		<input type="checkbox"/> Complies with Public Resources Code §§8801-8819	
		<input type="checkbox"/> Complies with Public Resources Code §§8890-8902	

PLS Act Ref.:	<input type="checkbox"/> 8765(d)	<input checked="" type="checkbox"/> 8771	<input type="checkbox"/> 8773	<input type="checkbox"/> Other:
Corner/ Monument:	<input type="checkbox"/> Left as found	<input type="checkbox"/> Established	<input type="checkbox"/> Rebuilt	<input type="checkbox"/> Pre-Construction
	<input type="checkbox"/> Found and tagged	<input checked="" type="checkbox"/> Reestablished	<input type="checkbox"/> Referenced	<input checked="" type="checkbox"/> Post-Construction

Narrative of corner identified and monument as found, set, reset, replaced, or removed:  
 See sheet #2 for description(s):

## SURVEYOR'S STATEMENT

This Corner Record was prepared by me or under my direction in conformance with  
 the Professional Land Surveyor's Act on December 15, 2021  
 Signed James E. Hart P.L.S. or R.C.E. No. 8657



## COUNTY SURVEYOR'S STATEMENT

This Corner Record was received February 2, 2022  
 and examined and filed March 1, 2022  
 Signed James E. Hart P.L.S. or R.C.E. No. 8657  
 Title County Surveyor



County Surveyor's Comment \_\_\_\_\_

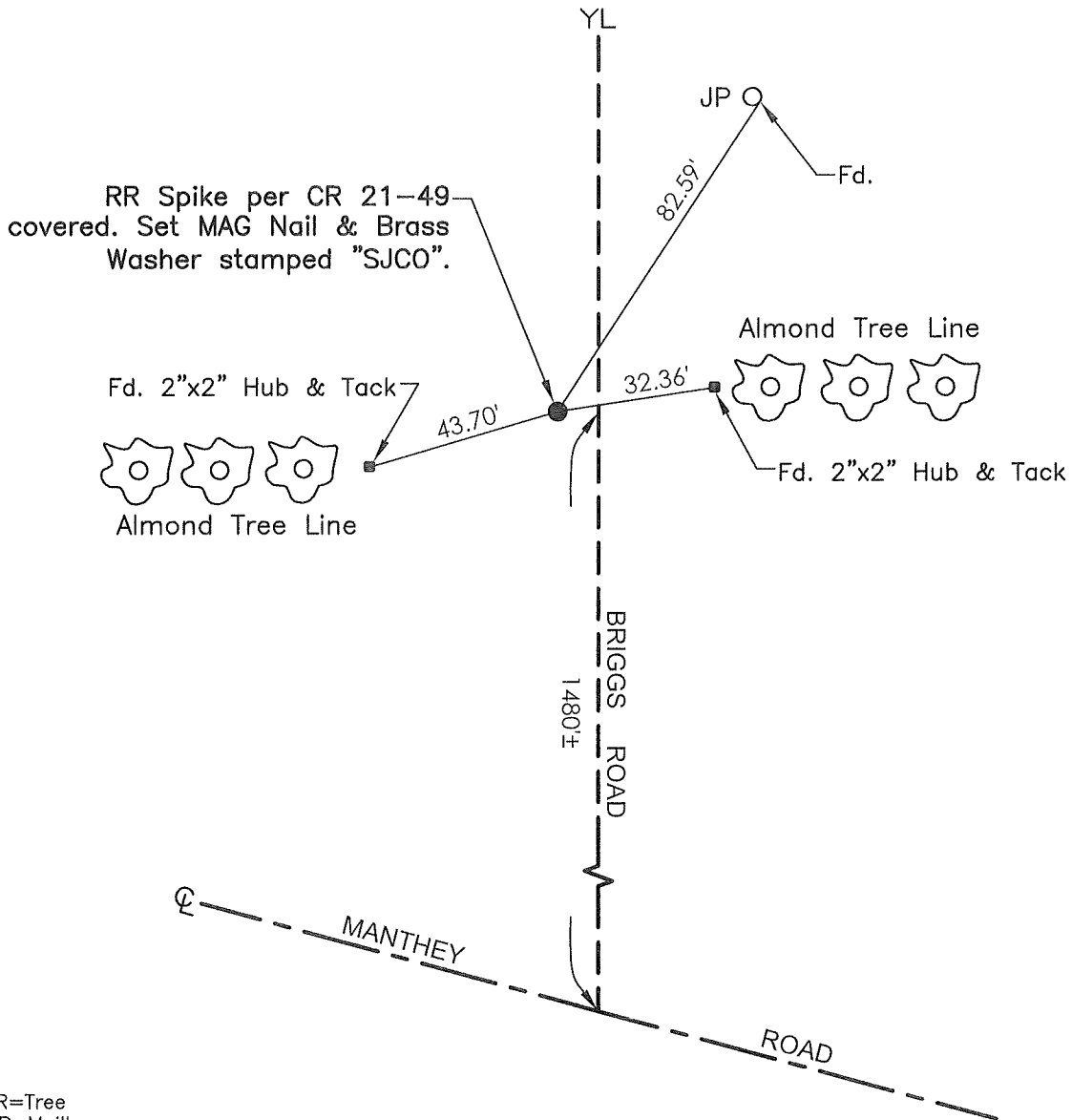

- TR=Tree
- MB=Mailbox
- BM=Bench Mark
- EP=Edge of Pavement
- YL=Yellow Line
- FH=Fire Hydrant
- CR=Corner Record
- FP=Fence Post
- JP=Joint Pole
- LP=Light Pole
- PP=Power Pole
- GP=Guy Pole
- SP=Service Pole
- TP=Telephone Pole
- S.F.N.=Searched Found Nothing
- N.T.S.=Not To Scale
- M&P=Maps & Plats
- PM=Parcel Map
- RS=Record of Survey
- FB=Field Book
- N=North
- SDI=Storm Drain Inlet
- TOC=Top of Curb
- PCC=Portland Cement Concrete

Set=Conc. Nail with Brass Washer stamped "S.J. Co.", unless otherwise noted  
 Fd.=Found Conc. Nail with Brass Washer stamped "S.J. Co.", unless otherwise noted  
 Note: Found Monuments are not tagged unless otherwise noted.

"No attempt was made to verify the Monument(s)"