

# CORNER RECORD

Agency Index CR-22-076  
 Document Number \_\_\_\_\_

City of \_\_\_\_\_ County of San Joaquin, California

Brief Legal Description River Road 1,300'± west of Carrollton Road  
Within Sec. 15, T2S, R8E, Mount Diablo Base & Meridian

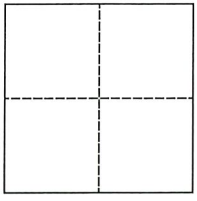

CORNER TYPE		COORDINATES (Optional)	
Government Corner	<input type="checkbox"/> Control	N. _____	E. _____
Meander	<input type="checkbox"/> Property	<input type="checkbox"/> Elevation. _____	
Rancho	<input type="checkbox"/> Other	<input type="checkbox"/> Units	Metric <input type="checkbox"/> U.S. Survey Foot <input checked="" type="checkbox"/>
Date of Survey	<u>March 19, 2021</u>	<input checked="" type="checkbox"/> Horizontal Datum _____	
		Zone _____	Epoch Date _____
		Vertical Datum _____	
		<input type="checkbox"/> Complies with Public Resources Code §§8801-8819	
		<input type="checkbox"/> Complies with Public Resources Code §§8890-8902	

PLS Act Ref.:	<input type="checkbox"/> 8765(d)	<input checked="" type="checkbox"/> 8771	<input type="checkbox"/> 8773	<input type="checkbox"/> Other:
Corner/ Monument:	<input checked="" type="checkbox"/> Left as found	<input type="checkbox"/> Established	<input type="checkbox"/> Rebuilt	<input checked="" type="checkbox"/> Pre-Construction
	<input type="checkbox"/> Found and tagged	<input type="checkbox"/> Reestablished	<input type="checkbox"/> Referenced	<input type="checkbox"/> Post-Construction

Narrative of corner identified and monument as found, set, reset, replaced, or removed:  
 See sheet #2 for description(s):

### SURVEYOR'S STATEMENT

This Corner Record was prepared by me or under my direction in conformance with  
 the Professional Land Surveyor's Act on April 18, 2021  
 Signed James E. Hart P.L.S. or R.C.E. No. 8657



### COUNTY SURVEYOR'S STATEMENT

This Corner Record was received March 9, 2022  
 and examined and filed March 28, 2022  
 Signed James E. Hart P.L.S. or R.C.E. No. 8657  
 Title County Surveyor



County Surveyor's Comment

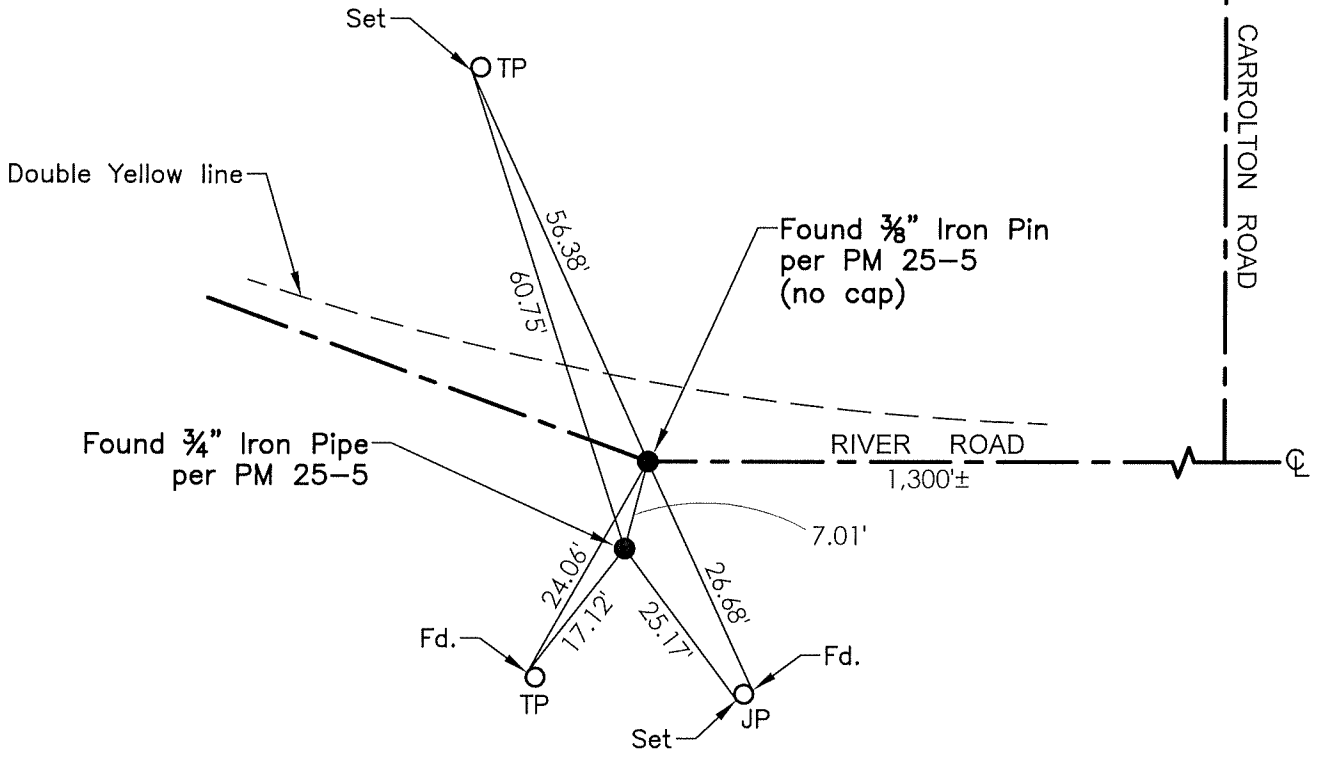

- TR=Tree
- MB=Mailbox
- BM=Bench Mark
- EP=Edge of Pavement
- YL=Yellow Line
- FH=Fire Hydrant
- CR=Corner Record
- FP=Fence Post
- JP=Joint Pole
- LP=Light Pole
- PP=Power Pole
- GP=Guy Pole
- SP=Service Pole
- TP=Telephone Pole
- S.F.N.=Searched Found Nothing
- N.T.S.=Not To Scale
- M&P=Maps & Plats
- PM=Parcel Map
- RS=Record of Survey
- FB=Field Book
- N=North
- SDI=Storm Drain Inlet
- TOC=Top of Curb
- PCC=Portland Cement Concrete

Set=Conc. Nail with Brass Washer stamped  
 "S.J. Co.", unless otherwise noted  
 Fd.=Found Conc. Nail with Brass Washer stamped  
 "S.J. Co.", unless otherwise noted  
 Note: Found Monuments are not tagged unless  
 otherwise noted.

"No attempt was made to verify the Monument(s)"