

CORNER RECORD

Agency Index CR-21-204

Document Number _____

City of STOCKTON

County of SAN JOAQUIN, California

Brief Legal Description RIGHT-OF-WAY MONUMENTS NEAR E FULTON ST & WEST LN

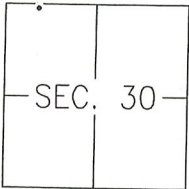

C.M.WEBER
GRANT

CORNER TYPE

- Government Corner Control
 Meander Property
 Rancho Other

Date of Survey 2021-05-12

COORDINATES (Optional)

N. _____ E. _____

Elevation _____

Units Metric U.S. Survey Foot

Horizontal Datum _____

Zone _____ Epoch Date _____

Vertical Datum: _____

Complies with Public Resources Code §§8801-8819

Complies with Public Resources Code §§8890-8902

PLS Act Ref.: 8765(d) 8771 8773

Other: _____

Corner/Monument: Left as found Established Rebuilt Pre-Construction
 Found and tagged Reestablished Referenced Post-Construction

Narrative of corner identified and monument as found, set, reset, replaced, or removed:
 See sheet #2 for description(s):

SURVEYOR'S STATEMENT

This Corner Record was prepared by me or under my direction in conformance with the Professional Land Surveyor's Act on Sept. 30, 2021.

Signed [Signature], P.L.S. or R.C.E. No.: 8366



COUNTY SURVEYOR'S STATEMENT

This Corner Record was received November 5, 2021 and examined and filed December 2, 2021.

Signed James E. Hart, P.L.S. or R.C.E. No.: 8657

Title County Surveyor

County Surveyor's Comment _____



PARCEL "B"
OF 13-PM-162,
S.J.C.R.

SET SCRIBED "X"
IN TOP OF CURB

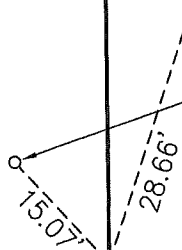

FOUND 3/4" IRON PIN PER
13-PM-162, S.J.C.R.

WEST LANE

FULTON STREET

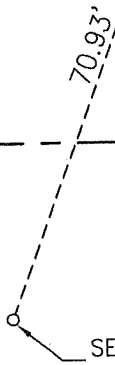

SET SCRIBED "X" IN
TOP OF CURB

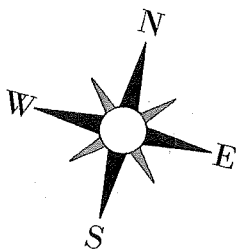

LEGEND:

PM PARCEL MAP
S.J.C.R. SAN JOAQUIN COUNTY RECORDS

