

CORNER RECORD

Agency Index CR-21-150
 Document Number _____

City of _____ County of San Joaquin, California
 Brief Legal Description Olive Avenue 1316± north of West Ripon Road
Within Sec. 24, T2S, R7E, Mount Diablo Base & Meridian

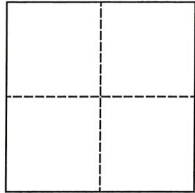

CORNER TYPE		COORDINATES (Optional)	
Government Corner	<input type="checkbox"/>	Control	<input type="checkbox"/>
Meander	<input type="checkbox"/>	Property	<input type="checkbox"/>
Rancho	<input type="checkbox"/>	Other	<input checked="" type="checkbox"/>
Date of Survey	<u>July 28, 2021</u>		
		N. _____	E. _____
		Elevation.	_____
		Units	Metric <input type="checkbox"/> U.S. Survey Foot <input checked="" type="checkbox"/>
		Horizontal Datum	_____
		Zone	_____ Epoch Date _____
		Vertical Datum	_____
		<input type="checkbox"/> Complies with Public Resources Code §§8801-8819	
		<input type="checkbox"/> Complies with Public Resources Code §§8890-8902	

PLS Act Ref.:	<input type="checkbox"/> 8765(d)	<input checked="" type="checkbox"/> 8771	<input type="checkbox"/> 8773	<input type="checkbox"/> Other:
Corner/ Monument:	<input checked="" type="checkbox"/> Left as found	<input type="checkbox"/> Established	<input type="checkbox"/> Rebuilt	<input type="checkbox"/> Pre-Construction
	<input type="checkbox"/> Found and tagged	<input type="checkbox"/> Reestablished	<input type="checkbox"/> Referenced	<input checked="" type="checkbox"/> Post-Construction

Narrative of corner identified and monument as found, set, reset, replaced, or removed:
 See sheet #2 for description(s):

SURVEYOR'S STATEMENT

This Corner Record was prepared by me or under my direction in conformance with
 the Professional Land Surveyor's Act on August 4, 2021
 Signed James E. Hart P.L.S. or R.C.E. No. 8657



COUNTY SURVEYOR'S STATEMENT

This Corner Record was received September 13, 2021
 and examined and filed September 29, 2021
 Signed James E. Hart P.L.S. or R.C.E. No. 8657
 Title County Surveyor



County Surveyor's Comment

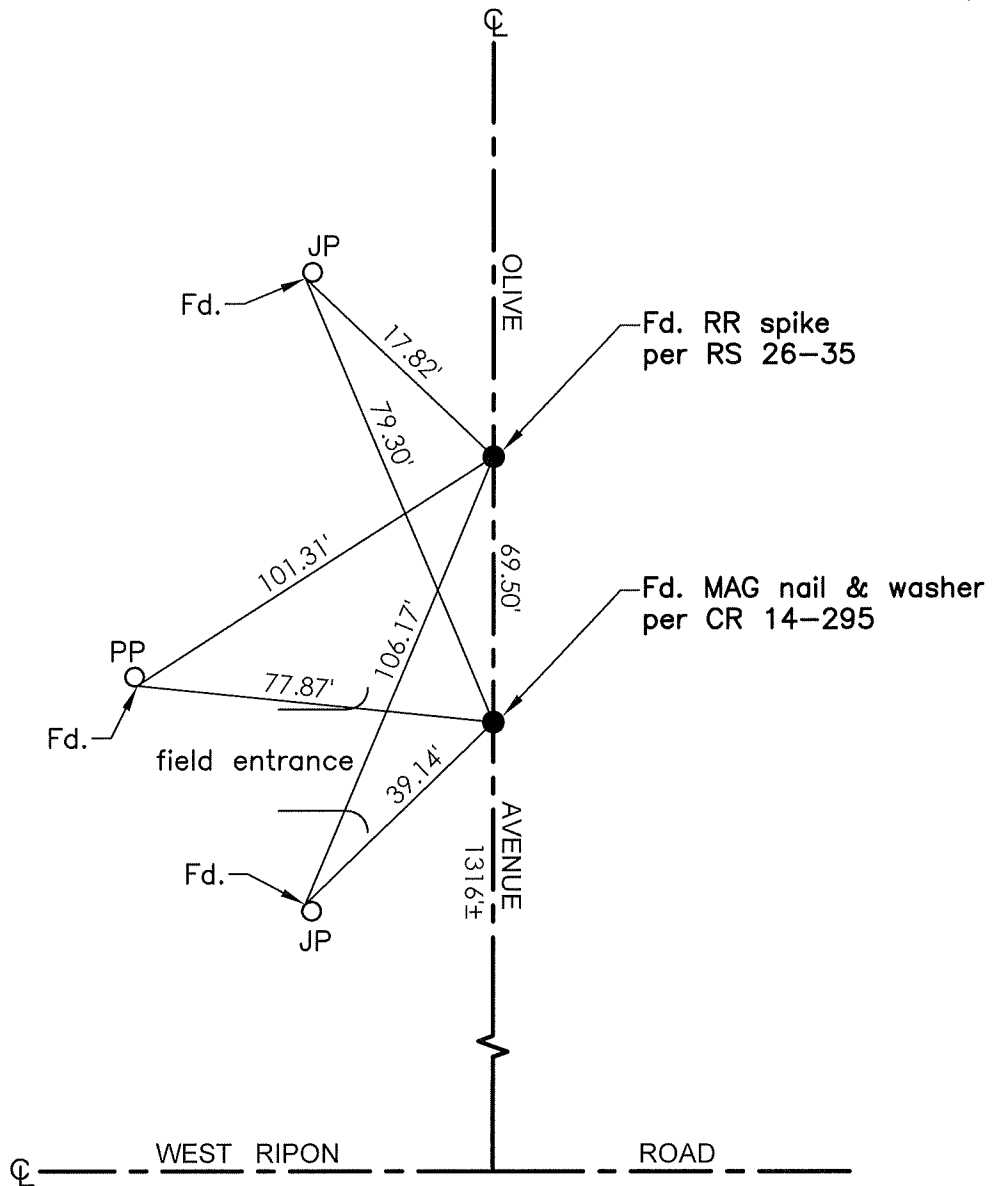

- TR=Tree
- MB=Mailbox
- BM=Bench Mark
- EP=Edge of Pavement
- YL=Yellow Line
- FH=Fire Hydrant
- CR=Corner Record
- FP=Fence Post
- JP=Joint Pole
- LP=Light Pole
- PP=Power Pole
- GP=Guy Pole
- SP=Service Pole
- TP=Telephone Pole
- S.F.N.=Searched Found Nothing
- N.T.S.=Not To Scale
- M&P=Maps & Plats
- PM=Parcel Map
- RS=Record of Survey
- FB=Field Book
- N=North
- SDI=Storm Drain Inlet
- TOC=Top of Curb
- PCC=Portland Cement Concrete

Set=Conc. Nail with Brass Washer stamped
 "S.J. Co.", unless otherwise noted
 Fd.=Found Conc. Nail with Brass Washer stamped
 "S.J. Co.", unless otherwise noted
 Note: Found Monuments are not tagged unless
 otherwise noted.

"No attempt was made to verify the Monument(s)"