

CORNER RECORD

Agency Index CR-21-100
 Document Number _____

City of Lodi County of San Joaquin, California
 Brief Legal Description Property monuments at Lodi Avenue (Hutchins Street-California Street)

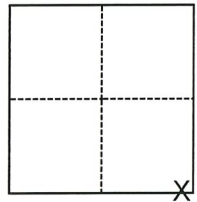

- CORNER TYPE**
- Government Corner
 - Meander
 - Rancho
 - Control
 - Property
 - Other

- COORDINATES (Optional)**
- N. _____ E. _____
 Elevation _____
 Units Metric U.S. Survey Foot
 Horizontal Datum _____
 Zone _____ Epoch Date _____
 Vertical Datum _____
 Complies with Public Resources Code §§8801-8819
 Complies with Public Resources Code §§8890-8902

Section 2, T.3N., R.6E.
 M.D.B.&M.

Date of Survey February 8, 2021

- PLS Act Ref.: 8765(d) 8771 8773 Other:
 Corner/Monument: Left as found Established Rebuilt Pre-Construction
 Found and tagged Reestablished Referenced Post-Construction

Narrative of corner identified and monument as found, set, reset, replaced, or removed:
 See sheet #2 for description(s):

FOUND SECTION CORNER, CHISELED PROPERTY CORNERS PER RS 5-125 AND RS 30-140 AND UNREFERENCED MONUMENTS NEAR LOT LINE PROJECTIONS. NO BOUNDARY ANALYSIS WAS PERFORMED.

SURVEYOR'S STATEMENT

This Corner Record was prepared by me or under my direction in conformance with the Professional Land Surveyors' Act on June 14, 2021.
 Signed [Signature] P.L.S. or R.C.E. No. 9478



COUNTY SURVEYOR'S STATEMENT

This Corner Record was received June 17, 2021
 and examined and filed July 6, 2021.
 Signed James E. Hart P.L.S. or R.C.E. No. 8657
 Title County Surveyor



County Surveyor's Comment

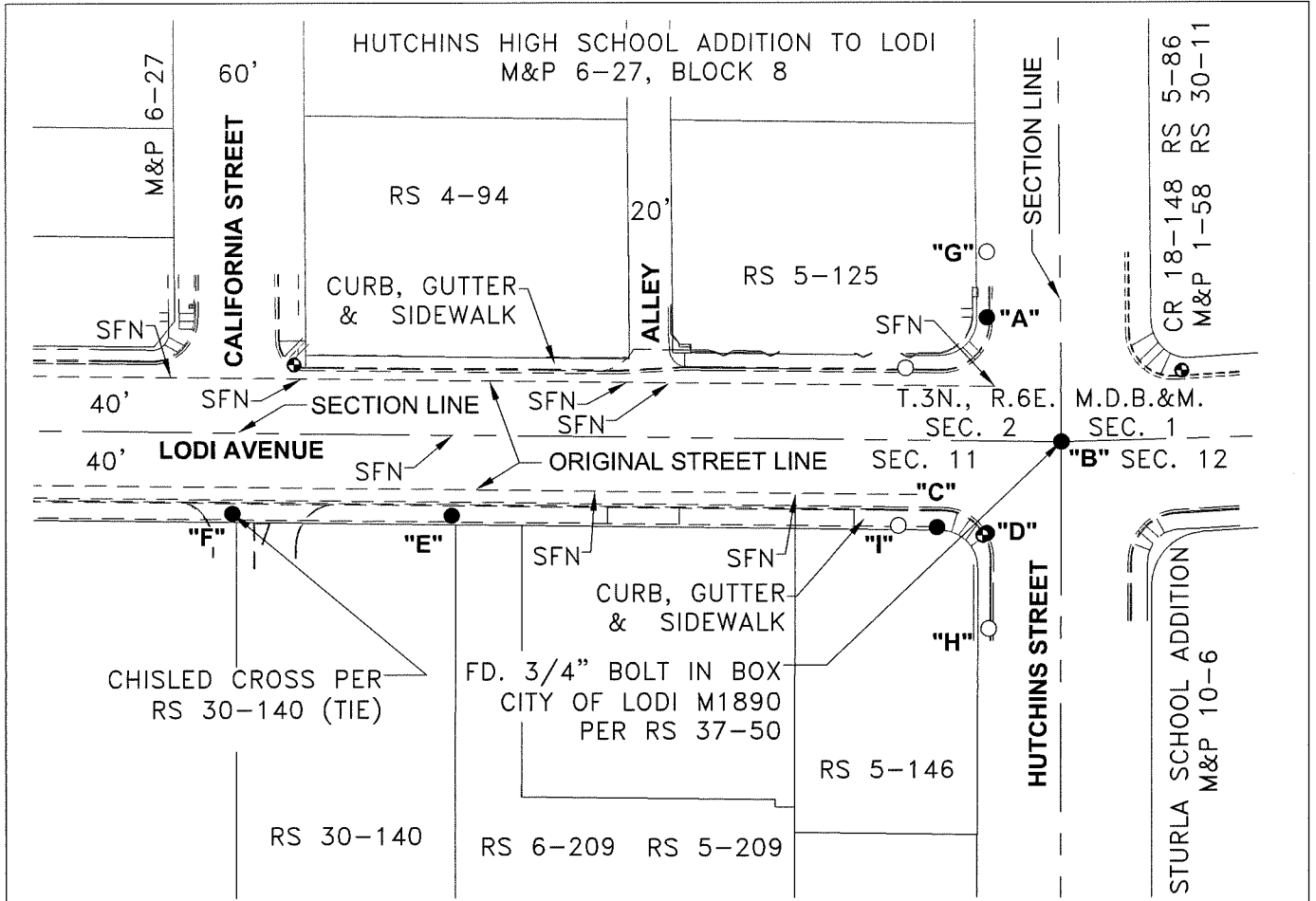

DISTANCE (M) TABLE									
	FD. MONUMENT	FROM	DISTANCE	FROM2	DISTANCE2	FROM3	DISTANCE3	FROM4	DISTANCE4
"A"	CHIS. "+", NT, NR	"F"	358.61'	"G"	30.04'	"H"	142.74'	"I"	103.62'
"B"	SEE MAP ABOVE	"F"	382.95'	"G"	93.54'	"H"	92.06'	"I"	84.19'
"C"	IRON ROD, NT, NR	"F"	324.48'	"G"	128.21'	"H"	52.31'	"I"	17.81'
"D"	PK NAIL, NT, NR	"F"	347.38'	"G"	128.88'	"H"	43.91'	"I"	40.78'
"E"	CHIS. "+", NT, RS 30-140	"F"	100.70'	"G"	274.43'	"H"	252.89'	"I"	205.99'

LEGEND

- FOUND MONUMENT AS NOTED
- SET NAIL & WASHER STAMPED "C.O.L. LS 9478"
- ◐ FOUND CITY OF LODI BENCHMARK (TO BE RESET BY CITY IF DESTROYED)
- FD. FOUND ON THIS SURVEY
- CHIS. "+" CHISELED CROSS
- M&P MAPS & PLATS, VOLUME AND PAGE, S.J.C.R.
- RS RECORD OF SURVEY, BOOK AND PAGE, S.J.C.R.
- PM PARCEL MAP, BOOK AND PAGE, S.J.C.R.
- CR CORNER RECORD, SAN JOAQUIN COUNTY SURVEYOR'S RECORDS
- S.J.C.R. SAN JOAQUIN COUNTY RECORDS
- (M) MEASURED ON THIS SURVEY
- (NT, NR) NO TAG, NO RECORD (AS NOTED)
- SFN SEARCHED, FOUND NOTHING



SCALE: 1"=80'

021A004.DWG