

CORNER RECORD

Agency Index CR-21-086

Document Number _____

City of _____ County of San Joaquin, California

Brief Legal Description _____ NGS Benchmark E-1128 (HS 0659)

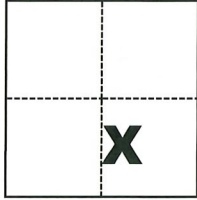
CORNER TYPE**COORDINATES (Optional)**

- Government Corner Control
 Meander Property
 Rancho Other

N. 2077955 Ft. E. 6347668 Ft.

Elevation _____

Units Metric U.S. Survey FootHorizontal Datum NAD83Zone SPC-3 Epoch Date _____

Vertical Datum _____

 Complies with Public Resources Code §§8801-8819 Complies with Public Resources Code §§8890-8902Sec. 6, T.3S., R.7E.,
M.D.B. & M.Date of Survey February 18, 2021PLS Act Ref.: 8765(d) 8771 8773 Other:

Corner/
Monument: Left as found Established Rebuilt Pre-Construction
 Found and tagged Reestablished Referenced Post-Construction

Narrative of corner identified and monument as found, set, reset, replaced, or removed:

 See sheet #2 for description(s):

SPC - 3 coordinates listed are the result of Post Processing (differentially correcting) data that was logged from an Ashtech Mobile Mapper 10 handheld GPS receiver and are in the sub-meter accuracy range.

These Geodetic and Grid coordinates are provided for the purpose of facilitating locating the monument

Found as described in NGS Datasheet for E-1128 (PID HS 0659)

SURVEYOR'S STATEMENT

This Corner Record was prepared by me or under my direction in conformance with

the Professional Land Surveyors' Act on May 25, 2021Signed Michael L. Quartaroli P.L.S. or R.C.E. No. L.S. 4450**COUNTY SURVEYOR'S STATEMENT**This Corner Record was received June 4, 2021and examined and filed June 22, 2021Signed James E. Hart P.L.S. or R.C.E. No. 8657Title County Surveyor**County Surveyor's Comment**

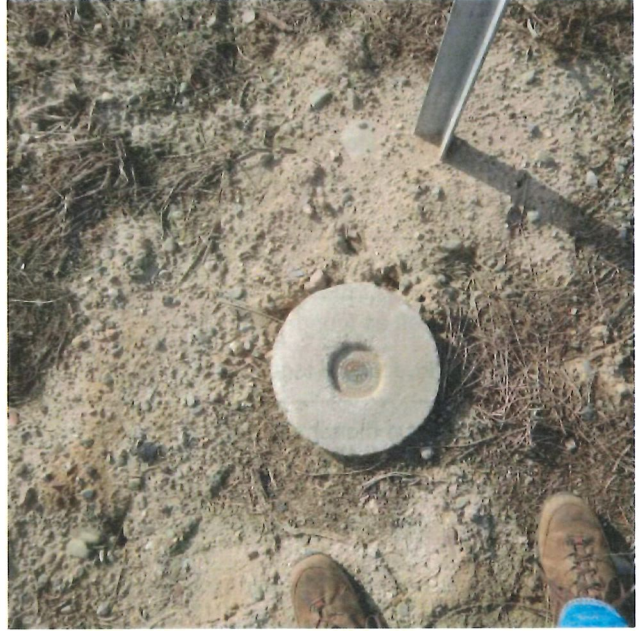

Southwest corner of the intersection of Airport Way and Mortensen Road