

# CORNER RECORD

Agency Index CR-20-113  
Document Number \_\_\_\_\_

City of MANTECA County of SAN JOAQUIN, California  
Brief Legal Description A portion of the south 1/2 of the southeast 1/4 of Section 5, T.2S., R.7E.

### CORNER TYPE

### COORDINATES (Optional)

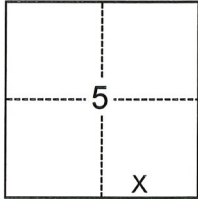

- Government Corner
- Meander
- Rancho
- Control
- Property
- Other

N. \_\_\_\_\_ E. \_\_\_\_\_  
 Elevation \_\_\_\_\_  
 Units  Metric  U.S. Survey Foot  
 Horizontal Datum \_\_\_\_\_  
 Zone \_\_\_\_\_ Epoch Date \_\_\_\_\_  
 Vertical Datum \_\_\_\_\_

Date of Survey January 30, 2020

- Complies with Public Resources Code §§8801-8819
- Complies with Public Resources Code §§8890-8902

SEC. 5  
T.2S., R.7E.

- PLS Act Ref.:  8765(d)  8771  8773  Other:
- Corner/Monument:  Left as found  Established  Rebuilt  Pre-Construction  
 Found and tagged  Reestablished  Referenced  Post-Construction

Narrative of corner identified and monument as found, set, reset, replaced, or removed:

See sheet #2 for description(s):

Referencing a 2" Brass Disk, stamped "CALIF. DEPT. OF TRANSPORTATION RM 249". Three reference marks, all being nail & brass washer stamped "RP LS 9313" were set to preserve monument location prior to construction. Found monument is on the existing shoulder of the eastbound lane of State Route 120 approximately 3280 feet east of Union Road. See sheet 2 for details.

### SURVEYOR'S STATEMENT

This Corner Record was prepared by me or under my direction in conformance with  
 the Professional Land Surveyors' Act on June 5, 2020  
 Signed [Signature] P.L.S. or R.C.E. No. 9313



### COUNTY SURVEYOR'S STATEMENT

This Corner Record was received June 15, 2020  
 and examined and filed July 2, 2020  
 Signed James E. Hart P.L.S. or R.C.E. No. 8657  
 Title County Surveyor



County Surveyor's Comment

**REFERENCE:**

(1) BOOK 28 OF RECORD OF SURVEYS AT PAGE 129,  
SAN JOAQUIN COUNTY RECORDS

**STATE ROUTE 120**

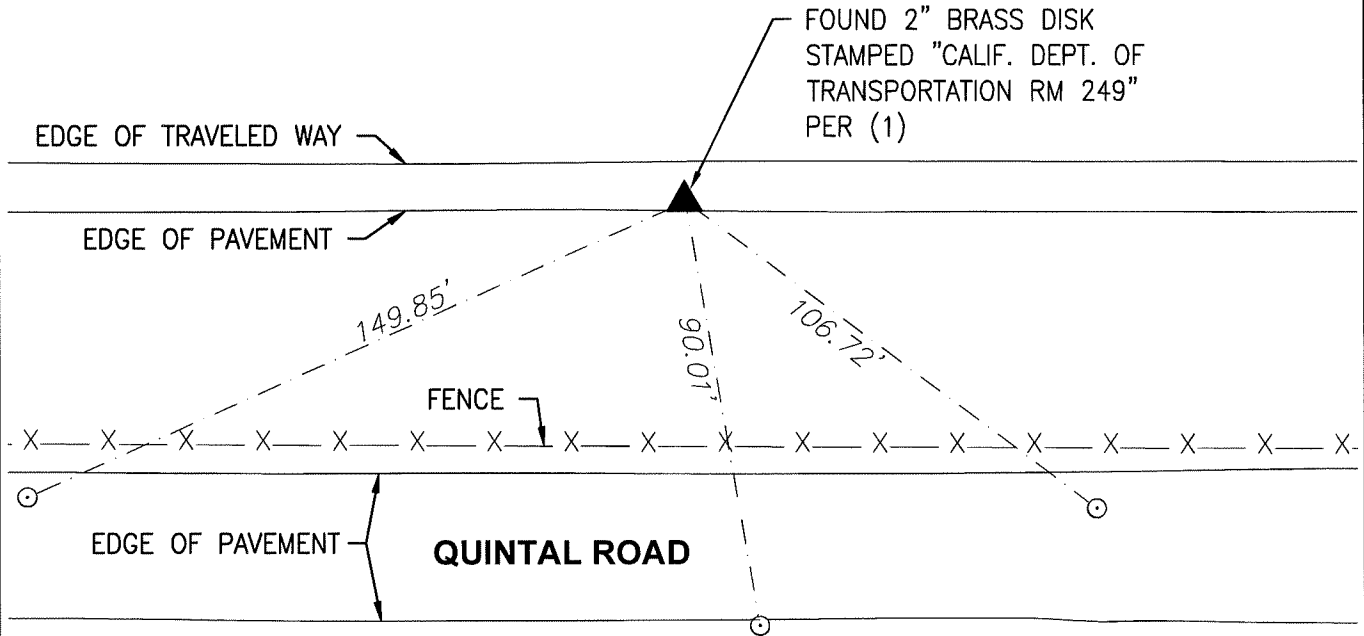

**VICINITY MAP**

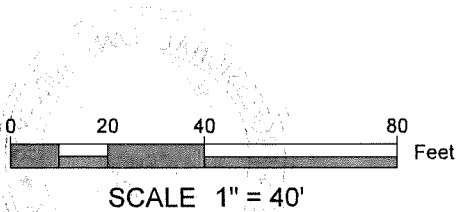
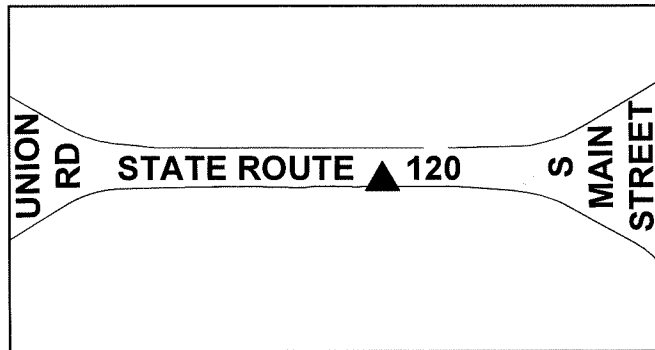

**MONUMENT NOTES**

- ▲ FOUND MONUMENT (AS NOTED)
- ⊙ SET NAIL & WASHER STAMPED "RP LS 9313"

THE PURPOSE OF THIS RECORD IS TO DOCUMENT THE PERPETUATION OF FOUND MONUMENT(S) PURSUANT TO THE PLS ACT SECTION 8771.

