

CORNER RECORD

Agency Index CR-20-110
Document Number _____

City of MANTECA County of SAN JOAQUIN, California
Brief Legal Description A portion of the south 1/2 of the southeast 1/4 of section 6, T.2S., R7E.

CORNER TYPE

COORDINATES (Optional)

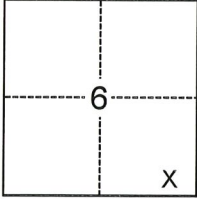

Sec. 6

T.2S., R.7E.

- Government Corner Control
 Meander Property
 Rancho Other

Date of Survey January 30, 2020

N. _____ E. _____

Elevation _____

Units Metric U.S. Survey Foot

Horizontal Datum _____

Zone _____ Epoch Date _____

Vertical Datum _____

Complies with Public Resources Code §§8801-8819

Complies with Public Resources Code §§8890-8902

PLS Act Ref.: 8765(d) 8771 8773 Other:

Corner/
Monument: Left as found Established Rebuilt Pre-Construction

Found and tagged Reestablished Referenced Post-Construction

Narrative of corner identified and monument as found, set, reset, replaced, or removed:

See sheet #2 for description(s):

Referencing a 2" Brass Disk, stamped "CALIF. DEPT. OF TRANSPORTATION RM 208". Referenced by a nail & shiner placed at the east face of an existing power pole, a nail and washer stamped "RP LS 9313", and by two 1/2" rebar with aluminum cap stamped "RP LS 9313" set to preserve monument location prior to construction. Found monument is on the existing shoulder of the eastbound lane of State Route 120, approximately 830 feet west of Union Road. See sheet 2 for details.

SURVEYOR'S STATEMENT

This Corner Record was prepared by me or under my direction in conformance with the Professional Land Surveyors' Act on June 5, 2020

Signed [Signature] P.L.S. or R.C.E. No. 9313

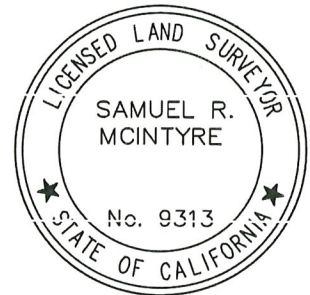

COUNTY SURVEYOR'S STATEMENT

This Corner Record was received June 15, 2020

and examined and filed July 2, 2020

Signed [Signature] P.L.S. or R.C.E. No. 8657

Title County Surveyor

County Surveyor's Comment



REFERENCE:

- (1) BOOK 28 OF RECORD OF SURVEYS AT PAGE 129,
SAN JOAQUIN COUNTY RECORDS

STATE ROUTE 120

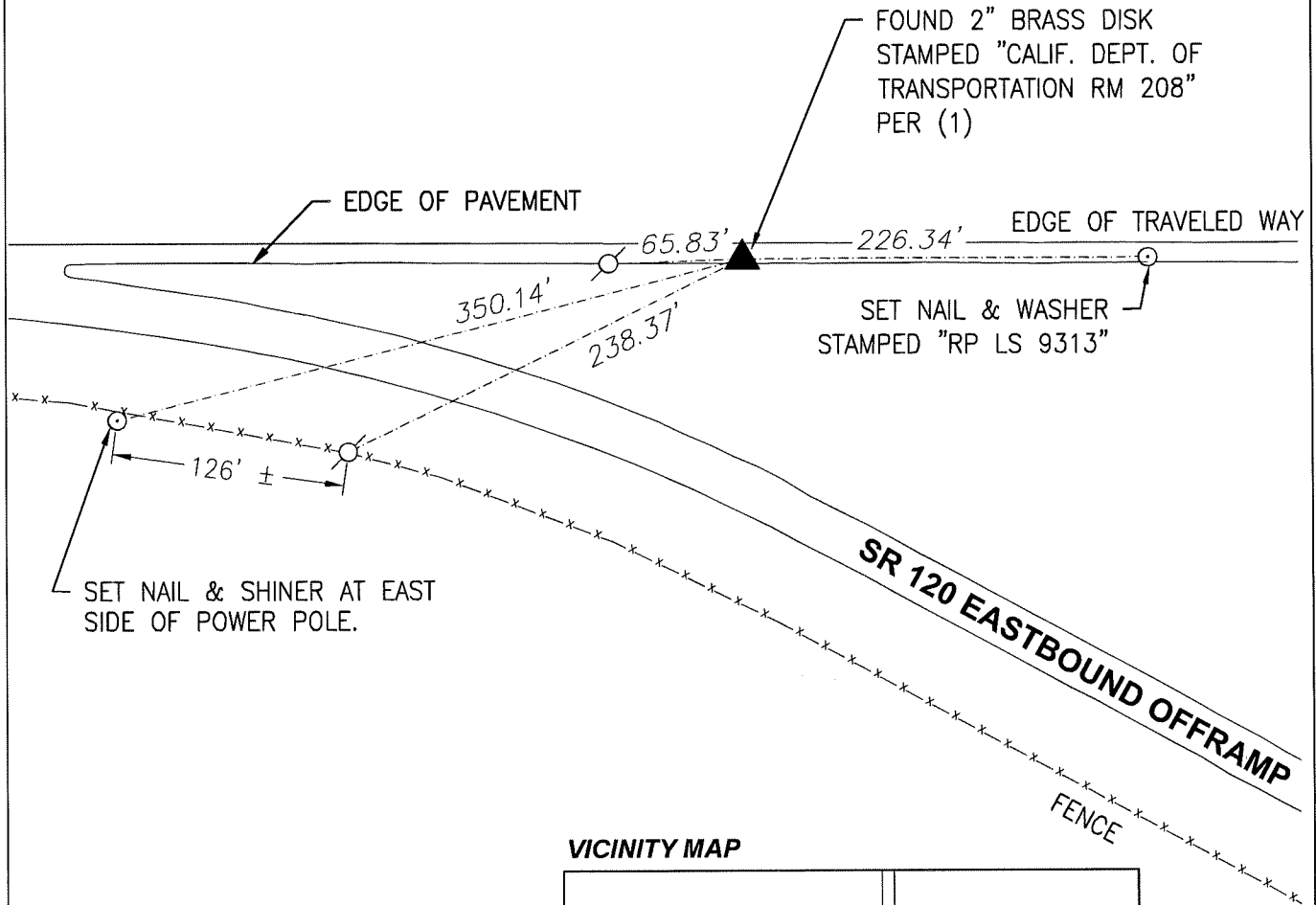

VICINITY MAP

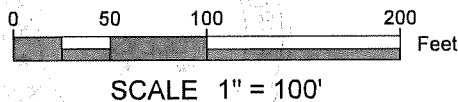
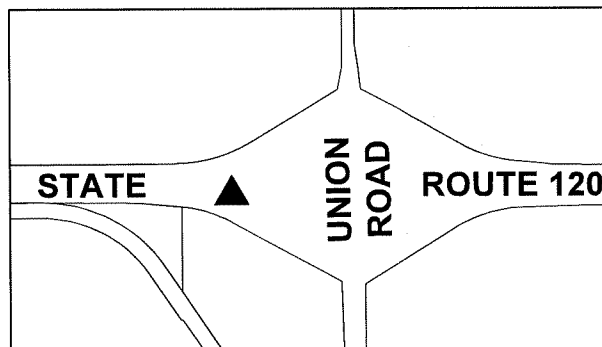

MONUMENT NOTES

- ▲ FOUND MONUMENT (AS NOTED)
- ⊙ SET MONUMENT (AS NOTED)
- ⊗ SET REBAR WITH ALUMINUM CAP STAMPED "RP LS 9313"

THE PURPOSE OF THIS RECORD IS TO DOCUMENT THE PERPETUATION OF FOUND MONUMENT(S) PURSUANT TO THE PLS ACT SECTION 8771.