

# CORNER RECORD

Agency Index CR-20-108

Document Number \_\_\_\_\_

City of MANTECA County of SAN JOAQUIN, California

Brief Legal Description A portion of the south 1/2 of the southwest 1/4 of Section 6, T.2S., R.7E.

### CORNER TYPE

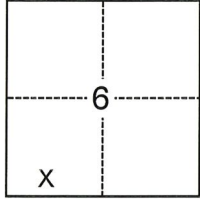

- Government Corner     Control  
 Meander                     Property  
 Rancho                          Other

Date of Survey January 30, 2020

Sec. 6  
T.2S., R.7E.

### COORDINATES (Optional)

N. \_\_\_\_\_ E. \_\_\_\_\_

Elevation \_\_\_\_\_

Units  Metric  U.S. Survey Foot

Horizontal Datum \_\_\_\_\_

Zone \_\_\_\_\_ Epoch Date \_\_\_\_\_

Vertical Datum \_\_\_\_\_

Complies with Public Resources Code §§8801-8819

Complies with Public Resources Code §§8890-8902

PLS Act Ref.:  8765(d)     8771     8773     Other:

Corner/  
Monument:  Left as found     Established     Rebuilt     Pre-Construction

Found and tagged     Reestablished     Referenced     Post-Construction

Narrative of corner identified and monument as found, set, reset, replaced, or removed:

See sheet #2 for description(s):

Referencing a 2" Brass Disk, stamped "CALIF. DEPT. OF TRANSPORTATION RM 184". Three reference marks, all being nail & 13/16" brass tags stamped "RP LS 9313" were set to preserve monument location prior to construction. Found monument is on the existing shoulder of the eastbound lane of State Route 120, approximately 3200 feet west of Union Road. See sheet 2 for details.

### SURVEYOR'S STATEMENT

This Corner Record was prepared by me or under my direction in conformance with the Professional Land Surveyors' Act on June 5, 2020

Signed [Signature] P.L.S. or R.C.E. No. 9313



### COUNTY SURVEYOR'S STATEMENT

This Corner Record was received June 15, 2020

and examined and filed July 2, 2020

Signed [Signature] P.L.S. or R.C.E. No. 8657

Title County Surveyor

County Surveyor's Comment



**REFERENCE:**

(1) BOOK 28 OF RECORD OF SURVEYS AT PAGE 129,  
SAN JOAQUIN COUNTY RECORDS

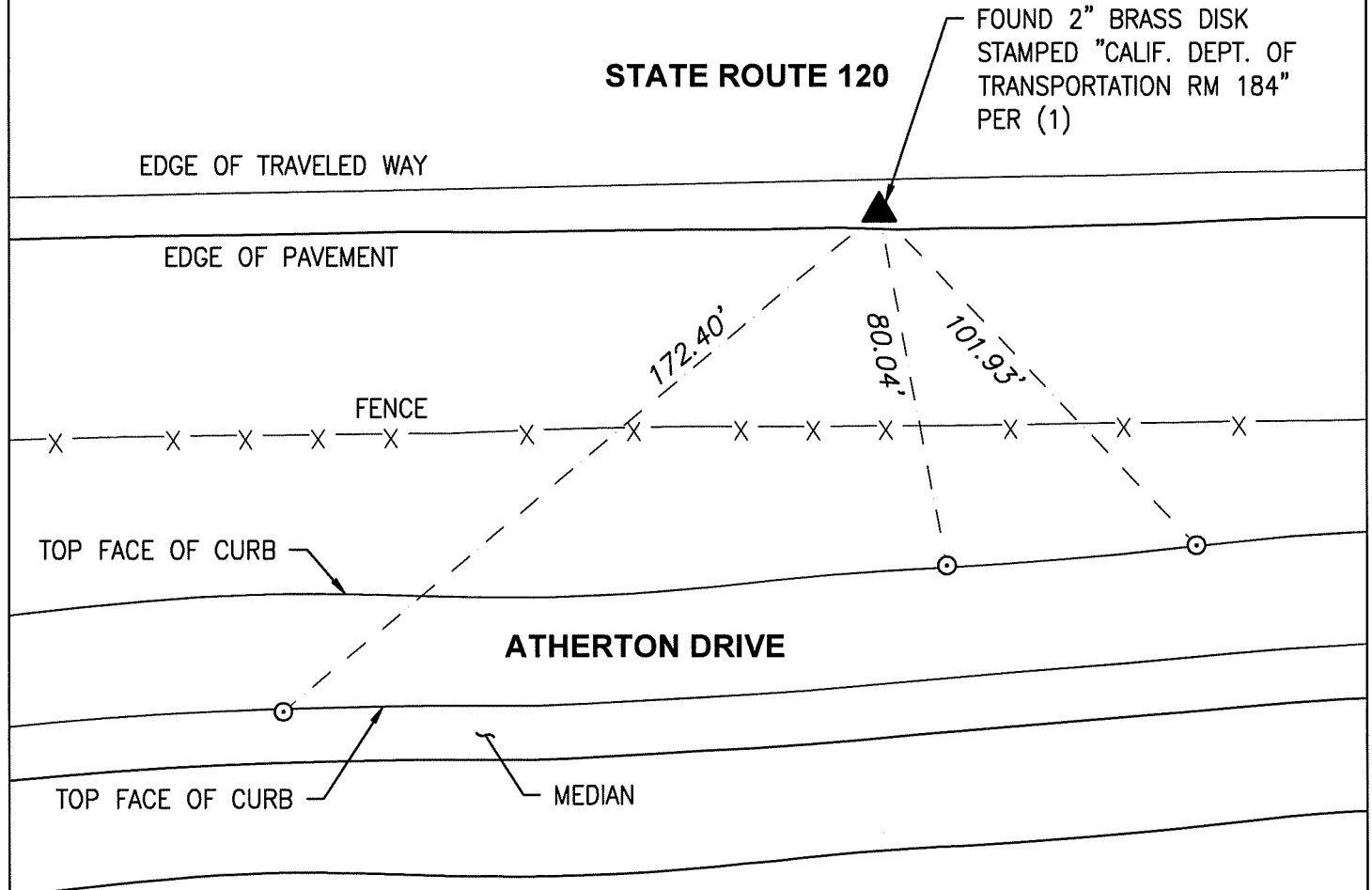

**VICINITY MAP**

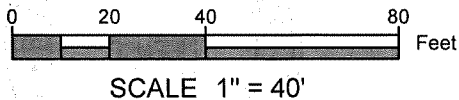
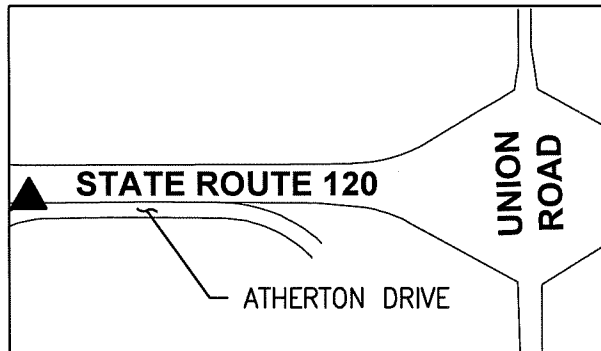

**MONUMENT NOTES**

▲ FOUND MONUMENT (AS NOTED)

⊙ SET NAIL & 13/16" TAG STAMPED "RP LS 9313" ON TOP OF CURB



THE PURPOSE OF THIS RECORD IS TO DOCUMENT THE PERPETUATION OF FOUND MONUMENT(S) PURSUANT TO THE PLS ACT SECTION 8771.