

CORNER RECORD

Agency Index CR-20-100

Document Number _____

City of UNINCORPORATED AREA

County of SAN JOAQUIN, California

Brief Legal Description MONUMENT ON NORTHWESTERLY LINE OF LOT 1, 22-M&P-78, S.J.C.R.

CORNER TYPE

COORDINATES (Optional)

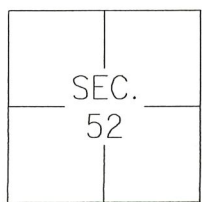

- Government Corner Control
- Meander Property
- Rancho Other

N. _____ E. _____
 Elevation _____
 Units Metric U.S. Survey Foot
 Horizontal Datum _____
 Zone _____ Epoch Date _____
 Vertical Datum: _____
 Complies with Public Resources Code §§8801-8819
 Complies with Public Resources Code §§8890-8902

Date of Survey JANUARY 17, 2020

PLS Act Ref.: 8765(d) 8771 8773

Other: _____

Corner/Monument: Left as found Established Rebuilt Pre-Construction
 Found and tagged Reestablished Referenced Post-Construction

Narrative of corner identified and monument as found, set, reset, replaced, or removed:
 See sheet #2 for description(s):

SURVEYOR'S STATEMENT

This Corner Record was prepared by me or under my direction in conformance with the Professional Land Surveyor's Act on MAY 7TH, 2020.

Signed [Signature] P.L.S. or R.C.E. No.: 8366



COUNTY SURVEYOR'S STATEMENT

This Corner Record was received May 18, 2020 and examined and filed June 4, 2020.

Signed James E. Hart P.L.S. or R.C.E. No.: 8657
 Title County Surveyor



County Surveyor's Comment _____

