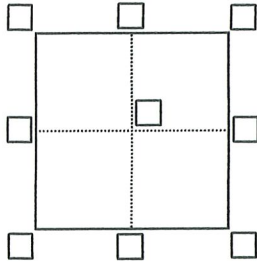

CORNER RECORD

Agency Index CR-20-58

Document Number _____

City of Unincorporated Area County of San Joaquin, CaliforniaBrief Legal Description The westerly line of Parcel B, 7 P.M. 175**CORNER TYPE**

Government Corner Control
 Meander Property
 Rancho Other

Date of Survey 01/17/2020**COORDINATES (Optional)**

N. _____ E. _____

Elevation _____

Units Metric U.S. Survey Foot

Horizontal Datum _____

Zone _____ Epoch Date _____

Vertical Datum _____

 Complies with Public Resources Code §§8801-8819 Complies with Public Resources Code §§8890-8902PLS Act Ref.: 8765(d) 8771 8773 8772

Corner / Monument: Left as found Established Rebuilt Pre-Construction
 Found and tagged Reestablished Referenced Post-Construction

Narrative of corner identified and monument as found, set, reset, replaced, or removed:

 See sheet #2 for description(s):

Found all four (4) survey monuments marking the exterior boundary of Parcel B, of Parcel Map 7 P.M. 175. All four (4) monuments being the same character as shown on Corner Record CR-19-98 as filed August 23rd, 2019, said monuments being 3/4" iron pipe with a 1" brass tag embossed "RW Snow LS8813". Set four (4), 5/8" diameter by two foot long rebar with a 1" brass tag embossed "RW Snow LS8813", intermittently along the westerly line of said Parcel B.

SURVEYOR'S STATEMENTThis Corner Record was prepared by me or under my direction in conformance with the Professional Land Surveyors' Act on February 24, 2020Signed Robert W. Snow P.L.S. or R.C.E. No. L8813**COUNTY SURVEYOR'S STATEMENT**This Corner Record was received February 28, 2020 and examined and filed March 13, 2020.Signed James E. Hart P.L.S. or R.C.E. No. 8657
James E. HartTitle County Surveyor

County Surveyor's Comment _____



CORNER RECORD

— for —
THE WESTERLY LINE OF
PARCEL B, 7 P.M. 175, S.J.C.R.

LEGEND:

- DIMENSION POINT, SEARCHED FOR NOTHING FOUND, NOTHING SET
- FOUND MONUMENT AS NOTED
- FOUND 3/4" IRON PIPE PER(1) & (2)
- SET 5/8" x 2' REBAR TAGGED "RW SNOW 8813"
- * CALCULATED DIMENSION
- ⊕ STREET CENTERLINE PER 7 P.M. 175
- () RECORD DATA PER NOTED REFERENCE
- O.A. OVERALL DIMENSION
- P.M. PARCEL MAP, S.J.C.R.
- S.J.C.R. SAN JOAQUIN COUNTY RECORDS
- S.J.C.S.R. SAN JOAQUIN COUNTY SURVEYOR'S RECORDS
- M MEASURED

REFERENCES:

- (1) 7 P.M. 175
- (2) CR-19-98

FOUND 3/4" IRON PIPE WITH 1" BRASS TAG EMBOSSED "RW SNOW LS8813" PER(2) 1.5' BELOW SURFACE

FOUND 3/4" IRON PIPE WITH 1" BRASS TAG EMBOSSED "RW SNOW LS8813" PER(2)

FOUND 3/4" IRON PIPE WITH 1" BRASS TAG EMBOSSED "RW SNOW LS8813" PER(2)

FOUND 3/4" IRON PIPE WITH 1" BRASS TAG EMBOSSED "RW SNOW LS8813" PER(2)

FOUND 3/4" IRON PIPE W/ PLASTIC PLUG EMBOSSED "LS4124", IN MONUMENT BOX PER CORNER RECORD 12-508, S.J.C.S.R.

UNION PACIFIC RAILROAD COMPANY (1)

PARCEL A
7 P.M. 175

PARCEL B
7 P.M. 175

BASIS OF BEARINGS
S00°21'W 438.75'(1)
S00°21'00"W 438.81' M(2)

ROAD

SACRAMENTO

COLLIER ROAD



SCALE: 1"=150'

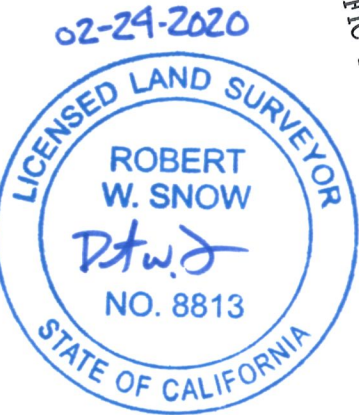

BASIS OF BEARINGS:

THE BASIS OF BEARINGS OF THIS SURVEY IS THE NORTHERLY END OF THE EASTERLY LINE OF PARCEL B, 7 P.M. 175, BEING S00°21'W, AS ESTABLISHED FROM FOUND ORIGINAL MONUMENTS AS SHOWN HEREON.

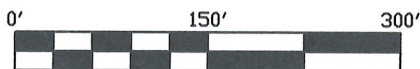

S89°20'E 499.75'(1)
S89°18'48"E 499.74' M(2)

N89°20'00"W 40.06' M(2)
N89°20'W 40.00'(1)

S00°21'W 531.26'(1)
S00°21'00"W 531.27' M(2)

89°41' M
89°41' (1,2)

91.46'

148.94'

178.33'

S14°59'44"E
S15°00'E

943.63' O.A. M(2)
943.56'(1) O.A.

233.79'

291.13'

R=563.80' M(2)
Δ=56°09'58" M(2)
CHB: N28°26'50"E, M(2)
CHD: 530.82' M(2)

R=563.80'(1)
Δ=56°10'36"(1)
CHB: N28°26'18"E (1)
CHD: 530.91'(1)