

CORNER RECORD

Agency Index CR-20-45

Document Number _____

City of STOCKTON

County of SAN JOAQUIN, California

Brief Legal Description FOUND MONUMENTS ON EAST MAIN STREET PER 39-S-87, S.J.C.R.

CORNER TYPE		COORDINATES (Optional)	
Government Corner	<input type="checkbox"/>	Control	<input type="checkbox"/>
Meander	<input type="checkbox"/>	Property	<input type="checkbox"/>
Rancho	<input type="checkbox"/>	Other	<input checked="" type="checkbox"/>
Date of Survey <u>OCTOBER 23, 2019</u>		N. _____	E. _____
		Elevation _____	
		Units Metric <input type="checkbox"/> U.S. Survey Foot <input type="checkbox"/>	
		Horizontal Datum _____	
		Zone _____ Epoch Date _____	
		Vertical Datum: _____	
		<input type="checkbox"/> Complies with Public Resources Code §§8801-8819	
		<input type="checkbox"/> Complies with Public Resources Code §§8890-8902	

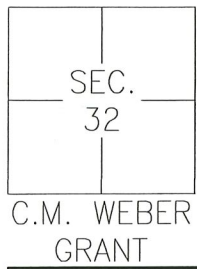

PLS Act Ref.: 8765(d) 8771 8773 Other: _____

Corner/Monument: Left as found Established Rebuilt Pre-Construction
 Found and tagged Reestablished Referenced Post-Construction

Narrative of corner identified and monument as found, set, reset, replaced, or removed:
 See sheet #2 for description(s):

SURVEYOR'S STATEMENT

This Corner Record was prepared by me or under my direction in conformance with the Professional Land Surveyor's Act on JANUARY 29TH, 2020

Signed [Signature] P.L.S. or R.C.E. No.: 8366



COUNTY SURVEYOR'S STATEMENT

This Corner Record was received February 5, 2020 and examined and filed February 27, 2020

Signed James E. Hart P.L.S. or R.C.E. No.: 8657
Title County Surveyor



County Surveyor's Comment _____

