

CORNER RECORD

Agency Index CR-19-57
 Document Number _____

City of _____ County of SAN JOAQUIN, California
 Brief Legal Description SAN JOAQUIN CO. BENCHMARK LOCATED AT W. KILE ROAD AND UPRR

CORNER TYPE		COORDINATES (Optional)	
<input type="checkbox"/>	Government Corner	<input type="checkbox"/>	N. _____ E. _____
<input type="checkbox"/>	Meander	<input type="checkbox"/>	Elevation _____
<input type="checkbox"/>	Rancho	<input type="checkbox"/>	Units Metric <input type="checkbox"/> U.S. Survey Foot <input checked="" type="checkbox"/>
<input type="checkbox"/>	Control	<input checked="" type="checkbox"/>	Horizontal Datum _____
<input type="checkbox"/>	Property	_____	Zone _____ Epoch Date _____
<input type="checkbox"/>	Other	<input checked="" type="checkbox"/>	Vertical Datum _____
Date of Survey <u>April 9, 2019</u>		<input type="checkbox"/> Complies with Public Resources Code §§8801-8819	
		<input type="checkbox"/> Complies with Public Resources Code §§8890-8902	

PLS Act Ref.:	<input type="checkbox"/> 8765(d)	<input type="checkbox"/> 8771	<input checked="" type="checkbox"/> 8773	<input type="checkbox"/> Other:
Corner/ Monument:	<input type="checkbox"/> Left as found	<input type="checkbox"/> Established	<input type="checkbox"/> Rebuilt	<input type="checkbox"/> Pre-Construction
	<input type="checkbox"/> Found and tagged	<input checked="" type="checkbox"/> Reestablished	<input type="checkbox"/> Referenced	<input checked="" type="checkbox"/> Post-Construction

Narrative of corner identified and monument as found, set, reset, replaced, or removed:
 See sheet #2 for description(s):

IN COMPLIANCE WITH SECTION 8773 OF THE PROFESSIONAL LAND SURVEYORS ACT, THIS CORNER RECORD IS BEING FILED TO REESTABLISH THE VERTICAL BENCHMARK.

SURVEYOR'S STATEMENT

This Corner Record was prepared by me or under my direction in conformance with
 the Professional Land Surveyors' Act on May 20, 2019
 Signed William Douglas Crume P.L.S. or R.C.E. No. LS 7059



COUNTY SURVEYOR'S STATEMENT

This Corner Record was received May 22, 2019
 and examined and filed June 4, 2019
 Signed James E. Hart P.L.S. or R.C.E. No. 8657
 Title County Surveyor



County Surveyor's Comment

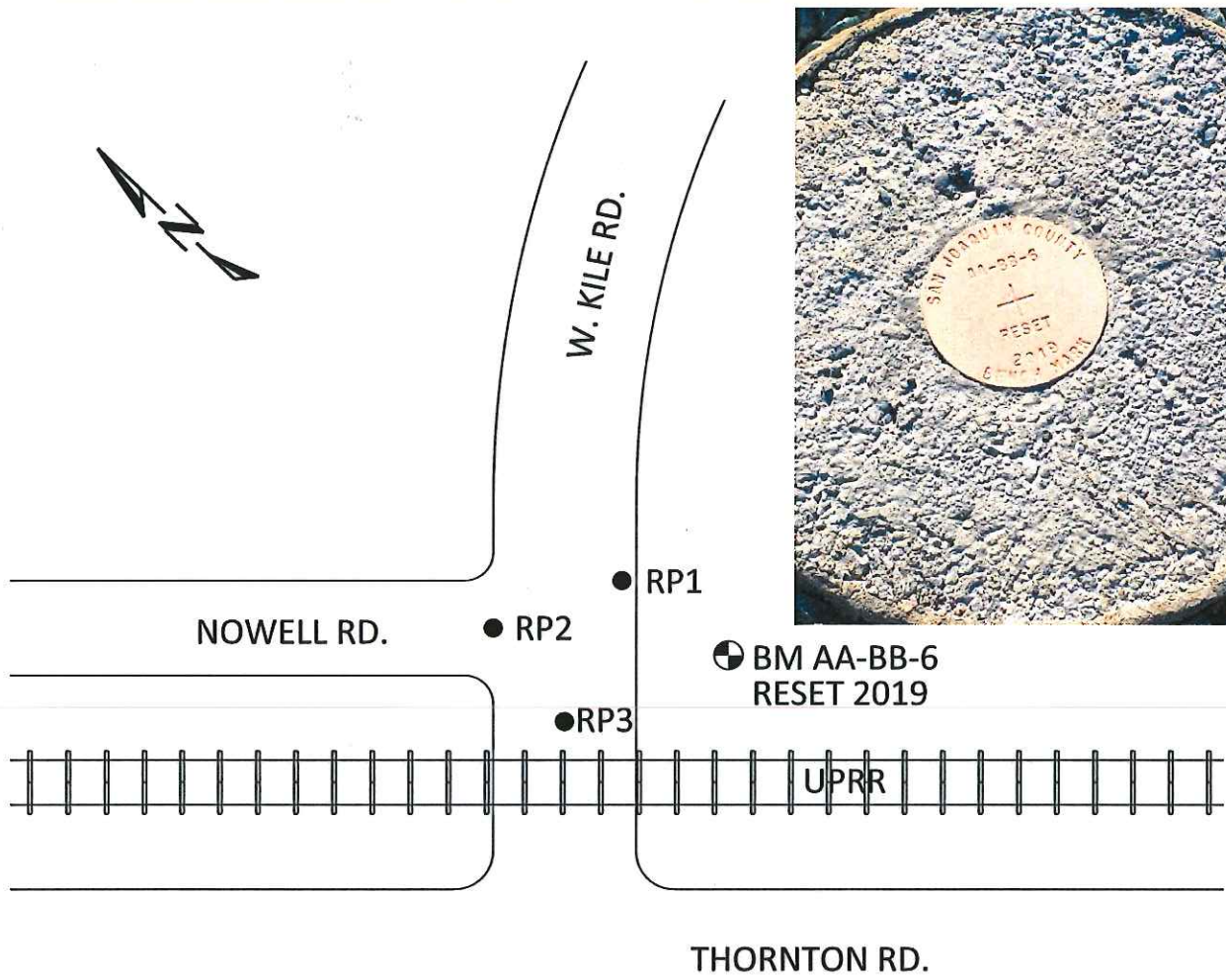

CR=CORNER RECORD

PT	BS	HI	FS	ELEV	COMMENTS
RP1	2.686			14.404	FROM CR 18-83
		17.090			
BM RESET	8.614		8.209	8.8809	
		17.4951			
RP1			3.0910	14.404	
RP2	1.2472			15.2450	FROM CR 18-83
		16.4922			
BM RESET	7.9899		7.6094	8.8828	
		16.8727			
RP2			1.6276	15.245	
RP3	1.6638			15.7840	FROM CR 18-83
		17.4478			
BM RESET	8.2293		8.5639	8.8839	
		17.1132			
RP3			1.3303	15.7829	
$8.8809 + 8.8828 + 8.8839 = 26.6476 / 3 = 8.8825$					∴ BM AA-BB-6 RESET 2019
					EL = 8.883 NGVD 1929