

CORNER RECORD

Agency Index: CR-19-15
Document Number: _____
County of SAN JOAQUIN, California

City of TRACY
Brief Legal Description MONUMENTS ON ELEVENTH STREET APPROXIMATELY 378'± WEST OF MACARTHUR DRIVE. LOCATED IN SECTIONS 22 AND 27, T.2S, R.5E, M.D.B.&M.

NW 1/4	NE 1/4
SW 1/4	SE 1/4

SEC. 22
T.2S, R.5E

CORNER TYPE

Government Corner Control
 Meander Property
 Rancho Other

Date of Survey 5-5-2018

COORDINATES (Optional)

N. _____ E. _____
 Elevation: _____
 Units Metric U.S. Survey Foot
 Horizontal Datum: NVGD88
 Zone: _____ Epoch Date: _____
 Vert. Datum: _____

Complies with Public Resources Code SS8801-8819
 Complies with Public Resources Code SS8890-8902

PLS Act Ref: 8765(d) 8771 8773 Other:

Corner/
 Monument: Left as found Established Rebuilt Pre-Construction
 Found and Tagged Reestablished Referenced Post-Construction

Narrative of corner identified and monument as found, set, reset, replaced, or removed:
 See sheet #2 for description(s):

SET MONUMENTS AS SHOWN ON PAGE 2.

MONUMENTS SET AS DESCRIBED ON PAGE 2.

SURVEYOR'S STATEMENT

This Corner Record was prepared by me or under my direction in conformance with the Land Surveyors' Act on OCTOBER 3, 2018,



Signed [Signature] P.L.S. or R.C.E. Number 6953

COUNTY SURVEYOR'S STATEMENT

This Corner Record was received January 24, 2019
and examined and filed February 8, 2019

Signed [Signature] P.L.S. or R.C.E. No: 8657
 Title Acting County Surveyor

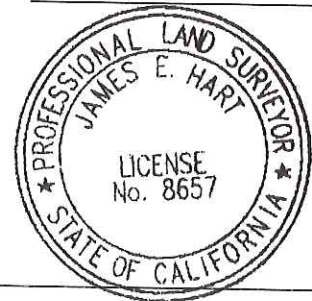

County Surveyor's Comment _____

LEGEND:

- ⊗ SET MONUMENT AS NOTED.
- FOUND MONUMENT AS NOTED.
- CR DENOTES CORNER RECORD
- (M) MEASURED DISTANCE. ALL DISTANCES ARE MEASURED UNLESS NOTED OTHERWISE.

S.J.C.S.R. SAN JOAQUIN COUNTY SURVEYOR'S RECORDS

X AND DISTANCE TABLE		
BS-@-FS	X	FS DISTANCE
B-A-B	00°00'00"	336.61'(M)
B-A-C	79°19'39"	141.66'(M)
B-A-D	79°19'39"	287.03'(M)
B-A-E	139°25'26"	243.62'(M)
B-A-F	299°51'46"	97.76'(M)

X AND DISTANCE TABLE		
BS-@-FS	X	FS DISTANCE
B-G-B	00°00'00"	338.34'(M)
B-G-F	44°58'44"	57.95'(M)
B-G-H	231°21'22"	149.81'(M)
B-G-I	231°21'22"	264.62'(M)

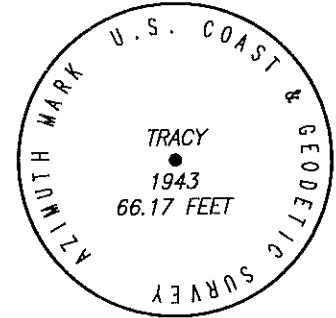
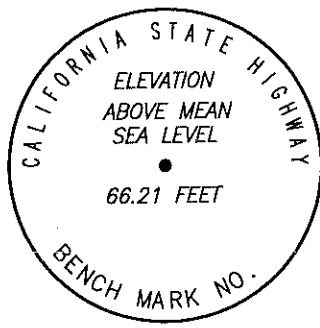
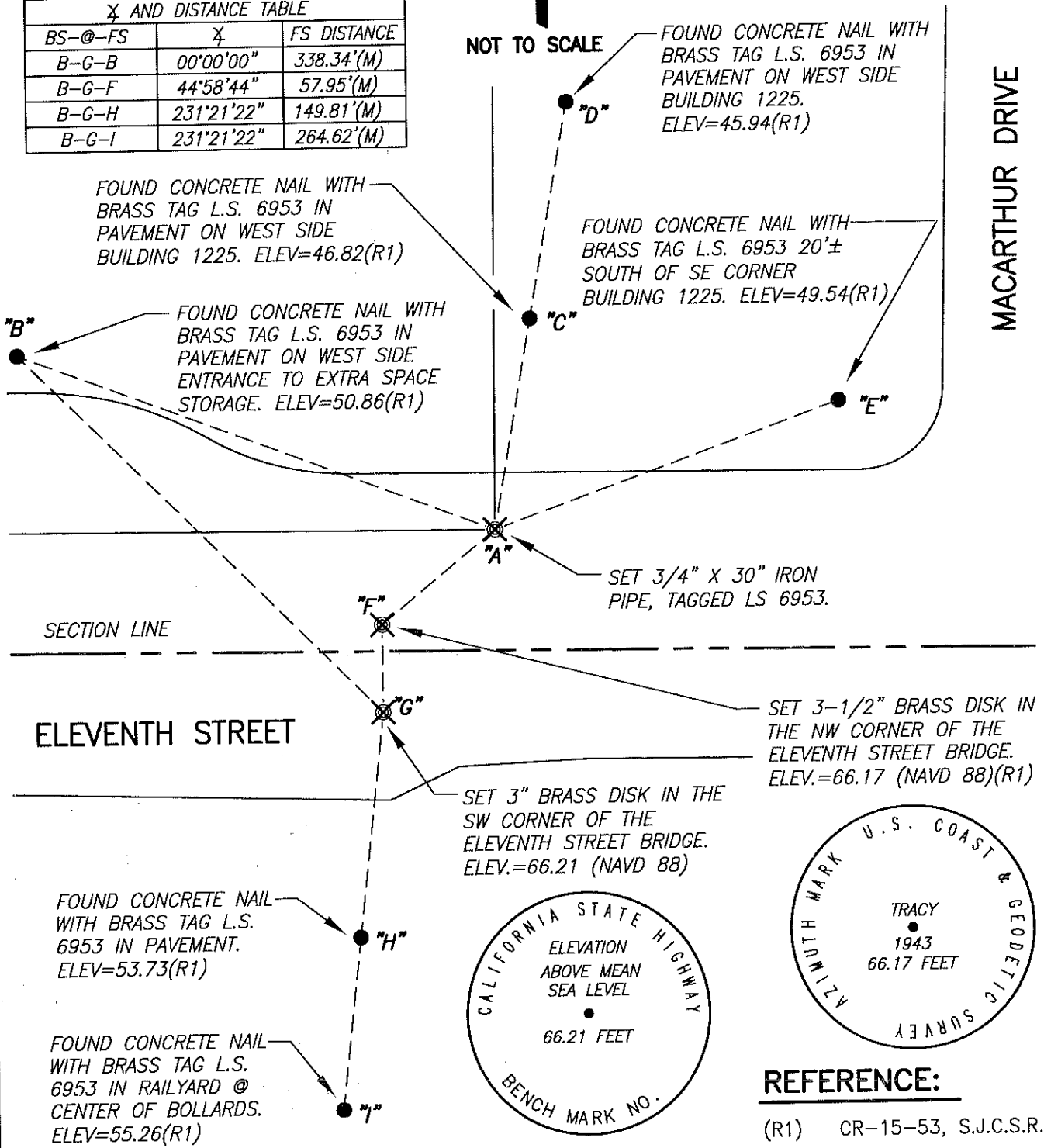

REFERENCE:

(R1) CR-15-53, S.J.C.S.R.