

CORNER RECORD

Agency Index: CR-18-178
 Document Number: _____
 County of SAN JOAQUIN, California

City of _____
 Brief Legal Description NORTHEAST CORNER OF SECTION 13, TOWNSHIP 1 NORTH, RANGE 7 EAST, M.D.M. AT THE INTERSECTION OF STATE HIGHWAY ROUTE 4 AT JACK TONE ROAD.

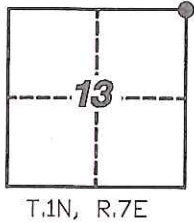

CORNER TYPE

- Government Corner Control
 Meander Property
 Rancho Other

Date of Survey 6-28-2018

COORDINATES (Optional)

N. _____ E. _____
 Elevation _____
 Units Metric U.S. Survey Foot
 Horizontal Datum _____
 Zone _____ Epoch Date _____
 Vertical Datum _____
 Complies with Public Resources Code SS8801-8819
 Complies with Public Resources Code SS8890-8902

PLS Act Ref: 8765(d) 8771 8773 Other:

Corner/
 Monument: Left as found Established Rebuilt Pre-Construction
 Found and Tagged Reestablished Referenced Post-Construction

Narrative of corner identified and monument as found, set, reset, replaced, or removed:

See sheet #2 for description(s):

RAILROAD SPIKE AS SHOWN ON 27-S-177, SAN JOAQUIN COUNTY RECORDS, WAS REMOVED DURING CONSTRUCTION. REESTABLISHED AND SET A 2" IRON PIPE WITH ALUMINUM CAP IN MONUMENT WELL, ALL AS SHOWN ON SHEET 2.

SURVEYOR'S STATEMENT

This Corner Record was prepared by me or under my direction in conformance with the Land Surveyors' Act on JULY 5, 2018,

Signed [Signature] P.L.S. or R.C.E. Number 6953



COUNTY SURVEYOR'S STATEMENT

This Corner Record was received November 26, 2018

and examined and filed November 26, 2018

Signed James E. Hart P.L.S. or R.C.E. No: 8657

Title Acting County Surveyor



County Surveyor's Comment _____

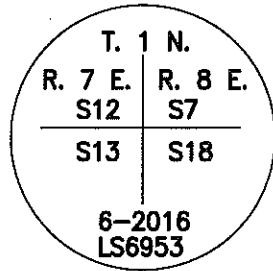

DETAIL 'A'

NOT TO SCALE

SET 2" IRON PIPE WITH ALUMINUM CAP IN MONUMENT WELL. SEE DETAIL "A" FOR STAMPING.

JACK TONE ROAD

FOUND 3/4" IRON PIN WITH 2-1/4" WASHER "STAMPED S.J. CO. LS 2239". (R1)

STATE HIGHWAY ROUTE 4

N 89°31'55" E 2641.12' GROUND(M)
N 89°31'49" E 2640.98' GRID(R1) 2641.16' GROUND(R1)

FOUND 1" IRON PIPE NOT TAGGED. (R1)

NOTE:

TO OBTAIN GROUND DISTANCES, DIVIDE THE GRID DISTANCE BY THE COMBINED GRID FACTOR. THE COMBINED GRID FACTOR USED IS 0.9999319 PER (R1).

REFERENCES:

- (R1) 27-S-177, S.J.C.R.
- (R2) 20-S-64, S.J.C.R.

LEGEND:

- ⊗ SET 2" X 24" IRON PIPE WITH ALUMINUM CAP STAMPED "LS6953"
- FOUND MONUMENT AS NOTED.
- S- RECORD OF SURVEY
- S.J.C.R. SAN JOAQUIN COUNTY RECORDS
- (M) MEASURED DISTANCE. ALL DISTANCES ARE MEASURED UNLESS NOTED OTHERWISE.

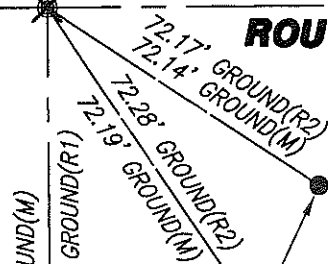

FOUND 1" IRON PIN NOT TAGGED. (R2)

S 00°32'37" E 2646.10' GROUND(M)
S 00°32'32" E 2645.91' GRID(R1) 2646.09' GROUND(R1)

FOUND 1" IRON PIN WITH 2-1/4" WASHER. (R1)

NOTE:

THIS CORNER RECORD DOES NOT VERIFY THIS MONUMENT TO BE IN THE CORRECT POSITION.