

CORNER RECORD

Agency Index CR-18-61

Document Number _____

City of _____ County of San Joaquin, California

Brief Legal Description 1/4 Sec. Cor. of Sec. 8 and 9, T.3N., R.8E., M.D.B.&M.

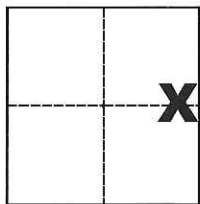

CORNER TYPE

Government Corner Control
Meander Property
Rancho Other

Date of Survey October 17, 2017

COORDINATES (Optional)

N. _____ E. _____

Elevation _____

Units Metric U.S. Survey Foot

Horizontal Datum _____

Zone _____ Epoch Date _____

Vertical Datum _____

Complies with Public Resources Code §§8801-8819

Complies with Public Resources Code §§8890-8902

Sec. 8 and 9, T.3N., R.8E.,
M.D.B. & M.

PLS Act Ref.: 8765(d) 8771 8773 Other:

Corner/Monument: Left as found Established Rebuilt Pre-Construction

Found and tagged Reestablished Referenced Post-Construction

Narrative of corner identified and monument as found, set, reset, replaced, or removed:

See sheet #2 for description(s):

SURVEYOR'S STATEMENT

This Corner Record was prepared by me or under my direction in conformance with

the Professional Land Surveyors' Act on JAN. 4, 2018

Signed Michael L. Quantarel P.L.S. or R.C.E. No. L.S. 4450



COUNTY SURVEYOR'S STATEMENT

This Corner Record was received January 4, 2018

and examined and filed March 13, 2018

Signed Warren D. Smith P.L.S. or R.C.E. No. 4842

Title County Surveyor

County Surveyor's Comment



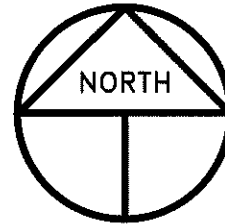

NOT TO SCALE
2016-126

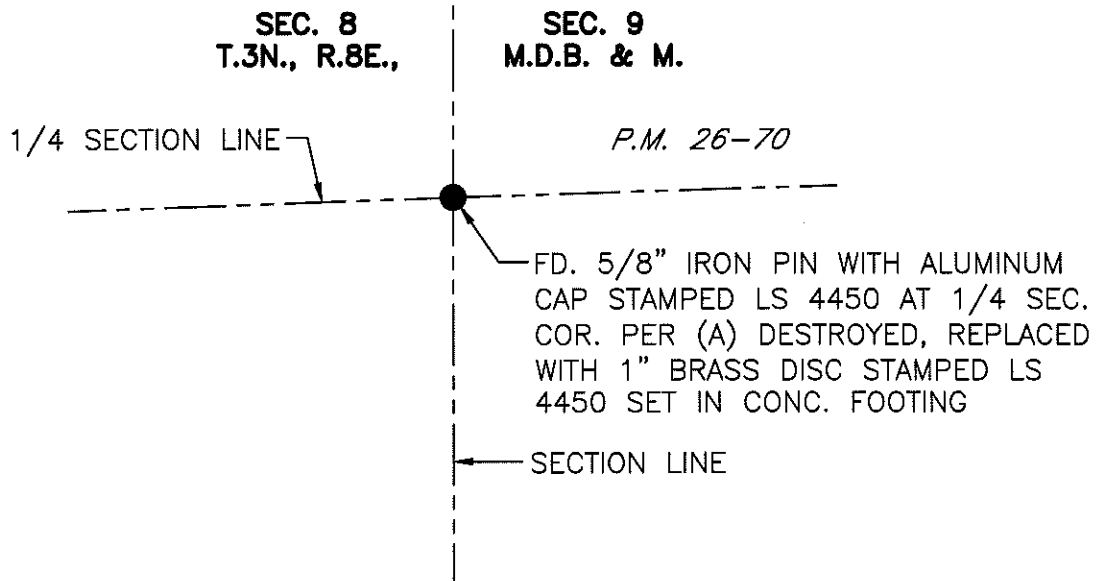

REFERENCE

(A) P.M. 26-70, S.J.C.R.

LEGEND

- INDICATES FOUND MONUMENT AS NOTED
- P.M. INDICATES PARCEL MAP, BOOK AND PAGE, S.J.C.R.
- S.J.C.R. INDICATES SAN JOAQUIN COUNTY RECORDS