

# CORNER RECORD

Agency Index CR-17-332  
Document Number \_\_\_\_\_

City of Lodi County of San Joaquin, California  
Brief Legal Description Church Street and Walnut Avenue, within Southwest Quarter of Section 1, T3N, R6E

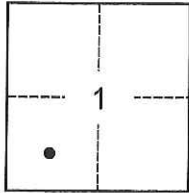

### CORNER TYPE

- Government Corner  Control
- Meander  Property
- Rancho  Other

Date of Survey October 13, 2017

### COORDINATES (Optional)

N. \_\_\_\_\_ E. \_\_\_\_\_

Elevation \_\_\_\_\_

Units Metric  U.S. Survey Foot

Horizontal Datum \_\_\_\_\_

Zone \_\_\_\_\_ Epoch Date \_\_\_\_\_

Vertical Datum \_\_\_\_\_

Complies with Public Resources Code §§8801-8819

Complies with Public Resources Code §§8890-8902

PLS Act Ref.:  8765(d)  8771  8773  Other:

Corner/Monument:  Left as found  Established  Rebuilt  Pre-Construction  
 Found and tagged  Reestablished  Referenced  Post-Construction

Narrative of corner identified and monument as found, set, reset, replaced, or removed:

See sheet #2 for description(s):

Is the purpose of this corner record to establish ties to an existing monument prior to construction. See sketch on backside for the monument found and tied out.

### SURVEYOR'S STATEMENT

This Corner Record was prepared by me or under my direction in conformance with

the Professional Land Surveyors' Act on October 13, 2017

Signed [Signature]  P.L.S. or ~~R.C.E.~~ No. 7889



### COUNTY SURVEYOR'S STATEMENT

This Corner Record was received November 1, 2017

and examined and filed November 7, 2017

Signed [Signature] P.L.S. or R.C.E. No. 4842

Title County Surveyor

County Surveyor's Comment



S:\Projects\2016\1602A\3\_Drawings\1602A Church-Walnut.dwg 10/14/17 1:56pm -XLSXW-1602A-1602A-0001.dwg

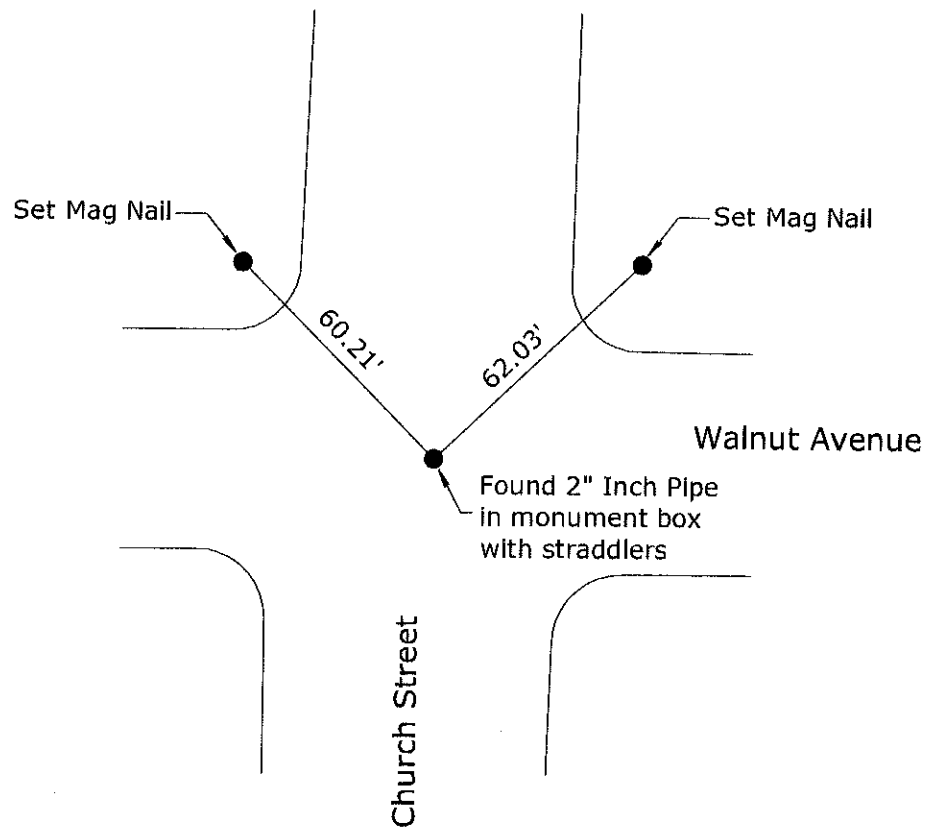

- Notes:
1. Monuments are not tagged unless noted.
  2. No attempt was made to verify the monument(s)

PREPARED IN THE OFFICE OF:

**BAUMBACH & PIAZZA, INC.**

CIVIL ENGINEERS • SURVEYORS

www.bpengineers.net  
209.368.6618

323 W. Elm St.  
Lodi, CA 95240