

CORNER RECORD

Agency Index CR-17-288
 Document Number _____

City of _____ County of San Joaquin, California
 Brief Legal Description Jahant Road @ Sowles Road

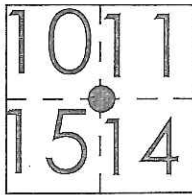

CORNER TYPE		COORDINATES (Optional)	
Government Corner	<input checked="" type="checkbox"/> Control	N. _____	E. _____
Meander	<input type="checkbox"/> Property	Elevation. _____	
Rancho	<input type="checkbox"/> Other	Units Metric <input type="checkbox"/> U.S. Survey Foot <input checked="" type="checkbox"/>	
Date of Survey	<u>July 31, 2017</u>	Horizontal Datum _____	
		Zone _____ Epoch Date _____	
		Vertical Datum _____	
		<input type="checkbox"/> Complies with Public Resources Code §§8801-8819	
		<input type="checkbox"/> Complies with Public Resources Code §§8890-8902	

PLS Act Ref.:	<input type="checkbox"/> 8765(d)	<input checked="" type="checkbox"/> 8771	<input type="checkbox"/> 8773	<input type="checkbox"/> Other:
Corner/Monument:	<input checked="" type="checkbox"/> Left as found	<input type="checkbox"/> Established	<input type="checkbox"/> Rebuilt	<input checked="" type="checkbox"/> Pre-Construction
	<input type="checkbox"/> Found and tagged	<input type="checkbox"/> Reestablished	<input type="checkbox"/> Referenced	<input type="checkbox"/> Post-Construction

Narrative of corner identified and monument as found, set, reset, replaced, or removed:
 See sheet #2 for description(s):

SURVEYOR'S STATEMENT

This Corner Record was prepared by me or under my direction in conformance with the Professional Land Surveyor's Act on September 05, 2017
 Signed James E. Hart P.L.S. or R.C.E. No. 8657



COUNTY SURVEYOR'S STATEMENT

This Corner Record was received September 11, 2017
 and examined and filed October 4, 2017
 Signed Warren D. Smith P.L.S. or R.C.E. No. 4842
 Title _____ County Surveyor



County Surveyor's Comment

N.T.S.

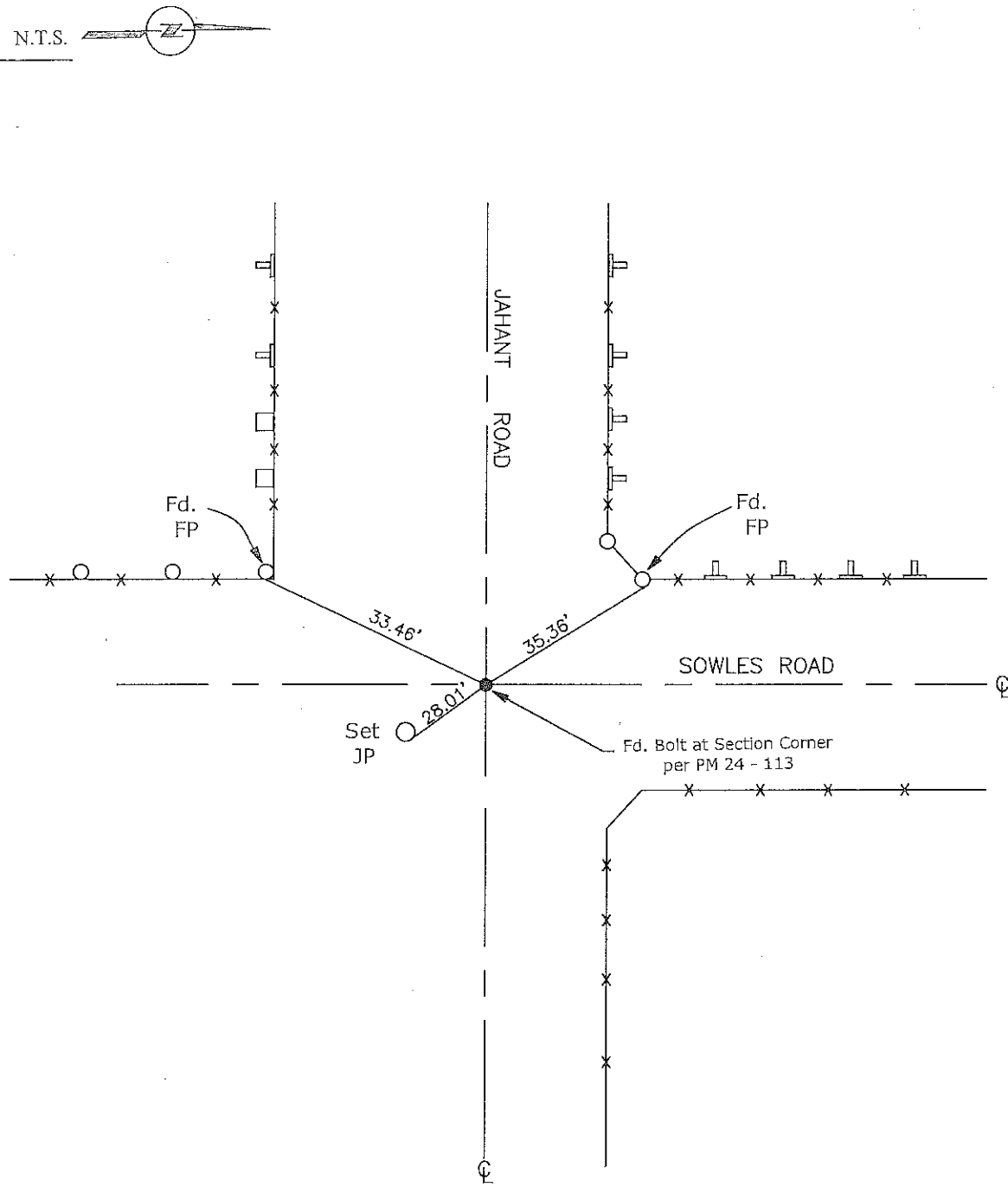

- CR=Corner Record
- FP=Fence Post
- JP=Joint Pole
- LP=Light Pole
- PP=Power Pole
- GP=Guy Pole
- SP=Service Pole
- TP=Telephone Pole
- S.F.N.=Searched Found Nothing
- N.T.S.=Not To Scale
- M&P=Maps & Plats
- PM=Parcel Map
- RS=Record of Survey
- FB=Field Book
- N=North
- DI=Drain Inlet
- TOC=Top of Curb

Set=Conc. Nail with Brass Washer Stamped
 "S.J. Co.", unless otherwise noted
 Fd.=Found Conc. Nail with Brass Washer Stamped
 "S.J. Co.", unless otherwise noted
 Note: Found Monuments are not tagged
 unless otherwise noted.

"No Attempt Was Made to Verify the Monument(s)"