

# CORNER RECORD

Agency Index CR-17-233  
Document Number \_\_\_\_\_

City of Stockton County of San Joaquin, California  
Brief Legal Description Lincoln Village West, Unit No. 18, Book 19 of Maps & Plats, Page 78.

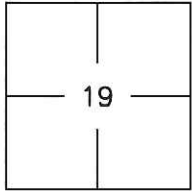

T 2 N., R. 6 E., M.D.B.M.

### CORNER TYPE

- |                   |                          |          |                                     |
|-------------------|--------------------------|----------|-------------------------------------|
| Government Corner | <input type="checkbox"/> | Control  | <input type="checkbox"/>            |
| Meander           | <input type="checkbox"/> | Property | <input checked="" type="checkbox"/> |
| Rancho            | <input type="checkbox"/> | Other    | <input checked="" type="checkbox"/> |

Date of Survey May 23, 2017

### COORDINATES (Optional)

N. \_\_\_\_\_ E. \_\_\_\_\_

Elevation \_\_\_\_\_

Units Metric  U.S. Survey Foot

Horizontal Datum NAD 83

Zone III Epoch Date 1991.35

Vertical Datum \_\_\_\_\_

Complies with Public Resources Code §§8801-8819

Complies with Public Resources Code §§8890-8902

PLS Act Ref:  8765(d)  8771  8773  Other: \_\_\_\_\_

Corner/ Monument:	<input type="checkbox"/> Left as found	<input type="checkbox"/> Established	<input type="checkbox"/> Rebuilt	<input type="checkbox"/> Pre-Construction
	<input type="checkbox"/> Found and tagged	<input type="checkbox"/> Reestablished	<input type="checkbox"/> Referenced	<input checked="" type="checkbox"/> Post-Construction

Narrative of corner identified and monument as found, set, reset, replaced, or removed:

See sheet #2 for description(s) :

Used conventional survey methods and CR 16-166 to reestablish the position of obliterated cut crosses, as shown on page 2. Set cut cross with brass tags stamped L.S. 7051 in concrete. Also, found 3/4" iron pins with brass tags stamped R.C.E. 8189 as shown on page 2.

### SURVEYOR'S STATEMENT

This Corner Record was prepared by me or under my direction in conformance with  
the Professional Land Surveyors' Act on May 24, 2017  
Signed [Signature] P.L.S. or R.C.E. No. 7051

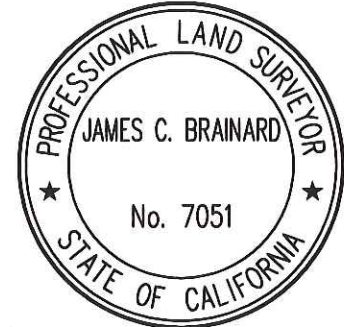

### COUNTY SURVEYOR'S STATEMENT

This Corner Record was received August 4, 2017  
and examined and filed August 18, 2017  
Signed [Signature] P.L.S. or R.C.E. No. 4842  
Title County Surveyor



County Surveyor's Comment

**STATEMENT OF PURPOSE:**

THE PURPOSE OF THIS SURVEY IS TO RECORD AND REESTABLISH THE LOCATION OF MONUMENTS ORIGINALLY SHOWN ON CR 16-166 DISTURBED AFTER THE CONSTRUCTION OF UNDERGROUND IMPROVEMENTS. THE PURPOSE OF THIS SURVEY IS NOT TO MAKE PROPERTY LINE DETERMINATIONS. LOT LINES SHOWN HEREON ARE FOR GENERAL LOCATION AND INFORMATIONAL PURPOSES ONLY.

**LEGEND:**

- ⊗ INDICATES SET CUT CROSS WITH BRASS TAG, TAGGED L.S. 7051
- INDICATES FOUND IRON PINS, 3/4" IN DIAMETER, WITH BRASS TAG ATTACHED STAMPED "R.C.E. 8189" IN CAST IRON MONUMENT WELL.

**DATUM STATEMENT:**

COORDINATES SHOWN HEREON ARE GRID AND ARE BASED ON CITY OF STOCKTON MONUMENTS 7N-3 AND 7N-5, CALIFORNIA COORDINATE SYSTEM (CCS83), ZONE III, 1983 NAD, (1991.35 EPOCH STOCKTON & SAN JOAQUIN COUNTY GPS ADJUSTMENT) AND SHOWN ON RECORD OF SURVEY BOOK 33 OF SURVEYS, PAGE 20. THE PROJECT SPECIFIC SCALE FACTOR IS 0.99993927.

**NOTE:**

FIELD EFFORT INCLUDED A SEARCH FOR EXISTING CUT CROSSES AT THEIR TYPICAL LOCATION, ONLY THOSE FOUND ARE SHOWN.

GRID COORDINATES (U.S. SURVEY FEET)		
POINT	NORTHING	EASTING
1035	2191203.48'	6313659.74'
1037	2191207.85'	6313881.77'
1044	2191173.92'	6313830.08'

