

CORNER RECORD

Agency Index: CR-17-155

Document Number: _____

City of STOCKTON County of SAN JOAQUIN, California

Brief Legal Description CITY OF STOCKTON BENCH MARK MONUMENT ON THE SOUTH SIDE OF HAMMER LANE AND WEST SIDE OF ALEXANDRIA PLACE. LOCATED IN THE EAST HALF OF SECTION 17, T.2N, R.6E, M.D.B.&M.

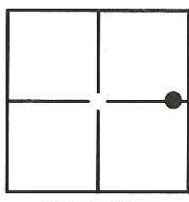

SEC. 17
T.2N, R.6E

CORNER TYPE

- Government Corner Control
- Meander Property
- Rancho Other

Date of Survey 3-24-2017

COORDINATES (Optional)

N. _____ E. _____
 Elevation: 8.06
 Units Metric U.S. Survey Foot
 Horizontal Datum: _____
 Zone: _____ Epoch Date: _____
 Vert. Datum: NVGD29

- Complies with Public Resources Code §§8801-8819
- Complies with Public Resources Code §§8890-8902

PLS Act Ref: 8765(d) 8771 8773 Other: _____

Corner/Monument: Left as found Established Rebuilt Pre-Construction
 Found and Tagged Reestablished Referenced Post-Construction

Narrative of corner identified and monument as found, set, reset, replaced, or removed:

See sheet #2 for description(s):

FOUND CITY OF STOCKTON BRASS DISK IN MONUMENT WELL STAMPED 4N-18, RCE 8189 ON THE SOUTH SIDE OF HAMMER LANE IN THE WEST CROSSWALK OF ALEXANDRIA PLACE. LOCATED IN THE EAST HALF OF SECTION 17, T.2N, R.6E, M.D.B.&M. FOUND MONUMENT AS SHOWN ON RECORD OF SURVEY FILED IN BOOK 35 OF SURVEYS AT PAGE 5, SAN JOAQUIN COUNTY RECORDS.

SURVEYOR'S STATEMENT

This Corner Record was prepared by me or under my direction in conformance with the Land Surveyors' Act on APRIL 18, 2017,

Signed [Signature] P.L.S. or R.C.E. Number 6953



COUNTY SURVEYOR'S STATEMENT

This Corner Record was received May 17, 2017

and examined and filed June 20, 2017

Signed [Signature] P.L.S. or R.C.E. No: 4842

Title County Surveyor

County Surveyor's Comment _____

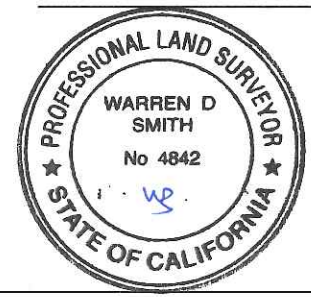

LEGEND:

- ⊗ SET MONUMENT AS NOTED.
- FOUND MONUMENT AS NOTED.
- R.S. DENOTES RECORD OF SURVEY
- (M) MEASURED DISTANCE. ALL DISTANCES ARE MEASURED UNLESS NOTED OTHERWISE.

HAMMER LANE

HAMMER LANE FRONTAGE

FOUND 2-1/2" BRASS DISK IN MONUMENT WELL STAMPED 4N-18. (R1) EL=8.06(NVGD 29)

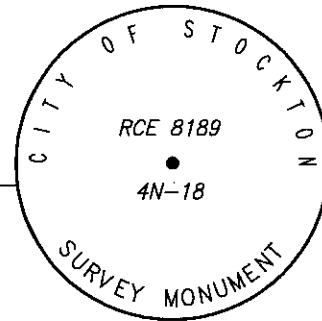

"A"

"B"

"C"

"D"

SET CONCRETE NAIL WITH BRASS TAG L.S. 6953 IN PAVEMENT. EL=7.85(NVGD 29)

SET CONCRETE NAIL WITH BRASS TAG L.S. 6953 IN PAVEMENT. EL=8.32(NVGD 29)

SET CONCRETE NAIL WITH BRASS TAG L.S. 6953 IN PAVEMENT. EL=7.62(NVGD 29)

ALEXANDRIA PLACE

REFERENCE:

(R1) R.S. 35-05, S.J.C.R.



NOT TO SCALE

⊗ AND DISTANCE TABLE		
BS-@-FS	⊗	FS DISTANCE
D-A-D	00°00'00"	301.47'(M)
D-A-B	00°00'00"	60.58'(M)
D-A-C	00°00'00"	142.33'(M)