

CORNER RECORD

Document Number CR-16-462
 County of San Joaquin, California

City of _____

Brief Legal Description A.P.N. 055-030-18 Lot 4, Tract 1762, M&P 26-43

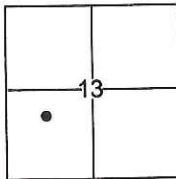

T.3N., R.4E., M.D.B.M.

CORNER TYPE

Government Corner Control
 Meander Property
 Rancho Other

Date of Survey August 24, 2016

COORDINATES(Optional)

N. _____
 E. _____
 Zone _____ NAD27 NAD83
 NAD83 Epoch _____
 Elev. _____
 Vert. Datum: NGVD29 NADV88
 Meas. Units: Metric Imperial

Corner - Left as found Found and tagged Established Reestablished Rebuilt

Identification and type of corner found: Evidence used to identify or procedure used to establish or reestablish the corner:
See sketch.

A description of the physical condition of the monument as found and as set or reset: See sketch.

SURVEYOR'S STATEMENT

This Corner Record was prepared by me or under my direction in conformance with
 the Land Surveyor's Act on November 16, 2016.

Signed Joe Murphy (P.L.S.) or R.C.E. No.: 7269

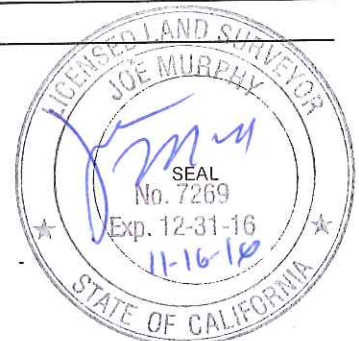

COUNTY SURVEYOR'S STATEMENT

This Corner Record was received November 21, 2016 and examined
 and filed December 9, 2016

Signed Warren D. Smith P.L.S. or R.C.E. No.: 4842

Title County Surveyor

County Surveyor's Comment _____

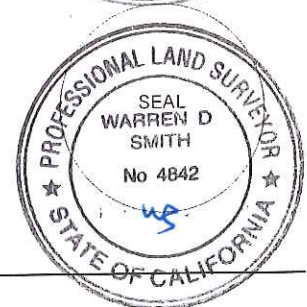

TOWER PARK WAY



FORMER
RIGHT-OF-WAY

S89°15'49"E
377.13'(R3)

85.19'
(R3)

271.32'

1088.03'(R3)

439.58'(R2)

480.89'(R2)

159°17'57"(R2)

FOUND IRON PIPE
WITH PLUG STAMPED
CAL DOT (R2)

FD. (2) CHISELED "L" IN
CONCRETE CURB USED TO
ESTABLISH CORNER BY
DISTANCE INTERSECTION (R1)

819.16'
S03°01'49"E
904.35'(R1)

N89°19'11"E
1710.26'

N16°39'11"E
44.96'(R1)

LOT 2
M&P 26-43

N25°12'15"W
288.13'(R1)

N89°55'00"W
487.28'(R1)

S79°16'00"E
531.03'(R1)

FD. 3/4" IRON PIN (R1)

LOT 4
M&P 26-43

N25°12'15"W
829.26'

FD. 3/4" IRON PIN,
N66°05'49"E 25.00'
FROM CORNER (R1)

N66°05'49"W
25.00'(R1)

N79°30'49"W
235.00'(R1)

N66°05'49"W
490.42'(R1)

S00°29'11"W
157.01'(R1)

FD. 3/4" IRON PIN
N00°29'11"E 7.00'
FROM CORNER (R1)

836.44'(R1)
S03°11'58"E 2350.13'(R1)
"BASIS OF BEARINGS"

POTATO SLOUGH

LEGEND

- SET 3/4" IRON ROD WITH CAP STAMPED L.S. 7269, UNLESS OTHERWISE NOTED
- FOUND MONUMENT AS NOTED
- FD. FOUND
- I.N. INSTRUMENT NUMBER
- R/W RIGHT-OF-WAY
- M&P MAPS AND PLATS
- R.S. RECORD OF SURVEY

REFERENCES:

- (R1) M&P 26-43
- (R2) R.S. 38-124
- (R3) STATE HIGHWAYS MAP BOOK 15, PAGE 68, S.J.C.R.
- (R4) R.S. 23-85

NOTE:

1. DISTANCES SHOWN ARE GROUND DISTANCES AND RECORD DISTANCES SHOWN ARE CONVERTED FROM GRID DISTANCES BASED ON THE RECORD MAPS SCALE FACTOR.

DILLON & MURPHY

CONSULTING CIVIL ENGINEERS

ENGINEERING • PLANNING • SURVEYING

847 N. CLUFF AVENUE, SUITE A2, LODI, CALIFORNIA 95240

(209) 334-6613

1646