

CORNER RECORD

Document Number CR-16-452
County of SAN JOAQUIN, California

City of RIPON

Brief Legal Description TRACT NO. 2664, VERMEULEN MEADOWS UNIT 3, RECORDED IN BOOK 32 OF MAPS & PLATS, PAGE 42, IN N.W. 1/4 OF SECTION 20, T. 2 S., R. 8 E., M.D.M.

CORNER TYPE:

COORDINATES (Optional)

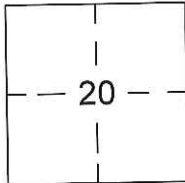

T. 2 S., R. 8 E.

Government Corner Control
Meander Property
Rancho Other
Date of Survey OCTOBER 19, 2016

N. _____
E. _____
Zone _____ NAD27 NAD83
NAD83 Epoch _____
Elev. _____
Vert. Datum: NGVD29 NAVD88
Meas. Units Metric Imperial

Corner- Left as found Found and tagged Established Reestablished Rebuilt

Identification and type of corner found: Evidence used to identify or procedure used to establish or reestablish the corner:

FOUND CENTERLINE MONUMENTS IN GROEN COURT PER VERMEULEN MEADOWS UNIT 3
RECORDED IN BOOK 32 OF MAPS & PLATS, PAGE 42, SAN JOAQUIN COUNTY RECORDS.
LOCATED MONUMENTS BY G.P.S. TIED TO CITY OF RIPON G.P.S. SURVEY CONTROL NETWORK
RECORDED IN BOOK 35 OF SURVEYS, PAGE 196, SAN JOAQUIN COUNTY RECORDS.
MONUMENTS ARE IN AREA OF FUTURE ROAD RESURFACING.

A description of the physical condition of the monument as found and as set or reset: _____
SEE PAGE 2 FOR MONUMENT DESCRIPTIONS.

SURVEYOR'S STATEMENT

This Corner Record was prepared by me or under my direction in conformance with the Land Surveyor's Act on November 8, 2016.

Signed Sean Harp P.L.S. No. 7823



COUNTY SURVEYOR'S STATEMENT

This Corner Record was received November 11, 2016 and examined and filed December 9, 2016.

Signed Warren D. Smith P.L.S. or R.C.E. No. 4842

Title County Surveyor



County Surveyor's Comment: _____

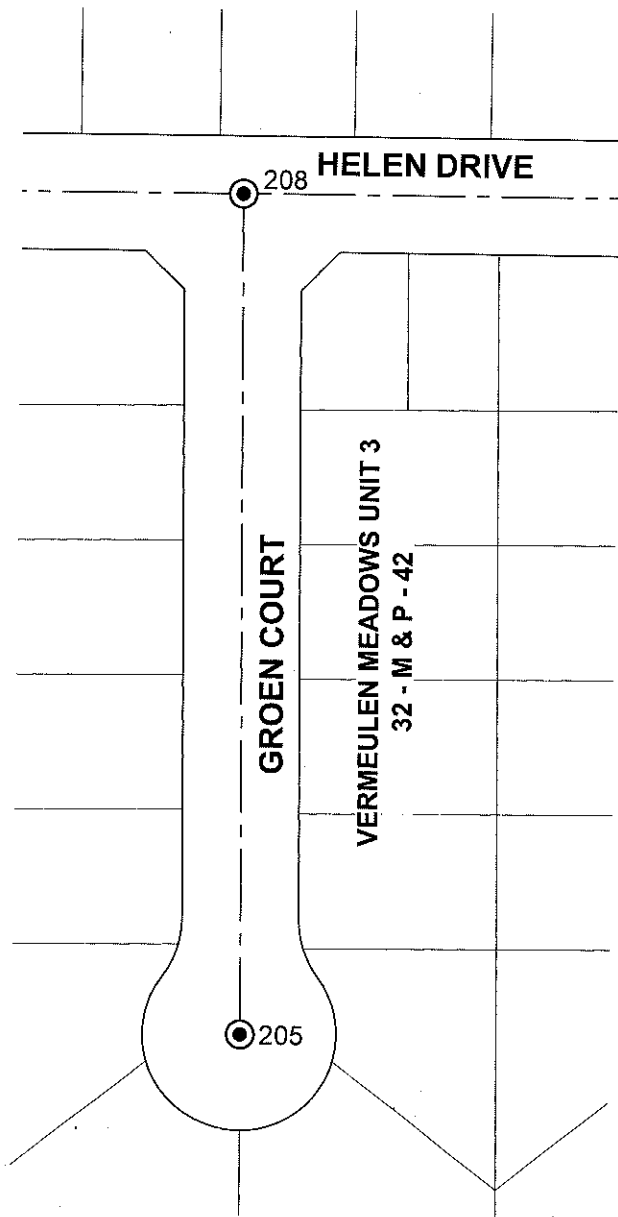

GRID COORDINATES		
MON. NO.	NORTHING	EASTING
205	2095694.34	6382829.65
208	2096130.88	6382825.41

NOTE:
 LOCATED MONUMENTS BY G.P.S. TIED TO CITY OF RIPON G.P.S.
 SURVEY CONTROL NETWORK RECORDED IN BOOK 35 OF
 SURVEYS, PAGE 196, SAN JOAQUIN COUNTY RECORDS.

LEGEND

- FOUND 3/4" IRON PIPE TAGGED L.S. 7047 IN MONUMENT WELL PER BOOK 32 OF MAPS & PLATS, PAGE 42



SCALE 1" = 100'