

# CORNER RECORD

Electronic File Number \_\_\_\_\_  
Document Number CR-16-444

City of MANTECA

County of SAN JOAQUIN, California

Brief Legal Description BEING THE RE-ESTABLISHMENT OF THE CENTER LINE / CENTER LINE INTERSECTION OF MAIN ST. AT LEGACY ST., LYING WITHIN THE SW. 1/4 OF SEC. 9, T. 2 S., R. 7 E., M.D.M. AS SHOWN IN BOOK 36 OF MAPS & PLATS AT PAGE 21, S.J.C.R.

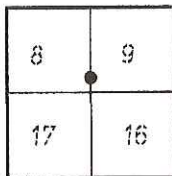

### CORNER TYPE

Government Corner  Control   
 Meander  Property   
 Rancho  Other

### COORDINATES(Optional)

N. \_\_\_\_\_  
 E. \_\_\_\_\_  
 Zone        NAD27  NAD83   
 NAD83 Epoch \_\_\_\_\_  
 Elev. \_\_\_\_\_  
 Vert. Datum: NGVD29  NADV88   
 Meas. Units: Metric  Imperial

Section 9  
T. 2 S., R. 7 E.

Date of Survey SEPTEMBER 16, 2016

Corner - Left as found  Found and Tagged  Established  Reestablished  Rebuilt

Identification and type of corner found: Evidence used to identify or procedure used to establish or reestablish the corner: MONUMENT REPLACED PURSUANT TO MAP OF MISSION GARDENS UNIT NO. 4, BK. 36 M.P., PG. 21, S.J.C.R.  
SAID MONUMENT WAS OMITTED INADVERTENTLY UPON COMPLETION OF CONSTRUCTION OF THE SUBDIVISION.  
SET MONUMENT UTILIZING EXISTING FOUND MONUMENTS ON SECTION LINE AS ILLUSTRATED ON SAID  
MISSION GARDENS UNIT NO. 4 SUBD. WITH TIES TO THE C/L-C/L MON. AT LEGACY ST. AND FOUNTAIN  
SQUARE AVE.

A description of the physical condition of the monument as found and as set or reset:  
SET 3/4" INSIDE DIAMETER IRON PIPE WITH PLASTIC PLUG STAMPED L.S. 7126 IN PAVEMENT  
APPROX. 0.2' DEEP AS INDICATED ON SHEET 2 OF 2

### SURVEYOR'S STATEMENT

This Corner Record was prepared by me or under my direction in conformance with the Land Surveyor's Act on SEPTEMBER 20, 2016.

Signed [Signature] P.L.S. No.: 7126



### COUNTY SURVEYOR'S STATEMENT

This Corner Record was received October 26, 2016 and examined and filed December 9, 2016.

Signed [Signature] P.L.S. or R.G.E. No.: 4842  
Title County Surveyor

County Surveyor's Comment \_\_\_\_\_  
\_\_\_\_\_  
\_\_\_\_\_  
\_\_\_\_\_

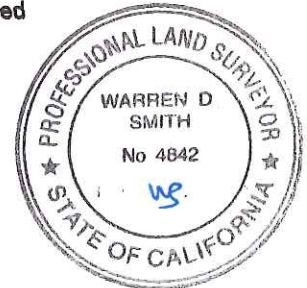

WOODWARD AVE.

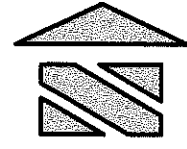

FOUND 1" SQUARE PIN  
NO TAG IN MON. WELL,  
SEE REF. (A,B) W. 1/4  
COR. SEC. 9

SECTION LINE & CENTER LINE  
MAIN STREET  
N00°01'35"E 2636.80'(M,A,B)

2504.80'(M,B)

52.00'

40

41

MISSION GARDENS, UNIT NO. 4  
M.P. 36 - 21

FOUNTAIN SQUARE AVE.

LEGACY STREET

S89°31'03"E 445.12'(M) 445.01'(B)

25.00'  
25.00'

MON. AS PER REF. (B) NOT  
FOUND, SET 3/4" GALV.  
IRON PIPE W/PLASTIC CAP  
STAMPED L.S. 7126  
APPROX. 0.2' DOWN, FOR  
C/L - C/L INTERSECTION

FOUND 3/4" GALV. IRON  
PIPE W/TAG L.S. 7126 IN  
MON. WELL, SEE REF. (B)

132.00'(M,B)

52.00'

WELLSITE

39

FOUND 1" SQUARE PIN  
NO TAG IN MON. WELL,  
SEE REF. (A,B,C) SW.  
COR. SEC. 9

SEC. 8

SEC. 9

SEC. 17

SEC. 16

EVANS ESTATES, UNIT NO. 2  
M.P. 42 - 52

11

SURVEY REFERENCES

- (A) BOOK 35 OF MAPS & PLATS AT PAGE 31, S.J.C.R.
- (B) BOOK 36 OF MAPS & PLATS AT PAGE 21, S.J.C.R.
- (C) BOOK 42 OF MAPS & PLATS AT PAGE 52, S.J.C.R.

ELECTRONIC FILE NO. \_\_\_\_\_

DOCUMENT NO. \_\_\_\_\_

10

SHEET 2 OF 2

DRAWN:	DLS
DATE:	9/20/16
SCALE:	1" = 40'
JOB #:	N/A
DWG:	CR MG4

**CORNER RECORD**

CENTER LINE INTERSECTION MAIN ST. & LEGACY ST.  
"MISSION GARDENS, UNIT NO. 4",  
BK. 36, MAPS & PLATS, PG. 21, S.J.C.R.  
CITY OF MANTECA  
COUNTY OF SAN JOAQUIN, STATE OF CALIFORNIA



**ASSOCIATED  
ENGINEERING  
GROUP**

4206 TECHNOLOGY DRIVE, SUITE 4, MODESTO, CA 95356  
PHONE: (209) 545-3390 FAX: (209) 545-3875 www.assoceng.com