

CORNER RECORD

Document Number CR-16-414

City of Stockton

County of San Joaquin, California

Brief Legal Description Venetian Gardens, Unit No. 1, Book of Maps & Plats Vol. 21, Page 24.

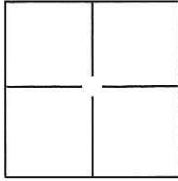

CORNER TYPE

Government Corner Control
 Meander Property
 Rancho Other

Date of Survey April 15, 2016

COORDINATES(Optional)

N. _____
 E. _____
 Zone III NAD27 NAD83
 NAD83 Epoch 1991.35
 Elev. _____
 Vert. Datum: NGVD29 NADV88
 Meas. Units: Metric Imperial

Corner - Left as found Found and tagged Established Reestablished Rebuilt

Identification and type of corner found: Evidence used to identify or procedure used to establish or reestablish the corner:
Used conventional survey methods and CR 16-274 to reestablish the position of obliterated cut crosses, as shown on page 2.

A description of the physical condition of the monument as found and as set or reset: _____
Found 3/4" iron pins, no tag, and a 3/4" iron pin with an illegible tag and set cut cross with brass tags stamped L.S. 7051 in concrete as shown on page 2.

SURVEYOR'S STATEMENT

This Corner Record was prepared by me or under my direction in conformance with

the Land Surveyor's Act on April 18, 2016

Signed [Signature] P.L.S. or R.C.E. No.: 7051



COUNTY SURVEYOR'S STATEMENT

This Corner Record was received October 3, 2016 and examined

and filed October 27, 2016

Signed [Signature] P.L.S. or R.C.E. No.: 4842

Title County Surveyor

County Surveyor's Comment _____

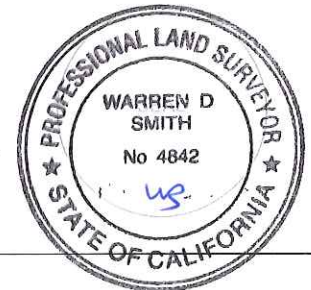

STATEMENT OF PURPOSE:

THE PURPOSE OF THIS SURVEY IS TO RECORD AND REESTABLISH THE LOCATION OF MONUMENTS ORIGINALLY SHOWN ON CR 16-274 DISTURBED AFTER THE CONSTRUCTION OF UNDERGROUND IMPROVEMENTS. THE PURPOSE OF THIS SURVEY IS NOT TO MAKE PROPERTY LINE DETERMINATIONS. LOT LINES SHOWN HEREON ARE FOR GENERAL LOCATION AND INFORMATIONAL PURPOSES ONLY.

DATUM STATEMENT:

COORDINATES SHOWN HEREON ARE GRID AND ARE BASED ON CITY OF STOCKTON MONUMENTS 235 AND 234, CALIFORNIA COORDINATE SYSTEM (CCS83), ZONE III, 1983 NAD, (1991.35 EPOCH STOCKTON & SAN JOAQUIN COUNTY GPS ADJUSTMENT) AND SHOWN ON RECORD OF SURVEY BOOK 33 OF SURVEYS, PAGE 20. THE PROJECT SPECIFIC COMBINED SCALE FACTOR IS 0.99993816.

LEGEND:

- ⊗ INDICATES SET CUT CROSS WITH BRASS TAG STAMPED L.S. 7051.
- ⊙ INDICATES FOUND 3/4" IRON PIN, NO TAG UNLESS STATED OTHERWISE, IN MONUMENT WELL
- INDICATES FOUND 3/4" IRON PIN, NO TAG UNLESS STATED OTHERWISE,

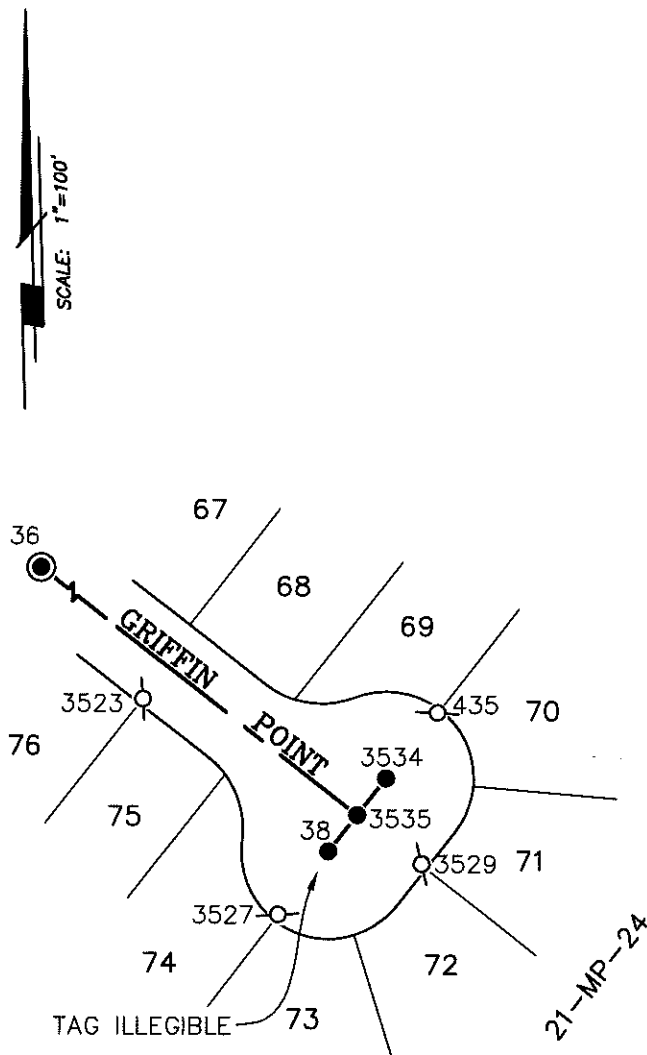

GRID COORDINATES (U.S. SURVEY FEET)		
POINT	NORTHING	EASTING
36	2184593.22'	6323089.39'
38	2184426.41'	6323263.26'
435	2184500.61'	6323321.40'
3523	2184508.18'	6323162.62'
3527	2184391.77'	6323236.07'
3529	2184418.92'	6323313.27'
3534	2184466.03'	6323294.11'
3535	2184446.09'	6323278.83'