

CORNER RECORD

Document Number CR-16-277

City of Stockton County of San Joaquin, California
 Brief Legal Description Venetian Gardens, Unit No. 1, Book of Maps & Plats Vol. 21, Page 24.

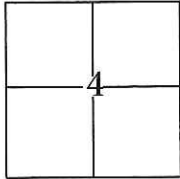

C.M. Weber Grant

CORNER TYPE

Government Corner Control
 Meander Property
 Rancho Other

Date of Survey November 18, 2015

COORDINATES(Optional)

N. _____
 E. _____
 Zone III NAD27 NAD83
 NAD83 Epoch 1991.35
 Elev. _____
 Vert. Datum: NGVD29 NADV88
 Meas. Units: Metric Imperial

Corner - Left as found Found and tagged Established Reestablished Rebuilt

Identification and type of corner found: Evidence used to identify or procedure used to establish or reestablish the corner:

Tied all found centerline monuments to the City of Stockton Horizontal Control. Used conventional survey methods to establish a position on found cut crosses. Evidence identification and field procedure in more detail are shown on page 2.

A description of the physical condition of the monument as found and as set or reset: _____

Found 3/4" iron pins, no tags, in monument wells and found cut crosses, no tags, in concrete as shown on page 2.

SURVEYOR'S STATEMENT

This Corner Record was prepared by me or under my direction in conformance with the Land Surveyor's Act on April 7, 2016.
 Signed [Signature] P.L.S. or R.C.E. No.: 7051

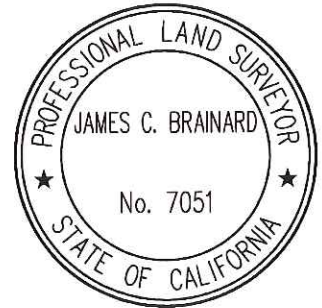

COUNTY SURVEYOR'S STATEMENT

This Corner Record was received June 3, 2016 and examined and filed June 23, 2016.
 Signed [Signature] P.L.S. or R.C.E. No.: 4842



Title County Surveyor

County Surveyor's Comment _____

STATEMENT OF PURPOSE:

THE PURPOSE OF THIS SURVEY IS TO IDENTIFY AND RECORD THE LOCATION OF EXISTING MONUMENTS PRIOR TO THE CONSTRUCTION OF PG&E FACILITIES AROUND THE MONUMENTS. THE PURPOSE OF THIS SURVEY IS NOT TO MAKE PROPERTY LINE DETERMINATIONS. LOT LINES SHOWN HEREON ARE FOR GENERAL LOCATION AND INFORMATIONAL PURPOSES ONLY.

DATUM STATEMENT:

COORDINATES SHOWN HEREON ARE GRID AND ARE BASED ON CITY OF STOCKTON MONUMENTS 235 AND 234, CALIFORNIA COORDINATE SYSTEM (CCS83), ZONE III, 1983 NAD, (1991.35 EPOCH STOCKTON & SAN JOAQUIN COUNTY GPS ADJUSTMENT) AND SHOWN ON RECORD OF SURVEY BOOK 33 OF SURVEYS, PAGE 20. THE PROJECT SPECIFIC COMBINED SCALE FACTOR IS 0.99993816.

LEGEND:

- ⊗ INDICATES FOUND CUT CROSS, NO TAG.
- INDICATES FOUND 3/4" IRON PIN, NO TAG IN MONUMENT WELL

NOTE:

FIELD EFFORT INCLUDED A SEARCH FOR EXISTING CUT CROSSES AT THEIR TYPICAL LOCATION, ONLY THOSE FOUND ARE SHOWN.

GRID COORDINATES (U.S. SURVEY FEET)		
POINT	NORTHING	EASTING
34	2183685.36'	6323117.88'
35	2184315.05'	6322600.65'
378	2183830.40'	6322967.74'
379	2183791.76'	6322999.48'
380	2183749.27'	6323034.44'
381	2183740.88'	6323041.28'
382	2183724.90'	6323203.90'
383	2183738.10'	6323220.02'
384	2183785.76'	6323277.98'

