

# CORNER RECORD

Document Number CR-16-258  
County of San Joaquin, California

City of Manteca

Brief Legal Description Franciscan Village, Unit No. 1, Volume 20 of Maps & Plats, Page 34 and Unit 2 of Verde Homes, Volume 17 of Maps & Plats, Page 60.

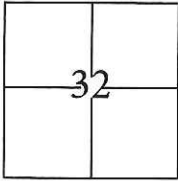

### CORNER TYPE

Government Corner  Control   
Meander  Property   
Rancho  Other

Date of Survey April 6, 2016

### COORDINATES(Optional)

N. \_\_\_\_\_  
E. \_\_\_\_\_  
Zone III NAD27  NAD83   
NAD83 Epoch \_\_\_\_\_  
Elev. \_\_\_\_\_  
Vert. Datum: NGVD29  NADV88   
Meas. Units: Metric  Imperial

T. 1 S., R. 7 E., M.D.B. & M.

Corner - Left as found  Found and tagged  Established  Reestablished  Rebuilt

Identification and type of corner found: Evidence used to identify or procedure used to establish or reestablish the corner:

Used conventional survey methods and CR 16-95 to reestablish the position of obliterated cut crosses, as shown on page 2.

A description of the physical condition of the monument as found and as set or reset: \_\_\_\_\_

Set cut cross with brass tags stamped L.S. 7051 in concrete. Also, found 3/4" iron pins tagged R.C.E. 14269 in monument well as shown on page 2.

### SURVEYOR'S STATEMENT

This Corner Record was prepared by me or under my direction in conformance with the Land Surveyor's Act on April 8, 2016.

Signed [Signature] P.L.S. or R.C.E. No.: 7051

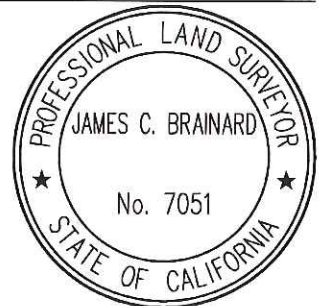

### COUNTY SURVEYOR'S STATEMENT

This Corner Record was received May 23, 2016 and examined and filed June 9, 2016.

Signed [Signature] P.L.S. or R.C.E. No.: 4842

Title County Surveyor

County Surveyor's Comment \_\_\_\_\_

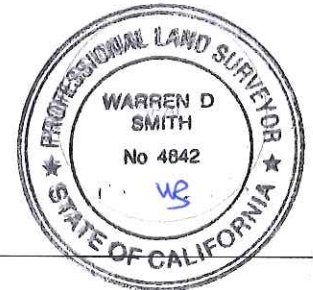

**STATEMENT OF PURPOSE:**

THE PURPOSE OF THIS SURVEY IS TO RECORD AND REESTABLISH THE LOCATION OF MONUMENTS ORIGINALLY SHOWN ON CR 16-95 DISTURBED AFTER THE CONSTRUCTION OF UNDERGROUND IMPROVEMENTS. THE PURPOSE OF THIS SURVEY IS NOT TO MAKE PROPERTY LINE DETERMINATIONS. LOT LINES SHOWN HEREON ARE FOR GENERAL LOCATION AND INFORMATIONAL PURPOSES ONLY.

**DATUM STATEMENT:**

COORDINATES SHOWN HEREON ARE GRID AND ARE BASED ON CITY OF MANTECA MONUMENTS 233 AND 234, CALIFORNIA COORDINATE SYSTEM (CCS83), ZONE III, 1983 NAD, (1991.35 EPOCH MANTECA & SAN JOAQUIN COUNTY GPS ADJUSTMENT) AND SHOWN ON RECORD OF SURVEY BOOK 33 OF SURVEYS, PAGE 133. THE PROJECT SPECIFIC COMBINED SCALE FACTOR IS 0.99992972.

**LEGEND:**

- ⊙ INDICATES SET CUT CROSS WITH BRASS TAG STAMPED L.S. 7051.
- INDICATES FOUND 3/4" IRON PINS TAGGED "R.C.E. 14269" IN MONUMENT WELL

GRID COORDINATES (U.S. SURVEY FEET)		
POINT	NORTHING	EASTING
543	2118232.28'	6352633.03'
544	2118227.66'	6353228.35'
611	2118250.95'	6353167.77'
613	2118251.04'	6353047.60'
615	2118251.96'	6352927.58'

