

# CORNER RECORD

Document Number CR-16-254

City of Manteca

County of San Joaquin, California

Brief Legal Description Hacienda Estates, Unit No. 1, Volume 19 of Maps & Plats, Page 77 and Parcel Map, Book 1 of Parcel Map, Book 1 of Parcel Maps, Page 80.

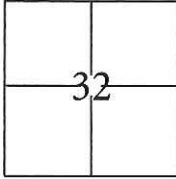

### CORNER TYPE

Government Corner  Control   
 Meander  Property   
 Rancho  Other

### COORDINATES(Optional)

N. \_\_\_\_\_  
 E. \_\_\_\_\_  
 Zone III NAD27  NAD83   
 NAD83 Epoch 1991.35  
 Elev. \_\_\_\_\_  
 Vert. Datum: NGVD29  NADV88   
 Meas. Units: Metric  Imperial

Date of Survey April 6, 2016

T. 1 N., R. 7 E., M.D.B.&M.

Corner - Left as found  Found and tagged  Established  Reestablished  Rebuilt

Identification and type of corner found: Evidence used to identify or procedure used to establish or reestablish the corner:  
 Used conventional survey methods and CR 16-110 to reestablish the position of obliterated cut crosses, as shown on page 2.

A description of the physical condition of the monument as found and as set or reset:  
 Set cut cross with brass tags stamped L.S. 7051 in concrete. Also, found 3/4" iron pipes tagged R.C.E. 818 in monument wells as shown on page 2.

### SURVEYOR'S STATEMENT

This Corner Record was prepared by me or under my direction in conformance with the Land Surveyors Act on April 7, 2016.

Signed [Signature] P.L.S. or R.C.E. No.: 7051



### COUNTY SURVEYOR'S STATEMENT

This Corner Record was received May 23, 2016 and examined and filed June 9, 2016.

Signed [Signature] P.L.S. or R.C.E. No.: 4842

Title County Surveyor

County Surveyor's Comment \_\_\_\_\_

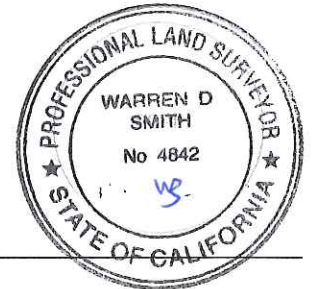

STATEMENT OF PURPOSE:

THE PURPOSE OF THIS SURVEY IS TO RECORD AND REESTABLISH THE LOCATION OF MONUMENTS ORIGINALLY SHOWN ON CR 16-110 DISTURBED AFTER THE CONSTRUCTION OF UNDERGROUND IMPROVEMENTS. THE PURPOSE OF THIS SURVEY IS NOT TO MAKE PROPERTY LINE DETERMINATIONS. LOT LINES SHOWN HEREON ARE FOR GENERAL LOCATION AND INFORMATIONAL PURPOSES ONLY.

DATUM STATEMENT:

COORDINATES SHOWN HEREON ARE GRID AND ARE BASED ON CITY OF MANTECA MONUMENTS 233 AND 234, CALIFORNIA COORDINATE SYSTEM (CCS83), ZONE III, 1983 NAD, (1991.35 EPOCH MANTECA & SAN JOAQUIN COUNTY GPS ADJUSTMENT) AND SHOWN ON RECORD OF SURVEY BOOK 33 OF SURVEYS, PAGE 133. THE PROJECT SPECIFIC COMBINED SCALE FACTOR IS 0.99995139.

LEGEND:

- ⊗ INDICATES SET CUT CROSS WITH BRASS TAG STAMPED L.S. 7051.
- INDICATES FOUND 3/4" IRON PINS WITH BRASS TAG STAMPED "R.C.E. 8189" IN MONUMENT WELL

GRID COORDINATES (U.S. SURVEY FEET)		
POINT	NORTHING	EASTING
105	2118670.48'	6351406.20'
106	2118744.30'	6351713.01'
107	2118738.63'	6351404.91'
108	2118918.67'	6351401.62'
124	2118786.80'	6351733.07'

