

CORNER RECORD

Document Number CR-16-250

City of Stockton

County of San Joaquin, California

Brief Legal Description Colonial West, Unit No. 4, Volume 19 of Maps & Plats, Page 71.

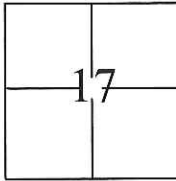

CORNER TYPE

Government Corner Control
 Meander Property
 Rancho Other

COORDINATES(Optional)

N. _____
 E. _____
 Zone III NAD27 NAD83
 NAD83 Epoch 1991.35
 Elev. _____
 Vert. Datum: NGVD29 NADV88
 Meas. Units: Metric Imperial

T. 2 N., R. 6 E., M.D.B.&M.

Date of Survey December 16, 2015

Corner - Left as found Found and tagged Established Reestablished Rebuilt

Identification and type of corner found: Evidence used to identify or procedure used to establish or reestablish the corner:

Used conventional survey methods and CR 16-058 to reestablish the position of the obliterated cut cross, as shown on page 2.

A description of the physical condition of the monument as found and as set or reset: _____

Set cut cross with brass tags stamped L.S. 7051 in concrete. Also, found 3/4" iron pipes tagged R.C.E. 15831 in monument wells as shown on page 2.

SURVEYOR'S STATEMENT

This Corner Record was prepared by me or under my direction in conformance with the Land Surveyor's Act on December 22, 2015.

Signed [Signature] P.L.S. or R.C.E. No.: 7051

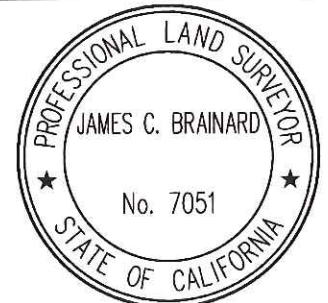

COUNTY SURVEYOR'S STATEMENT

This Corner Record was received May 16, 2016 and examined and filed June 9, 2016.

Signed [Signature] P.L.S. or R.C.E. No.: 4842

Title County Surveyor

County Surveyor's Comment _____



STATEMENT OF PURPOSE:

THE PURPOSE OF THIS SURVEY IS TO RECORD AND REESTABLISH THE LOCATION OF MONUMENTS ORIGINALLY SHOWN ON CR 16- DISTURBED AFTER THE CONSTRUCTION OF UNDERGROUND IMPROVEMENTS. THE PURPOSE OF THIS SURVEY IS NOT TO MAKE PROPERTY LINE DETERMINATIONS. LOT LINES SHOWN HEREON ARE FOR GENERAL LOCATION AND INFORMATIONAL PURPOSES ONLY.

LEGEND:

- ⊙ INDICATES SET BRASS TAG STAMPED L.S. 7051.
- INDICATES FOUND 3/4" IRON PIPES IN WELL TAGGED R.C.E. 15831

DATUM STATEMENT:

COORDINATES SHOWN HEREON ARE GRID AND ARE BASED ON CITY OF STOCKTON MONUMENTS 4N-6 AND 4N-10, CALIFORNIA COORDINATE SYSTEM (CCS83), ZONE III, 1983 NAD, (1991.35 EPOCH STOCKTON & SAN JOAQUIN COUNTY GPS ADJUSTMENT) AND SHOWN ON RECORD OF SURVEY BOOK 33 OF SURVEYS, PAGE 20. THE PROJECT SPECIFIC COMBINED SCALE FACTOR IS 0.99994060.

NOTE:

FIELD EFFORT INCLUDED A SEARCH FOR EXISTING CUT CROSSSES AT THEIR TYPICAL LOCATION, ONLY THOSE FOUND ARE SHOWN.

GRID COORDINATES (U.S. SURVEY FEET)		
POINT	NORTHING	EASTING
2016	2197212.35'	6319153.32'
2017	2197240.40'	6319302.73'
2018	2196949.00'	6319182.50'
2019	2196951.61'	6319304.46'
2020	2196923.15'	6319182.82'
2052	2197116.31'	6319168.39'
2175	2197242.63'	6319121.71'

