

# CORNER RECORD

Document Number CR-16-249

City of Stockton

County of San Joaquin, California

Brief Legal Description Colonial West, Unit No. 5, Volume 19 of Maps & Plats, Page 84.

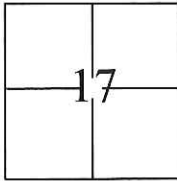

### CORNER TYPE

Government Corner  Control   
Meander  Property   
Rancho  Other

### COORDINATES(Optional)

N. \_\_\_\_\_  
E. \_\_\_\_\_  
Zone III NAD27  NAD83   
NAD83 Epoch 1991.35  
Elev. \_\_\_\_\_  
Vert. Datum: NGVD29  NADV88   
Meas. Units: Metric  Imperial

T. 2 N., R. 6 E., M.D.B.&M.

Date of Survey December 16, 2015

Corner - Left as found  Found and tagged  Established  Reestablished  Rebuilt

Identification and type of corner found: Evidence used to identify or procedure used to establish or reestablish the corner:

Used conventional survey methods and CR 16-057 to reestablish the position of the obliterated cut cross, as shown on page 2.

A description of the physical condition of the monument as found and as set or reset: \_\_\_\_\_

Set cut cross with brass tags stamped L.S. 7051 in concrete. Also, found 3/4" iron pipes tagged R.C.E. 15831 in monument wells as shown on page 2.

### SURVEYOR'S STATEMENT

This Corner Record was prepared by me or under my direction in conformance with the Land Surveyor's Act on December 22, 2015.

Signed [Signature] P.L.S. or R.C.E. No.: 7051

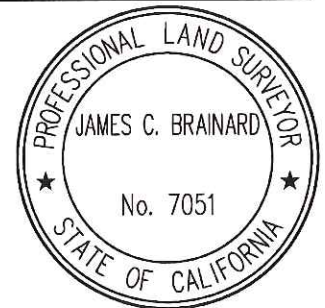

### COUNTY SURVEYOR'S STATEMENT

This Corner Record was received May 16, 2016 and examined and filed June 9, 2016.

Signed [Signature] P.L.S. or R.C.E. No.: 4842

Title County Surveyor

County Surveyor's Comment \_\_\_\_\_



STATEMENT OF PURPOSE:

THE PURPOSE OF THIS SURVEY IS TO RECORD AND REESTABLISH THE LOCATION OF MONUMENTS ORIGINALLY SHOWN ON CR 16-057 DISTURBED AFTER THE CONSTRUCTION OF UNDERGROUND IMPROVEMENTS. THE PURPOSE OF THIS SURVEY IS NOT TO MAKE PROPERTY LINE DETERMINATIONS. LOT LINES SHOWN HEREON ARE FOR GENERAL LOCATION AND INFORMATIONAL PURPOSES ONLY.

DATUM STATEMENT:

COORDINATES SHOWN HEREON ARE GRID AND ARE BASED ON CITY OF STOCKTON MONUMENTS 4N-6 AND 4N-10, CALIFORNIA COORDINATE SYSTEM (CCS83), ZONE III, 1983 NAD, (1991.35 EPOCH STOCKTON & SAN JOAQUIN COUNTY GPS ADJUSTMENT) AND SHOWN ON RECORD OF SURVEY BOOK 33 OF SURVEYS, PAGE 20. THE PROJECT SPECIFIC COMBINED SCALE FACTOR IS 0.99994060.

LEGEND:

- ⊕ INDICATES SET BRASS TAG STAMPED L.S. 7051.
- INDICATES FOUND 3/4" IRON PIPES IN WELL TAGGED R.C.E. 15831

GRID COORDINATES (U.S. SURVEY FEET)		
POINT	NORTHING	EASTING
2012	2197600.13'	6319006.98'
2013	2197475.34'	6319071.49'
2014	2197495.33'	6319116.43'
2015	2197530.54'	6319305.22'
2179	2197491.00'	6319319.37'

