

# CORNER RECORD

Document Number CR-16-243

City of Stockton

County of San Joaquin, California

Brief Legal Description Lincoln Village West, Unit No. 18, Book 19 of Maps & Plats, Page 78.

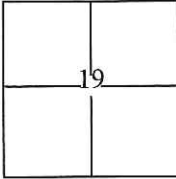

### CORNER TYPE

Government Corner  Control   
 Meander  Property   
 Rancho  Other

### COORDINATES(Optional)

N. \_\_\_\_\_  
 E. \_\_\_\_\_  
 Zone III NAD27  NAD83   
 NAD83 Epoch 1991.35  
 Elev. \_\_\_\_\_  
 Vert. Datum: NGVD29  NADV88   
 Meas. Units: Metric  Imperial

T. 2 N., R. 6 E., M.D.B.&M.

Date of Survey February 2, 2016

Corner - Left as found  Found and tagged  Established  Reestablished  Rebuilt

Identification and type of corner found: Evidence used to identify or procedure used to establish or reestablish the corner:

Used conventional survey methods and CR 16-167 to reestablish the position of obliterated cut crosses, as shown on page 2.

A description of the physical condition of the monument as found and as set or reset:

Set cut cross with brass tags stamped L.S. 7051 in concrete. Also, found 3/4" iron pins with brass tags stamped R.C.E. 8189 as shown on page 2.

### SURVEYOR'S STATEMENT

This Corner Record was prepared by me or under my direction in conformance with

the Land Surveyors Act on February 3, 2016.

Signed [Signature] P.L.S. or R.C.E. No.: 7051

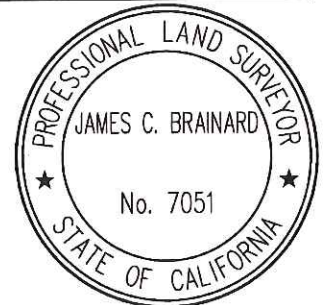

### COUNTY SURVEYOR'S STATEMENT

This Corner Record was received May 16, 2016 and examined

and filed June 9, 2016.

Signed [Signature] P.L.S. or R.C.E. No.: 4842

Title County Surveyor

County Surveyor's Comment \_\_\_\_\_



## STATEMENT OF PURPOSE:

THE PURPOSE OF THIS SURVEY IS TO RECORD AND REESTABLISH THE LOCATION OF MONUMENTS ORIGINALLY SHOWN ON CR 16-167 DISTURBED AFTER THE CONSTRUCTION OF UNDERGROUND IMPROVEMENTS. THE PURPOSE OF THIS SURVEY IS NOT TO MAKE PROPERTY LINE DETERMINATIONS. LOT LINES SHOWN HEREON ARE FOR GENERAL LOCATION AND INFORMATIONAL PURPOSES ONLY.

## DATUM STATEMENT:

COORDINATES SHOWN HEREON ARE GRID AND ARE BASED ON CITY OF STOCKTON MONUMENTS 7N-3 AND 7N-5, CALIFORNIA COORDINATE SYSTEM (CCS83), ZONE III, 1983 NAD, (1991.35 EPOCH STOCKTON & SAN JOAQUIN COUNTY GPS ADJUSTMENT) AND SHOWN ON RECORD OF SURVEY BOOK 33 OF SURVEYS, PAGE 20. THE PROJECT SPECIFIC SCALE FACTOR IS 0.99993927.

## LEGEND:

- ⊗ INDICATES SET CUT CROSS WITH BRASS TAG, TAGGED L.S. 7051
- INDICATES FOUND IRON PINS, 3/4" IN DIAMETER, WITH BRASS TAG ATTACHED STAMPED "R.C.E. 8189" IN CAST IRON MONUMENT WELL.
- ☒ INDICATES RECORD MONUMENT, NOT SEARCHED FOR.

GRID COORDINATES (U.S. SURVEY FEET)		
POINT	NORTHING	EASTING
1195	2190850.42'	6313382.14'
1198	2190529.37'	6313384.35'
1200	2190486.73'	6313377.51'
1202	2190502.14'	6313418.96'
1254	2190727.43'	6313414.36'

