

CORNER RECORD

Document Number CR-16-206

City of Stockton

County of San Joaquin, California

Brief Legal Description Burkett Villas, Book 10 of Maps and Plats, Page 04

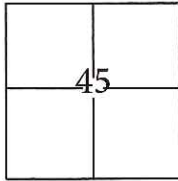

C.M. Weber Grant

CORNER TYPE

Government Corner Control
 Meander Property
 Rancho Other

Date of Survey March 2, 2016

COORDINATES(Optional)

N. _____
 E. _____
 Zone III NAD27 NAD83
 NAD83 Epoch 1991.35
 Elev. _____
 Vert. Datum: NGVD29 NADV88
 Meas. Units: Metric Imperial

Corner - Left as found Found and tagged Established Reestablished Rebuilt

Identification and type of corner found: Evidence used to identify or procedure used to establish or reestablish the corner:

Established coordinates on all found monuments by the use of G.P.S. and conventional survey methods. Tied all found monuments to the City of Stockton Horizontal Control System. Evidence identification and field procedure in more detail are shown on page 2.

A description of the physical condition of the monument as found and as set or reset: _____

Found cut crosses in concrete as shown on page 2.

SURVEYOR'S STATEMENT

This Corner Record was prepared by me or under my direction in conformance with the Land Surveyor's Act on March 4, 2016.

Signed [Signature] P.L.S. or R.C.E. No.: 7051

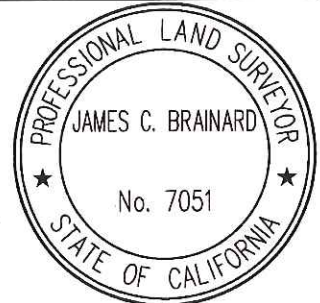

COUNTY SURVEYOR'S STATEMENT

This Corner Record was received April 10, 2016 and examined and filed May 10, 2016.

Signed [Signature] P.L.S. or R.C.E. No.: 4842

Title County Surveyor

County Surveyor's Comment _____



STATEMENT OF PURPOSE:

THE PURPOSE OF THIS SURVEY IS TO IDENTIFY AND RECORD THE LOCATION OF EXISTING MONUMENTS PRIOR TO PG&E IMPROVEMENTS. NO CLAIM IS MADE AS TO THE RELATIONSHIP OF THE MONUMENTS SHOWN HEREON TO THE EXISTING PROPERTY LINES. LOT LINES SHOWN ARE FOR GENERAL LOCATION AND INFORMATIONAL PURPOSES ONLY.

GRID COORDINATES (U.S. SURVEY FEET)		
POINT	NORTHING	EASTING
171	2170907.92'	6346365.38'
174	2167850.11'	6345075.86'
509	2169304.40'	6345816.92'
510	2169340.94'	6345805.59'

DATUM STATEMENT:

COORDINATES SHOWN HEREON ARE GRID AND ARE BASED ON CITY OF STOCKTON MONUMENTS 5S-8 AND 5S-11 CALIFORNIA COORDINATE SYSTEM (CCS83), ZONE III, 1983 NAD, (1991.35 EPOCH STOCKTON & SAN JOAQUIN COUNTY GPS ADJUSTMENT) AND SHOWN ON RECORD OF SURVEY BOOK 35 OF SURVEYS, PAGE 05. THE PROJECT SPECIFIC SCALE FACTOR IS 0.99993523.

LEGEND:

- ⊗ INDICATES FOUND CUT CROSS, NO TAG.
- INDICATES FOUND MONUMENT AS NOTED
- CHW INDICATES CHAS H. WIDDOWS
- FB INDICATES FIELD BOOK, BOOK-PAGE

