

CORNER RECORD

Document Number CR-16-202

City of Lathrop

County of San Joaquin, California

Brief Legal Description Lathrop Village Homes, Unit No. 5, Book of Maps & Plats Vol. 20, Page 54 and Lathrop Village Homes, Unit No. 6, Book of Maps & Plats Vol. 20, Page 66.

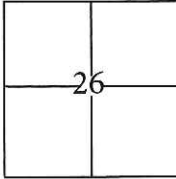

T. 1 S., R. 6 E. M.D.B. & M.

CORNER TYPE

Government Corner Control
 Meander Property
 Rancho Other

Date of Survey March 7, 2016

COORDINATES(Optional)

N. _____
 E. _____
 Zone III NAD27 NAD83
 NAD83 Epoch 1991.35
 Elev. _____
 Vert. Datum: NGVD29 NADV88
 Meas. Units: Metric Imperial

Corner - Left as found Found and tagged Established Reestablished Rebuilt

Identification and type of corner found: Evidence used to identify or procedure used to establish or reestablish the corner:
Tied all found centerline monuments to the Primary Survey Control for Reclamation 17. Used conventional survey methods to establish a position on found cut crosses. Evidence identification and field procedure in more detail are shown on page 2.

A description of the physical condition of the monument as found and as set or reset: _____
Found 3/4" iron pins, no tag, in monument wells and found cut crosses in concrete as shown on page 2.

SURVEYOR'S STATEMENT

This Corner Record was prepared by me or under my direction in conformance with the Land Surveyor's Act on March 14, 2016.
 Signed [Signature] P.L.S. or R.C.E. No.: 7051

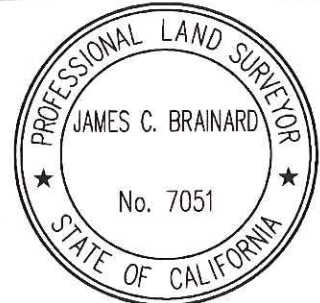

COUNTY SURVEYOR'S STATEMENT

This Corner Record was received April 18, 2016 and examined and filed May 10, 2016.
 Signed [Signature] P.L.S. or R.C.E. No.: 4842



Title County Surveyor

County Surveyor's Comment _____

STATEMENT OF PURPOSE:

THE PURPOSE OF THIS SURVEY IS TO IDENTIFY AND RECORD THE LOCATION OF EXISTING MONUMENTS PRIOR TO PG&E IMPROVEMENTS. NO CLAIM IS MADE AS TO THE RELATIONSHIP OF THE MONUMENTS SHOWN HEREON TO THE EXISTING PROPERTY LINES. ORIGINAL LOT LINES SHOWN ARE FOR GENERAL LOCATION AND INFORMATIONAL PURPOSES ONLY.

DATUM STATEMENT:

COORDINATES SHOWN HEREON ARE GRID AND ARE BASED ON THE PRIMARY SURVEY CONTROL NETWORK FOR RECLAMATION 17 POINT ID NO. 6, 7 AND 604, CALIFORNIA COORDINATE SYSTEM (CCS83), ZONE III, 1983 NAD, (1991.35 GPS ADJUSTMENT) AS SHOWN ON RECORD OF SURVEY BOOK 38 OF SURVEYS, PAGE 119. DISTANCES SHOWN ARE GRID. THE PROJECT SPECIFIC SCALE FACTOR IS 0.99992976.

LEGEND:

- ⊗ INDICATES FOUND CUT CROSS, NO TAG.
- INDICATES FOUND 3/4" IRON PIN, NO TAG, IN MONUMENT WELL, UNLESS OTHERWISE NOTED



GRID COORDINATES (U.S. SURVEY FEET)		
POINT	NORTHING	EASTING
103	2119477.79'	6334309.91'
104	2119477.00'	6334560.16'
1038	2119457.12'	6334555.95'
1039	2119457.29'	6334490.92'
1040	2119457.44'	6334425.88'

